



ASH GROVE, N13  
OFFERS IN EXCESS OF £550,000 FREEHOLD

**A SPACIOUS FAMILY HOME OFFERED FOR SALE  
CHAIN-FREE, IN EASY REACH OF SCHOOLS AND  
OPFN-SPACFS.**

Palmers Green | 020 8920 9900 | palmersgreen@winkworth.co.uk

**Winkworth**

for every step...

[winkworth.co.uk](http://winkworth.co.uk)



## DESCRIPTION:

**\*\*\*Chain-free\*\*\*** A delightful three-bedroom family home situated on a popular residential road, within easy reach of Winchmore Secondary School, Firs Farm, and Highfield Primary Schools, as well as several open spaces including Firs Farm Wetlands and Clowes Football/Cricket Ground.

Offered for sale chain-free, the property boasts 1025 Sq. ft. of living accommodation and offers the opportunity to create a lovely family home tailored to one's own requirements.

The ground floor features a generously sized living room/dining room with a bay at one end providing access to the rear garden. You will also find a galley kitchen and a convenient WC. The first floor offers three well-proportioned bedrooms and a family bathroom.

Outside, the property enjoys a rear garden extending just under 47 feet in length, as well as a garage with vehicular access and a front garden.



# Ash Grove, N13

Approx. Gross Internal Floor Area 1186 sq. ft / 110.19 sq. m (Including Garage)

Approx. Gross Internal Floor Area 1025 sq. ft / 95.28 sq. m (Excluding Garage)

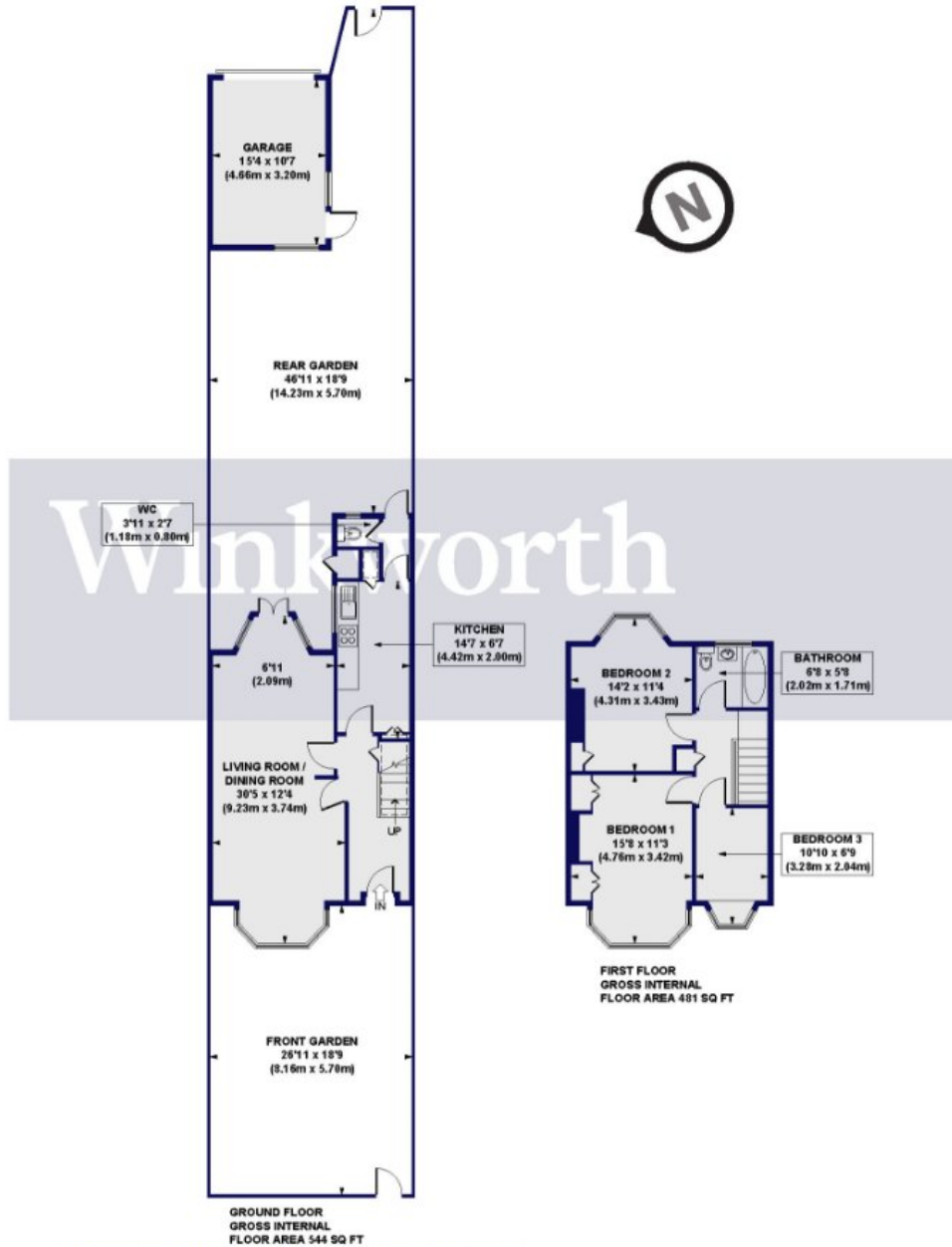

All measurements of walls, doors, windows, fittings and appliances, including their size and location, are shown as standard sizes and do not constitute any warranty or representation by the seller, their agent or CP Creative. Any intending purchaser must satisfy himself by inspection or otherwise as to the correctness of the information contained in these plans.

This floorplan is for illustration purposes only and is not to scale. The position and size of doors, windows, appliances and other features are approximate.

**Tenure:** Freehold

**Council Tax Band:** E

Where no figures are shown, we have been unable to ascertain the information. All figures that are shown were correct at the time of printing.

Energy Efficiency Rating	
	Potential
Very energy efficient - lower running costs	
(92) <b>A</b>	
(81-91) <b>B</b>	86
(69-80) <b>C</b>	
(55-68) <b>D</b>	63
(39-54) <b>E</b>	
(21-58) <b>F</b>	
(1-20) <b>G</b>	
Not energy efficient - higher running costs	
England, Scotland & Wales	EU Directive 2002/91/EC

Palmers Green | 020 8920 9900 | palmersgreen@winkworth.co.uk



for every step...

winkworth.co.uk

Winkworth wishes to inform prospective buyers and tenants that these particulars are a guide and act as information only. All our details are given in good faith and believed to be correct at the time of printing but they don't form part of an offer or contract. No Winkworth employee has authority to make or give any representation or warranty in relation to this property. All fixtures and fittings, whether fitted or not are deemed removable by the vendor unless stated otherwise and room sizes are measured between internal wall surfaces, including furnishings.