



NEWINGTON GREEN MANSIONS, N16
£535,000 LEASEHOLD

TWO-BEDROOM FLAT SET WITHIN CHARMING VICTORIAN MANSION BUILDING.

Stoke Newington | 020 3869 9000 | stokenewington@winkworth.co.uk





DESCRIPTION:

A charming two bedroom second floor flat is set within a striking Victorian Mansion block in the heart of Newington Green, N16 and boasts plenty of original character and charm. Standing at 606sq ft, the open-plan living area seamlessly flows into a modern and well-equipped kitchen, while dual aspect sash windows flood the property with natural lighting. Two generous sized double bedrooms and a family bathroom follow through the hallway alongside fitted storage cupboards. To the rear, the building benefits from a tranquil communal garden. Access is provided via a secure entry-fob system.

Newington Green is a vibrant and sought-after neighbourhood well known for its village atmosphere, offering an abundance of eclectic shops, pubs and eateries. The popular Stoke Newington Church Street is also a short distance away, alongside the beautiful green spaces of Clissold Park, known for its wild deer and sports facilities.

Plenty of transport links serve the area, with the closest stations being Canonbury Overground, providing direct access to Liverpool Street and Stratford. Several bus routes provide access to Islington, Kings Cross and Central London.

Winkworth



Winkworth

Newington Green Mansions, Green Lanes, N16
 Approx. Gross Internal Floor Area 604 sq. ft / 56.12 sq. m

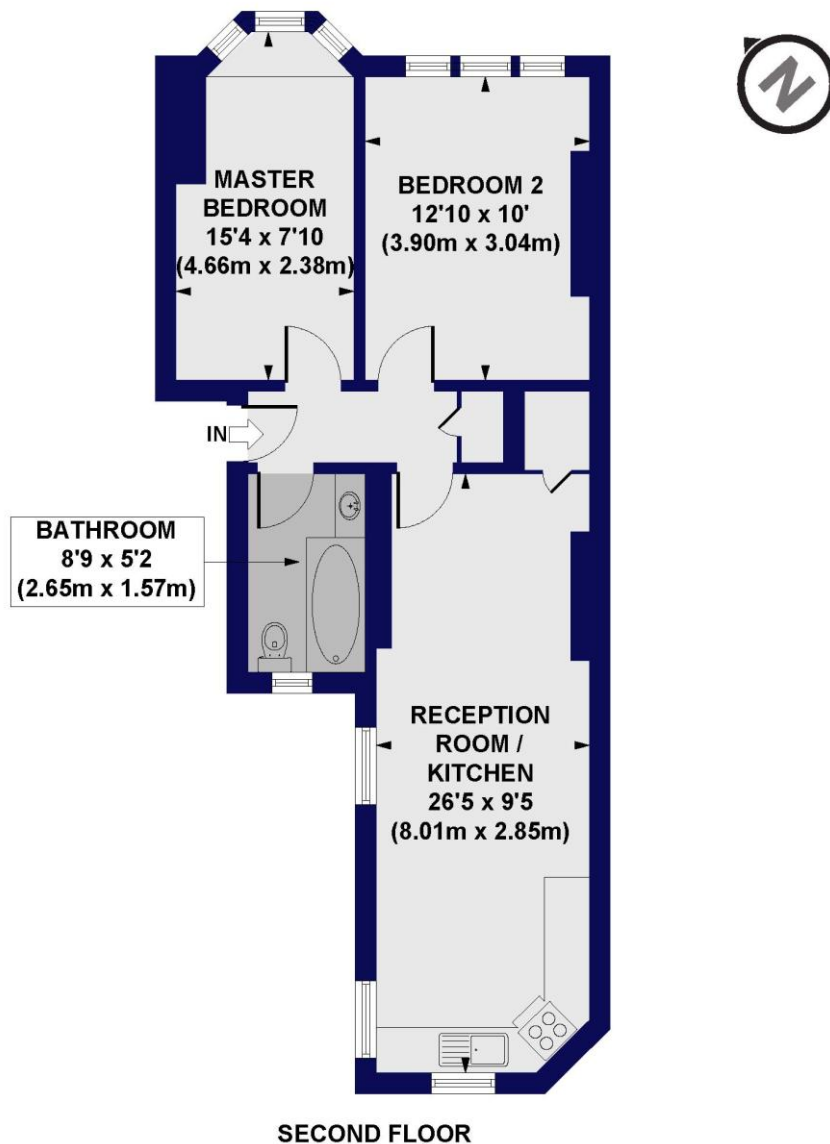

All measurements of walls, doors, windows, fittings and appliances, including their size and location, are shown as standard sizes and do not constitute any warranty or representation by the seller, their agent or CP Creative. Any intending purchaser must satisfy himself by inspection or otherwise as to the correctness of the information contained in these plans. This plan is for illustrative purposes only and should be used as such by any prospective purchasers.



This floorplan is for illustration purposes only and is not to scale. The position and size of doors, windows, appliances and other features are approximate.

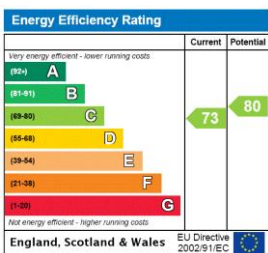

Stoke Newington | 020 3869 9000 | stokenewington@winkworth.co.uk



winkworth.co.uk

See things differently

Winkworth wishes to inform prospective buyers and tenants that these particulars are a guide and act as information only. All our details are given in good faith and believed to be correct at the time of printing but they don't form part of an offer or contract. No Winkworth employee has authority to make or give any representation or warranty in relation to this property. All fixtures and fittings, whether fitted or not are deemed removable by the vendor unless stated otherwise and room sizes are measured between internal wall surfaces, including furnishings.