



ARMOURY ROAD, SE8
£260,000 LEASEHOLD

A WELL-PRESENTED ONE BEDROOM GROUND FLOOR APARTMENT, THAT MEASURES CIRCA 416 SQ FT AND FEATURES RESIDENTS OFF STREET PARKING AND LOCATED JUST MOMENTS FROM DLR! NO CHAIN!

Greenwich, 02030533033, greenwich@winkworth.co.uk

Winkworth

for every step...

winkworth.co.uk

DESCRIPTION:

A well-presented one bedroom ground floor apartment, that measures circa 416 sq ft and features residents off street parking and located just moments from DLR! No chain!

In good condition throughout, the property comprises a bright 14ft reception room, that opens onto a well fitted modern kitchen. There is a family bathroom and a double bedroom with fitted wardrobes. Benefits include electric heating, well-kept communal grounds and off street parking!

Armoury Road is a popular development that is quietly located on the edge of Lewisham and Deptford, and is just moments away from Elverson Road DLR. Lewisham town centre is close by, offering a wide variety of shops and restaurants, along with mainline rail.

Ground Floor

Approx. 38.7 sq. metres (416.4 sq. feet)

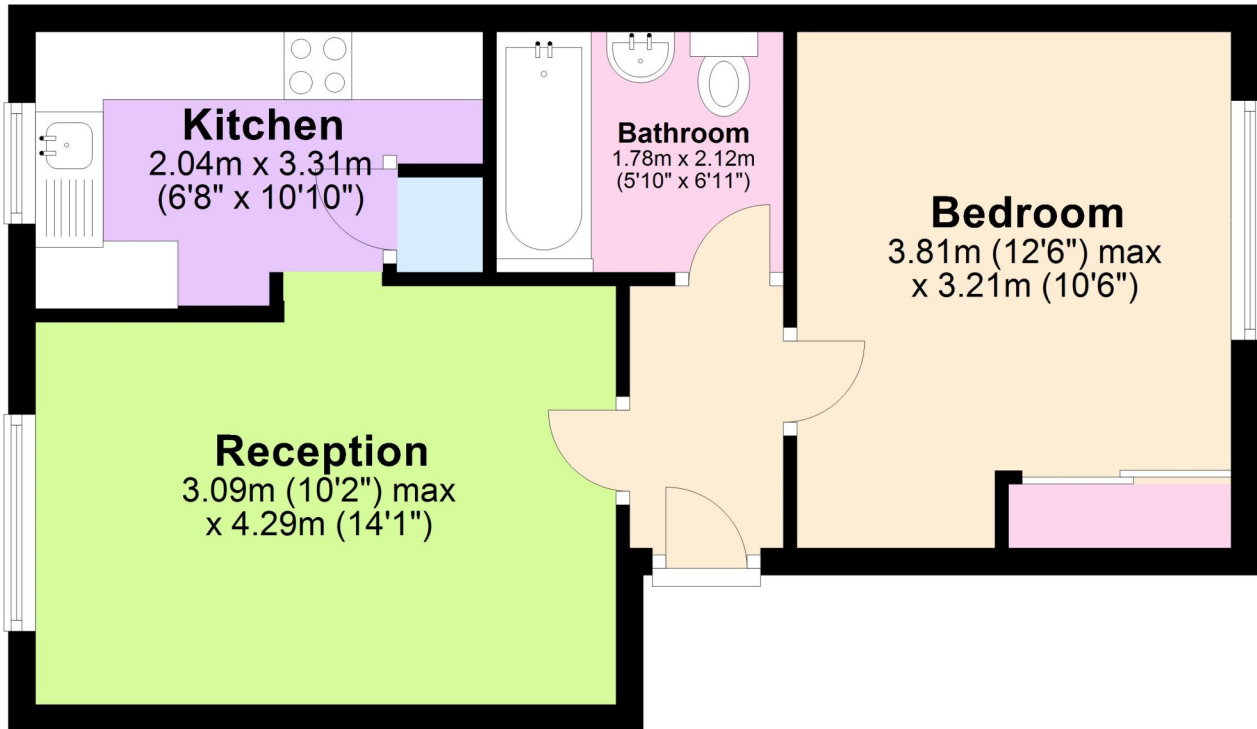

Total area: approx. 38.7 sq. metres (416.4 sq. feet)

This floorplan is for illustration purposes only and is not to scale. The position and size of doors, windows, appliances and other features are approximate.

Energy Efficiency Rating	
Current	Potential
Very energy efficient - lower running costs	
A (92)	
B (81-91)	81
C (69-80)	
D (55-68)	70
E (39-54)	
F (21-38)	
G (1-20)	
Not energy efficient - higher running costs	
England, Scotland & Wales EU Directive 2002/91/EC	

Tenure: Leasehold

Term: 183 years

Service Charge: £1800 per annum

Ground Rent: £ tbc

Council Tax Band: B

Where no figures are shown, we have been unable to ascertain the information. All figures that are shown were correct at the time of printing.

Greenwich | 02030533033 | greenwich@winkworth.co.uk

Winkworth

for every step...

winkworth.co.uk

Winkworth wishes to inform prospective buyers and tenants that these particulars are a guide and act as information only. All our details are given in good faith and believed to be correct at the time of printing but they don't form part of an offer or contract. No Winkworth employee has authority to make or give any representation or warranty in relation to this property. All fixtures and fittings, whether fitted or not are deemed removable by the vendor unless stated otherwise and room sizes are measured between internal wall surfaces, including furnishings.