



ST. QUINTIN AVENUE, LONDON, W10  
£2383.33 PER MONTH

## SPACIOUS TWO BEDROOM APARTMENT WITH PRIVATE BALCONY

North Kensington | 020 7792 5000 | northkensington@winkworth.co.uk

**Winkworth**

for every step...

*winkworth.co.uk*



## DESCRIPTION:

A well-presented two-bedroom apartment located on a tree lined street in North Kensington.

The property comprises of a separate kitchen, spacious reception with access to a small balcony, two double bedrooms and a modern bathroom.

Ladbroke Grove station (Hammersmith and City line) is moments away as well as the shops and cafés of Portobello Road and Notting Hill.



**Winkworth**

for every step...





**Winkworth**

for every step...

## ST QUINTIN AVENUE, W10

Approx. Gross Internal Floor Area  
**717 Sq. ft/66.61 Sq. m**

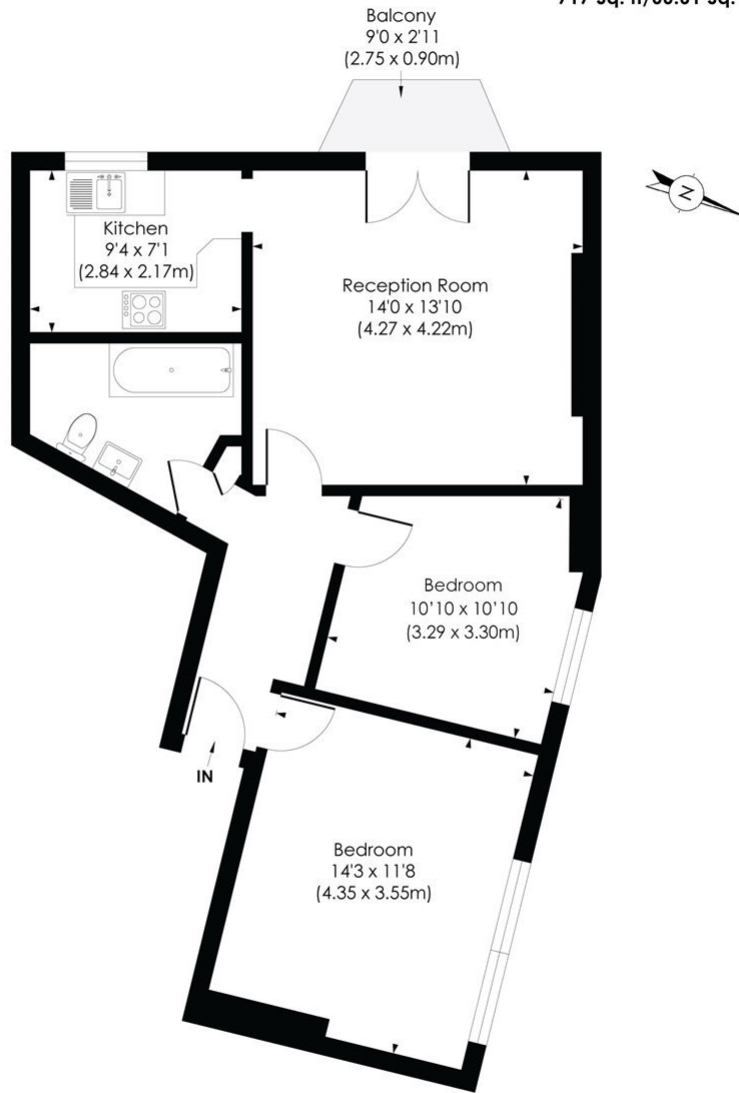

### SECOND FLOOR

© Pixangle Property Marketing Ltd. info@pixangle.com Tel: 0208 870 2118

**pixangle**  
PROPERTY MARKETING

This floor plan has been prepared for the purpose of illustration only in accordance with the latest RICS code of measuring practice and is not to scale. All measurements and areas are approximate and whilst every effort has been made to ensure the accuracy of the plan contained here, no responsibility is taken for any error, omission or misstatement.

This floorplan is for illustration purposes only and is not to scale. The position and size of doors, windows, appliances and other features are approximate.

North Kensington | 020 7792 5000 | northkensington@winkworth.co.uk

**Winkworth**

for every step...

*winkworth.co.uk*

Winkworth wishes to inform prospective buyers and tenants that these particulars are a guide and act as information only. All our details are given in good faith and believed to be correct at the time of printing but they don't form part of an offer or contract. No Winkworth employee has authority to make or give any representation or warranty in relation to this property. All fixtures and fittings, whether fitted or not are deemed removable by the vendor unless stated otherwise and room sizes are measured between internal wall surfaces, including furnishings.