



SUNDERLAND ROAD, LONDON, SE23  
**£350,000 LEASEHOLD**

This top-floor flat features a genuine double bedroom with a built-in wardrobe, a spacious living area with room for dining, and a fully fitted kitchen with modern appliances. The modern bathroom, off-street parking, and ample storage throughout add to the appeal. Located in a great area, it is also chain-free.

Forest Hill | [foresthill@winkworth.co.uk](mailto:foresthill@winkworth.co.uk)

[winkworth.co.uk](http://winkworth.co.uk)

**Winkworth**

for every step...



**DESCRIPTION:**

Full of character and modern comfort, this delightful one-bedroom flat on Sunderland Road is the perfect blend of classic charm and contemporary living. Recently fitted with a stylish new kitchen and a sleek, modern bathroom, the home offers a fresh and inviting space to call your own.





**Winkworth**

## SUNDERLAND ROAD, SE23

Approx. Gross Internal Floor Area  
**489 Sq. ft/45.40 Sq. m** (Incl. Reduced Height)  
**411 Sq. ft/38.20 Sq. m** (Excl. Reduced Height)

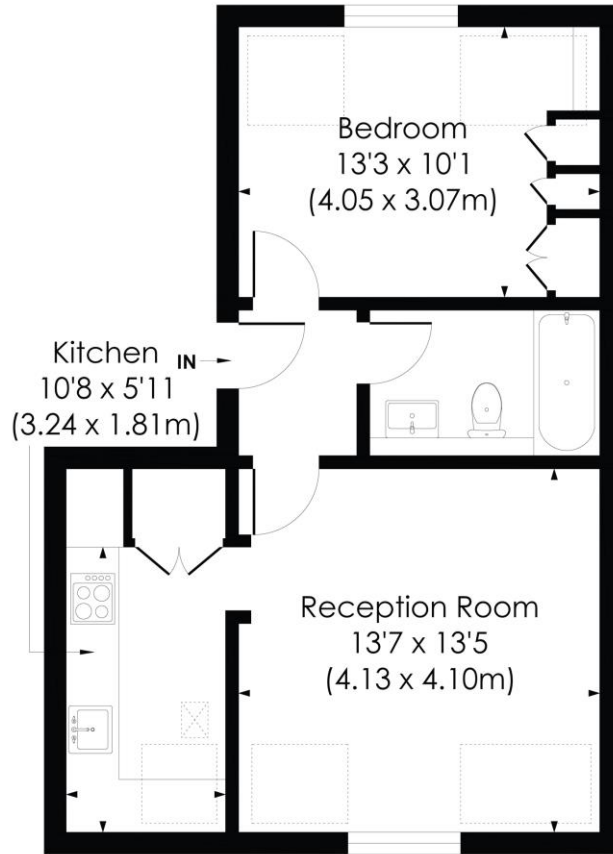

SECOND FLOOR

© Pixangle Property Marketing Ltd. info@pixangle.com Tel: 0208 870 2118



This floor plan has been prepared for the purpose of illustration only in accordance with the latest RICS code of measuring practice and is not to scale. All measurements and areas are approximate and whilst every effort has been made to ensure the accuracy of the plan contained here, no responsibility is taken for any error, omission or misstatement.

This floorplan is for illustration purposes only and is not to scale. The position and size of doors, windows, appliances and other features are approximate.

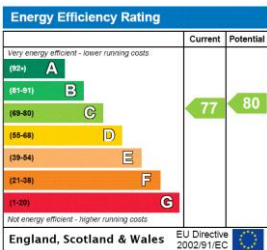

**Council Tax- B**

**Local Authority - Lewisham**

**Service Charge-TBC. Ground Rent – TBC.**

**Tenure- Leasehold**

**Lease Length -TBC**

**Services: Mains Electric, Gas, Drainage, Standard water.**

**Broadband: Standard & Ultrafast Broadband Available. Checked on Openreach Feb 2025.**

**Mobile Signal: You are likely to have voice coverage with most mobile providers & data coverage with some mobile providers**

**Heating: Gas Central Heating**

**Winkworth**

Forest Hill | foresthill@winkworth.co.uk

winkworth.co.uk

for every step...

Winkworth wishes to inform prospective buyers and tenants that these particulars are a guide and act as information only. All our details are given in good faith and believed to be correct at the time of printing but they don't form part of an offer or contract. No Winkworth employee has authority to make or give any representation or warranty in relation to this property. All fixtures and fittings, whether fitted or not are deemed removable by the vendor unless stated otherwise and room sizes are measured between internal wall surfaces, including furnishings.