



Taymount Rise, SE23

OIEO £625,000

Spacious apartment located in this period purpose built mansion block in the heart of Forest Hill, walkable to the station and a large array of amenities.



DESCRIPTION

The property is set on the ground floor of this purpose built period mansion block, and at over 1000 sq ft is considerably larger than the average two bedroom property.

Consisting of two double bedrooms, a good sized reception, a generous centralised hall way and spacious kitchen/dining area to the rear. The property benefits from sash windows, good ceiling heights and a private south east facing garden.

Recently refurbished throughout, the property requires no work and would make an ideal investment for any first time buyer.

Taymount Rise is within easy reach of all that Forest Hill has to offer, including shops, cafe's, restaurants, fantastic gastro pubs and the beautiful landscaped gardens with skyline views of the Horniman Museum close by.

Ideal location for families or those that appreciate having a plentiful supply of green spaces on their door steps.

Forest Hill station is under 10 minutes with fast frequent links into central, west and east London.

Sold with a long lease. Viewings highly recommended.

AT A GLANCE

- Purpose built period mansion block
- 2 bedrooms
- Over 1000 sq ft
- Large open plan kitchen/dining room
- Period features
- Private garden
- Long lease 100 + years
- Heart of Forest Hill

Energy Efficiency Rating		
	Current	Potential
<i>Very energy efficient - lower running costs</i>		
(92+) A		
(81-91) B		
(69-80) C		79
(55-68) D	68	
(39-54) E		
(21-38) F		
(1-20) G		
<i>Not energy efficient - higher running costs</i>		
England, Scotland & Wales	EU Directive 2002/91/EC	



LOCATION

Located a 10-minute walk to Forest Hill with all its amenities, and similar distance to Forest Hill station offering fast connections into central, west and east London.

Large selection of green spaces close by including Horniman's Triangle, the beautiful, landscaped gardens of the Horniman's Museum, Mayow Park, Peckham Rye Park and Dulwich Park.

Plentiful restaurants, bars, café's and gastro pubs within walking distance.

Fantastic area for families and young professionals.

TAYMOUNT RISE, SE23

Approx. Gross Internal Floor Area

1007 Sq. ft/93.54 Sq. m

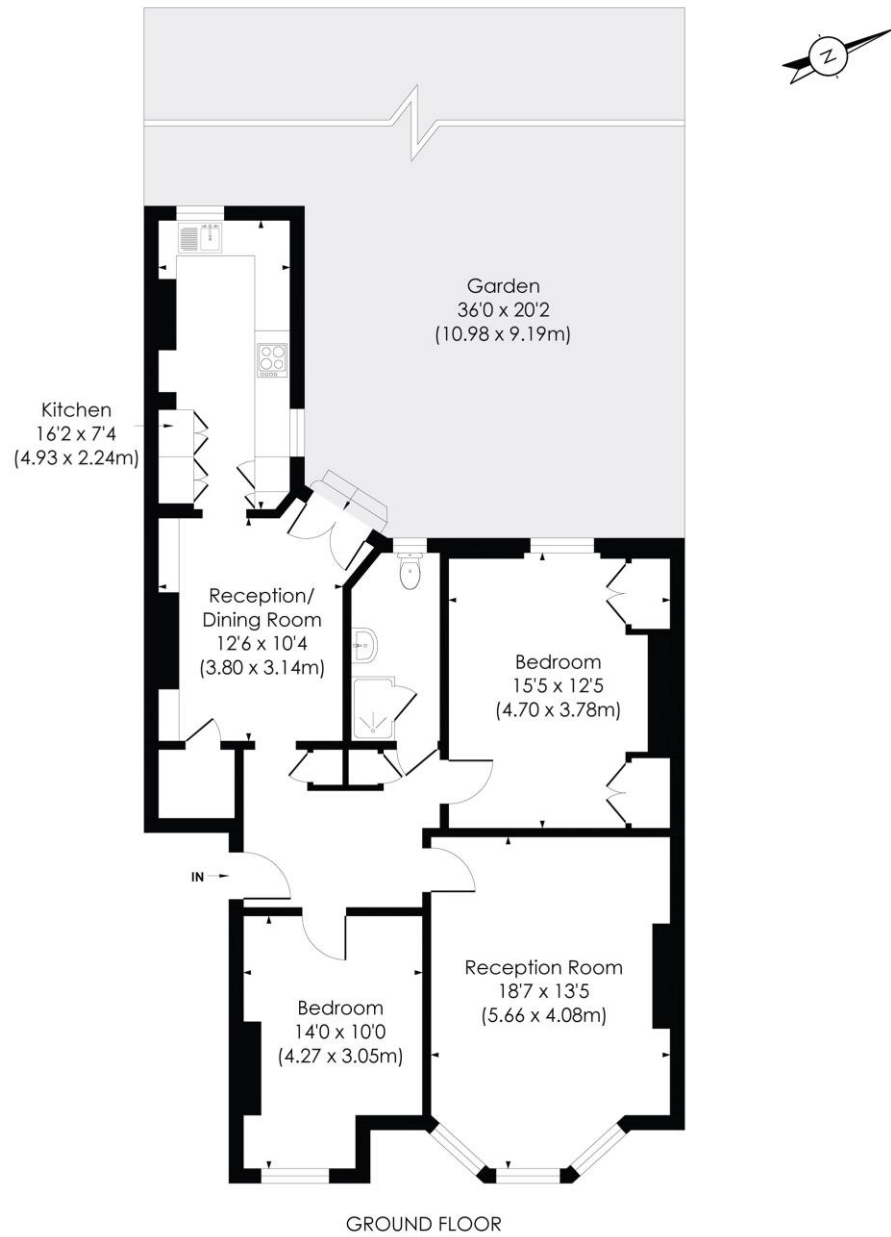

© Pixangle Property Marketing Ltd. info@pixangle.com Tel: 0208 870 2118

pixangle
PROPERTY MARKETING

This floor plan has been prepared for the purpose of illustration only in accordance with the latest RICS code of measuring practice and is not to scale. All measurements and areas are approximate and whilst every effort has been made to ensure the accuracy of the plan contained here, no responsibility is taken for any error, omission or misstatement.

NOTICE: Whilst every effort has been made to ensure the accuracy of these sales details, they are for guidance purposes only and prospective purchasers are advised to seek their own professional advice as well as to satisfy themselves by inspection or otherwise as to their correctness. No representation or warranty whatsoever is made in relation to this property by Winkworth or its employees nor do such sales details form part of any offer or contract.