



EMBASSY COURT, 125 BRADY STREET, LONDON, E1
£1,750 PER MONTH PART FURNISHED, UNFURNISHED

A MODERN SECOND FLOOR ONE BED APARTMENT WITH WOODEN FLOORS AND HIGH CEILINGS.

Shoreditch | 020 7749 7650 | shoreditch@winkworth.co.uk

Tenant Fees Apply: Details of fees for tenant referencing, tenancy agreement admin fees and renewal fees are available on the Winkworth website and the link can be found with the displayed rent for the property. Tenants should ensure they are fully conversant with these upfront fees and other costs that are involved at the outset of the tenancy before making an offer to rent and your local Winkworth office will provide written details upon request.

winkworth.co.uk

Winkworth

See things differently



DESCRIPTION:

A stunning contemporary one bedroom apartment set on the second floor of an attractive building overlooking Weavers Fields. Located within easy reach of Bethnal Green Station and tube, Shoreditch High Street Station and also Whitechapel Station, this property is perfectly located for professional tenants that require excellent transportation links. The apartment benefits from a large reception room with open-plan kitchen, modern bathroom suite, spacious bedroom with ample storage and large windows that provide an abundance of natural light. It is offered furnished and is finished to a high standard throughout.

Winkworth



Winkworth

Embassy Court, E1

Approx. Gross Internal Floor Area 504 sq. ft / 46.81 sq. m

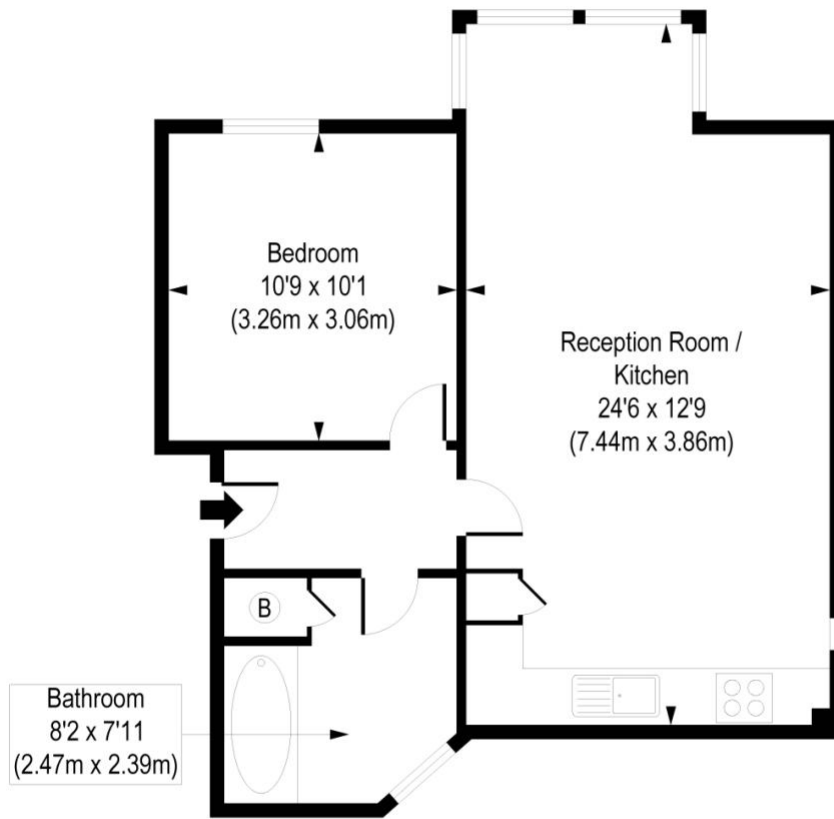
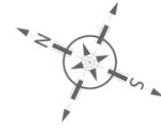

First Floor

COMPLIANT WITH RICS CODE OF MEASURING PRACTICE Floorplan is for illustrative purposes only and is not to scale. Every attempt has been made to ensure the accuracy of the floorplan shown, however all measurements, fixtures, fittings and data shown are an approximate interpretation for illustrative purposes only. Liability for errors, omissions or mis-statement through negligence or otherwise is hereby excluded.

This floorplan is for illustration purposes only and is not to scale. The position and size of doors, windows, appliances and other features are approximate.

Shoreditch | 020 7749 7650 | shoreditch@winkworth.co.uk

Winkworth

winkworth.co.uk

See things differently

Winkworth wishes to inform prospective buyers and tenants that these particulars are a guide and act as information only. All our details are given in good faith and believed to be correct at the time of printing but they don't form part of an offer or contract. No Winkworth employee has authority to make or give any representation or warranty in relation to this property. All fixtures and fittings, whether fitted or not are deemed removable by the vendor unless stated otherwise and room sizes are measured between internal wall surfaces, including furnishings.