



GROVE AVENUE, LONDON, N3
£1,100,000 FREEHOLD

A SPACIOUS, PERIOD STYLE, FAMILY HOME,
IN AN IDEAL LOCATION WITH POTENTIAL
STPP.

Finchley | 020 8349 3388 | finchley@winkworth.co.uk

Winkworth

for every step...

winkworth.co.uk



Winkworth

DESCRIPTION:

We are pleased to offer this, period style, four bedroom family home, set in an ideal location for local amenities, transport links such as Finchley Central underground and local schools. The property offers 2000 sq ft of living space and still has further potential for expansion into the loft STPP. To the ground floor the property comprises two reception rooms, large kitchen / dining area and bathroom. To the first floor the property comprises four bedrooms, with one of the bedrooms currently being occupied as a utility room and family bathroom. This lovely property does require some updating, but has the benefit of a large rear garden circa 160ft long, cellar and loft for storage and off street parking.

The property is being offered on a chain free basis.

AT A GLANCE

- Period style family home
- Two reception rooms
- Extended kitchen / dining area
- Four bedrooms
- Two bathrooms
- Large rear garden
- Cellar and Loft
- Off street parking



Winkworth



Winkworth



Grove Avenue, N3
 Approx. Gross Internal Floor Area 2000 sq. ft / 185.80 sq. m

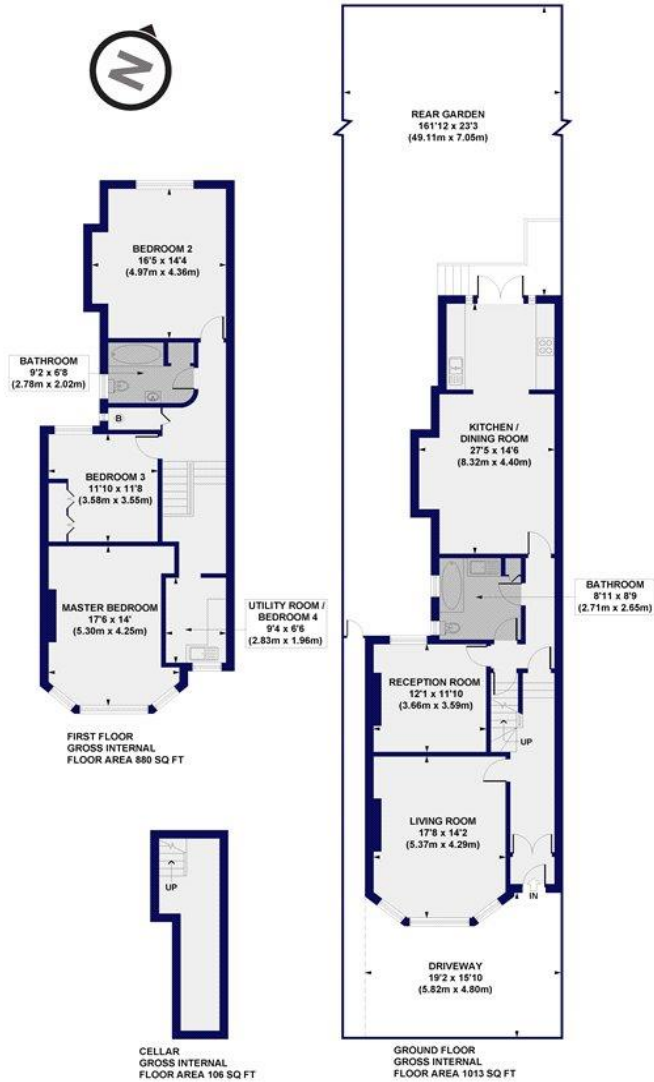

All measurements of walls, doors, windows, fittings and appliances, including their size and location, are shown as standard sizes and do not constitute any warranty or representation by the seller, their agent or CP Creative. Any intending purchaser must satisfy himself by inspection or otherwise as to the correctness of the information contained in these plans. This plan is for illustrative purposes only and should be used as such by any prospective purchasers.

Winkworth

This floorplan is for illustration purposes only and is not to scale. The position and size of doors, windows, appliances and other features are approximate.

Tenure: Freehold

Council Tax Band:

Where no figures are shown, we have been unable to ascertain the information. All figures that are shown were correct at the time of printing.

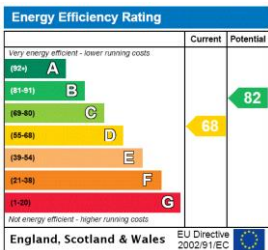

Finchley | 020 8349 3388 | finchley@winkworth.co.uk



for every step...

winkworth.co.uk

Winkworth wishes to inform prospective buyers and tenants that these particulars are a guide and act as information only. All our details are given in good faith and believed to be correct at the time of printing but they don't form part of an offer or contract. No Winkworth employee has authority to make or give any representation or warranty in relation to this property. All fixtures and fittings, whether fitted or not are deemed removable by the vendor unless stated otherwise and room sizes are measured between internal wall surfaces, including furnishings.