



ANLABY HOUSE, BOUNDARY STREET, LONDON, E2
£3,400 PER MONTH FURNISHED

DISCOVER LUXURY LIVING IN THIS EXQUISITE TWO
DOUBLE BEDROOM WAREHOUSE CONVERSION, PERFECTLY
SITUATED IN THE HIGHLY SOUGHT-AFTER BOUNDARY
STREET.

Shoreditch | 020 7749 7650 | shoreditch@winkworth.co.uk

Winkworth

Tenant Fees Apply: Details of fees for tenant referencing, tenancy agreement admin fees and renewal fees are available on the Winkworth website and the link can be found with the displayed rent for the property. Tenants should ensure they are fully conversant with these upfront fees and other costs that are involved at the outset of the tenancy before making an offer to rent and your local Winkworth office will provide written details upon request.

winkworth.co.uk

See things differently



DESCRIPTION:

Discover luxury living in this exquisite two double bedroom warehouse conversion, perfectly situated in the highly sought-after Boundary Street. This unique residence seamlessly blends historic charm with contemporary elegance, creating an ideal home for discerning city dwellers.

As you enter, you're greeted by a spacious central hallway that sets the tone for the rest of the apartment. The expansive living room, featuring stunning hardwood floors and large warehouse-style windows, floods the space with natural light and offers a perfect setting for both relaxation and entertaining. The high-quality fitted kitchen, open plan to the living room, is a chef's dream with modern appliances and stylish finishes.

The property boasts two generously sized double bedrooms, each offering excellent proportions and ample storage space. The master bedroom includes a luxurious ensuite shower room, providing a private retreat within the home.

Winkworth



Winkworth

Boundary Street, E2
Approx. Gross Internal Floor Area 841 sq. ft / 78.10 sq. m

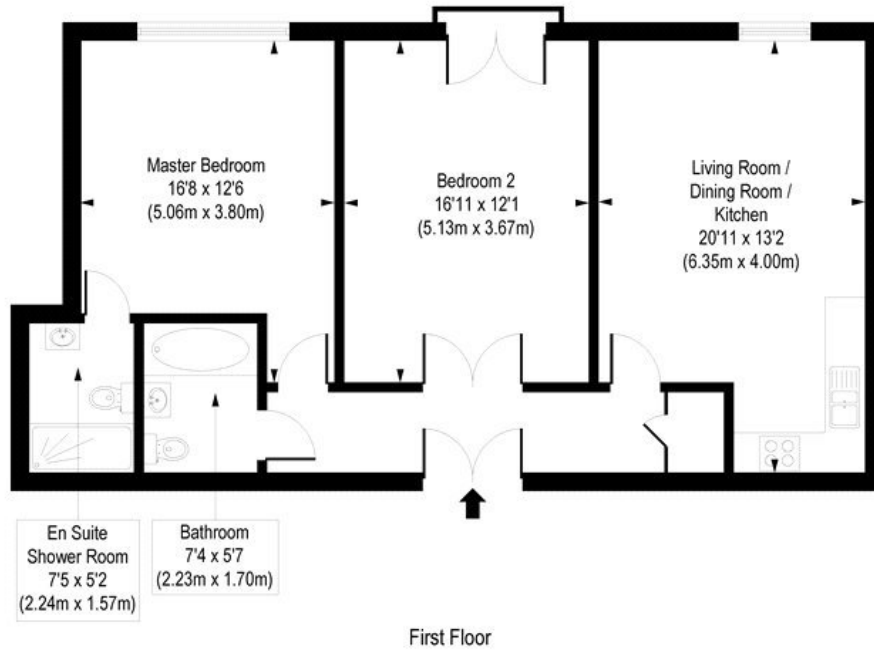
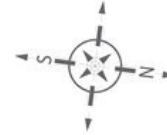

First Floor

COMPLIANT WITH RICS CODE OF MEASURING PRACTICE Floorplan is for illustrative purposes only and is not to scale. Every attempt has been made to ensure the accuracy of the floorplan shown, however all measurements, fixtures, fittings and data shown are an approximate interpretation for illustrative purposes only. Liability for errors, omissions or mis-statement through negligence or otherwise is hereby excluded.

This floorplan is for illustration purposes only and is not to scale. The position and size of doors, windows, appliances and other features are approximate.

Shoreditch | 020 7749 7650 | shoreditch@winkworth.co.uk

Winkworth

winkworth.co.uk

See things differently

Winkworth wishes to inform prospective buyers and tenants that these particulars are a guide and act as information only. All our details are given in good faith and believed to be correct at the time of printing but they don't form part of an offer or contract. No Winkworth employee has authority to make or give any representation or warranty in relation to this property. All fixtures and fittings, whether fitted or not are deemed removable by the vendor unless stated otherwise and room sizes are measured between internal wall surfaces, including furnishings.