



WOOD LANE, LONDON, NW9  
**£600,000 FREEHOLD**

## BEAUTIFUL THREE BEDROOM SEMI-DETACHED BUNGALOW

Kingsbury | 020 8204 0000 | [kingsbury@winkworth.co.uk](mailto:kingsbury@winkworth.co.uk)

**Winkworth**

for every step...

[winkworth.co.uk](http://winkworth.co.uk)



A charming three-bedroom semi-detached bungalow situated in a sought-after neighbourhood. Recently upgraded to a high specification with a tasteful neutral palette, this property offers a comfortable and spacious living environment. It boasts three bedrooms, including a master with an en suite, and a stylish family bathroom adorned with gold fixtures for a touch of elegance. The well-appointed kitchen adjoins a spacious lounge with French doors leading to a generously sized rear garden. Additional features include a garage for your storage needs. The property is located close to the picturesque Welsh Harp Reservoir, which offers boating and sailing clubs in a scenic setting. Local amenities and transport links are conveniently available on Church Lane, with numerous recreation grounds and schools also in close proximity. Competitively priced, this property is must-see.



**Winkworth**

for every step...





**Winkworth**

for every step...

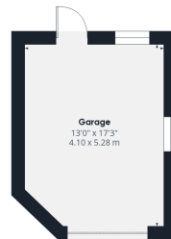
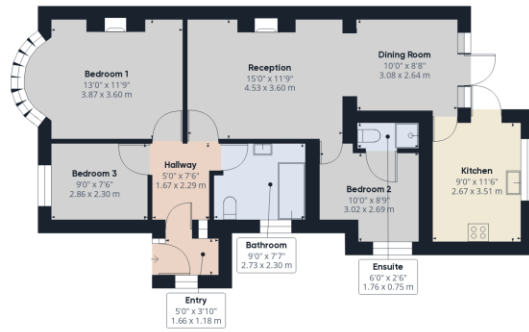

**Approximate total area<sup>(1)</sup>**  
 1073.48 ft<sup>2</sup>  
 99.73 m<sup>2</sup>

(1) Excluding balconies and terraces

While every attempt has been made to ensure accuracy, all measurements are approximate, not to scale. This floor plan is for illustrative purposes only.

GIRAFFE360

This floorplan is for illustration purposes only and is not to scale. The position and size of doors, windows, appliances and other features are approximate.

**Tenure:** Freehold

**Council Tax Band:** D

Where no figures are shown, we have been unable to ascertain the information. All figures that are shown were correct at the time of printing.

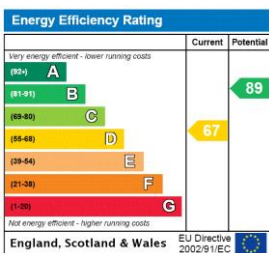

Kingsbury | 020 8204 0000 | kingsbury@winkworth.co.uk



for every step...

winkworth.co.uk

Winkworth wishes to inform prospective buyers and tenants that these particulars are a guide and act as information only. All our details are given in good faith and believed to be correct at the time of printing but they don't form part of an offer or contract. No Winkworth employee has authority to make or give any representation or warranty in relation to this property. All fixtures and fittings, whether fitted or not are deemed removable by the vendor unless stated otherwise and room sizes are measured between internal wall surfaces, including furnishings.