



LANSDOWNE ROAD, W11

£750 PER WEEK (£3,250.00 PCM) FURNISHED

A LOVELY BRIGHT 3 DOUBLE BEDROOM FLAT ON 3RD FLOOR OF THIS CORNER BUILDING WITH LIFT AND DIRECT ACCESS TO THE STUNNING COMMUNAL GARDENS BEHIND (CHARGES MAY APPLY).

Notting Hill Lettings | 0207 727 3227 | nottinghill@winkworth.co.uk

Winkworth

for every step...

winkworth.co.uk



DESCRIPTION:

A lovely bright three double bedroom flat on the third floor of this corner building with lift and direct access to the stunning communal gardens behind (charges may apply).

LOCATION:

Lansdowne Road runs from Holland Park to Ladbroke Grove. This property is located where Lansdowne Road joins Ladbroke Grove, a short walk from the famous Portobello Road and all the local restaurants, shops and bars.

Utilities:

Electricity – Mains

Water – Mains

Sewerage – Mains

Heating – Gas

Broadband <https://checker.ofcom.org.uk/en-gb/broadband-coverage>

Mobile Coverage <https://checker.ofcom.org.uk/en-gb/mobile-coverage>





Lansdowne Road, W11

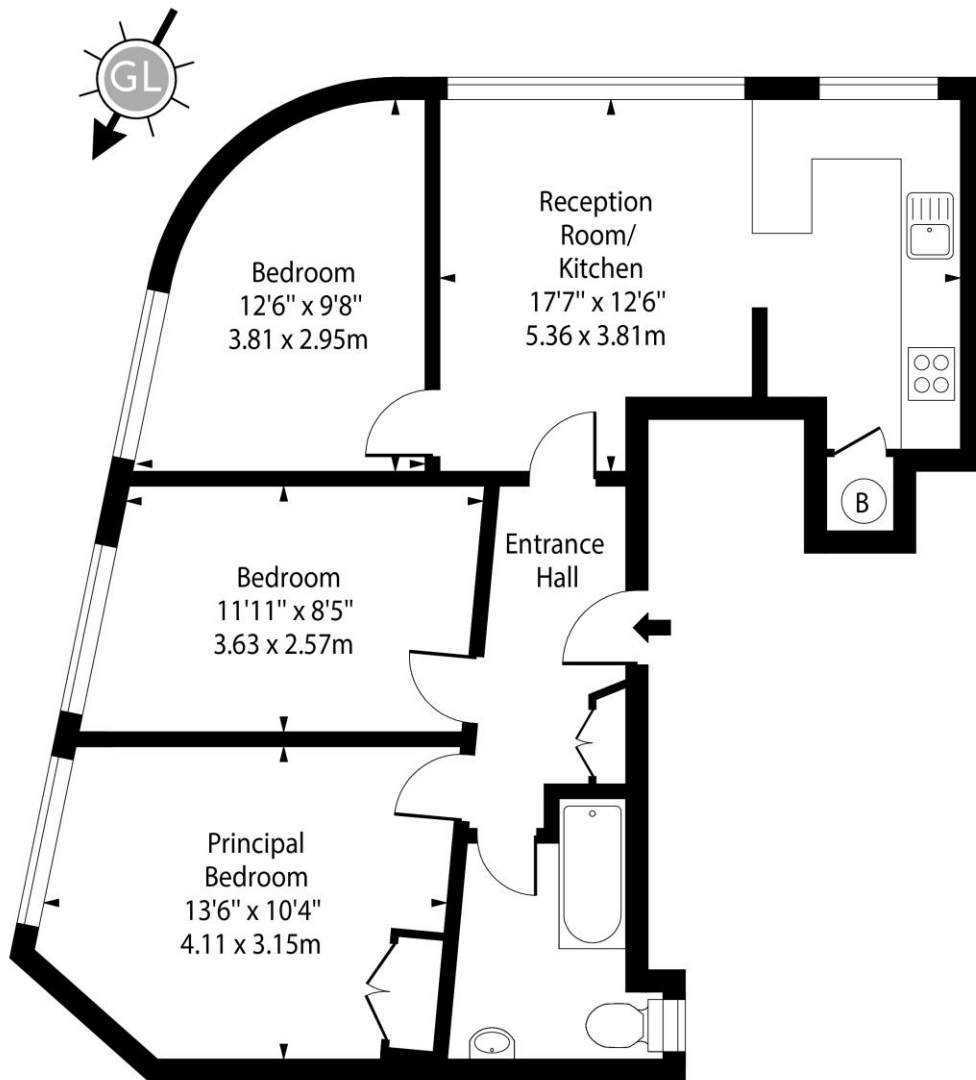

Second Floor

Approx Gross Internal Area 670 Sq Ft - 62.24 Sq M

For Illustration Purposes Only - Not To Scale

www.goldlens.co.uk

Ref. No. 023348E

This floorplan is for illustration purposes only and is not to scale. The position and size of doors, windows, appliances and other features are approximate.

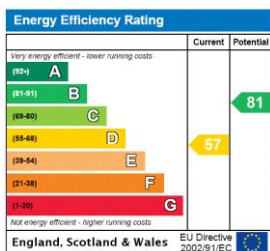

Deposit: £3,750

Holding Deposit: £750

Council Tax Band: F (RBKC)

Where no figures are shown, we have been unable to ascertain the information. All figures that are shown were correct at the time of printing.

Notting Hill Lettings | 0207 727 3227 | nottinghill@winkworth.co.uk

Winkworth

for every step...

winkworth.co.uk

Winkworth wishes to inform prospective buyers and tenants that these particulars are a guide and act as information only. All our details are given in good faith and believed to be correct at the time of printing but they don't form part of an offer or contract. No Winkworth employee has authority to make or give any representation or warranty in relation to this property. All fixtures and fittings, whether fitted or not are deemed removable by the vendor unless stated otherwise and room sizes are measured between internal wall surfaces, including furnishings.