



WARWICK CRESCENT, LONDON, W2 £775,000 LEASEHOLD

Located opposite the Grand Union Canal, Winkworth Maida Vale are excited to offer this three bedroom duplex apartment located on the raised ground floor and first floor of this purpose built block. Offering in excess of 840 square feet, the apartment boasts a well-proportioned reception room with large windows, facing Little Venice's famous waterway. Off the reception room is a sizeable kitchen facing the block's communal gardens. On the first floor there are two double bedrooms (both with built-in storage), along with a third bedroom and large family bathroom. Additionally, there are built in storage cupboards located throughout the two floors. Warwick Crescent is ideally situated (0.3 miles) for Warwick Avenue Underground Station (Bakerloo Line), whilst 0.3 miles from Paddington Station (National Rail, Heathrow Express, London Underground, including the Elizabeth Line) as well as 0.5 miles from the many restaurants and shops that Clifton Road offers.

Three Double Bedrooms | Family Bathroom | Kitchen | Reception Room | Storage Cupboards | Communal Gardens | Leasehold

Winkworth

for every step...

winkworth.co.uk/maida-vale



Warwick Crescent, London W2 6NE

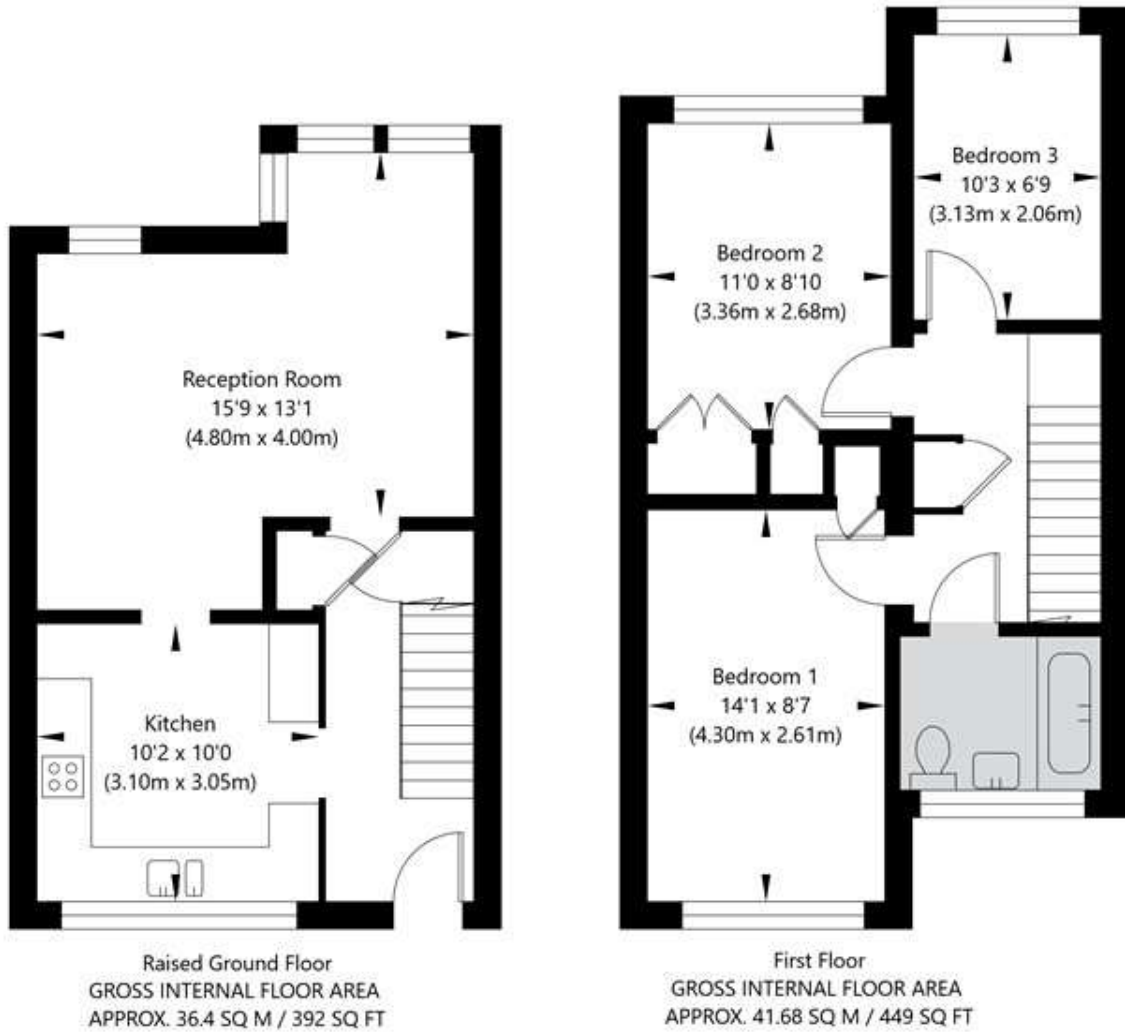

APPROXIMATE GROSS INTERNAL FLOOR AREA 78.08 SQ M / 841 SQ FT
THIS FLOOR PLAN IS FOR ILLUSTRATIVE PURPOSES ONLY AND
SHOULD BE USED FOR THIS PURPOSE BY PROSPECTIVE APPLICANTS AS ITS NOT TO SCALE.

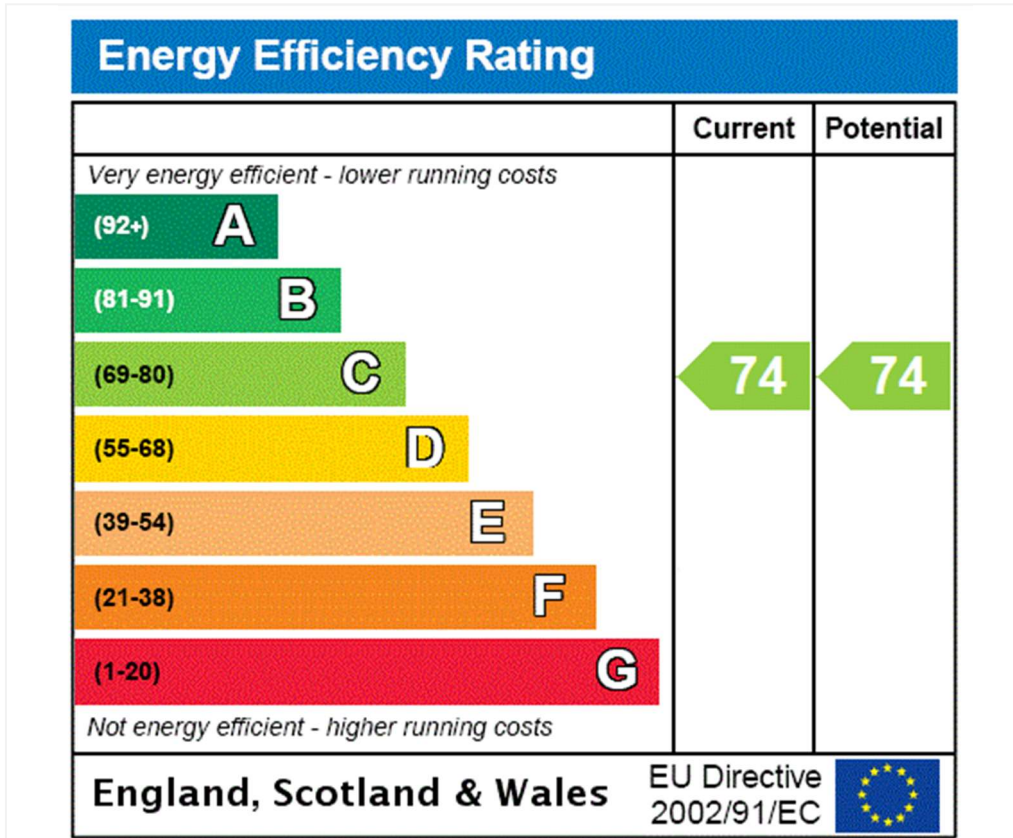

Tenure: Leasehold

Term: Expires - 28/01/2197

Service Charge: £2,433.6 per annum

Ground Rent: £ 0 Annually (subject to increase)

Council Tax Band: D

Where no figures are shown, we have been unable to ascertain the information. All figures that are shown were correct at the time of printing.

Where no figures are shown, we have been unable to ascertain the information. All figures that are shown were correct at the time of printing. These particulars are not an offer or contract, nor part of one. You should not rely on statements by Winkworth in the particulars or by word of mouth or in writing "information" as being factually accurate about the property, its condition or its value. Winkworth does not have any authority to make any representations about the property, and accordingly any information given is entirely without responsibility on the part of the agents, seller(s) or lessor(s). These particulars are prepared on the basis of the information supplied by our client and are a rough guide for information only. The photographs show only certain parts of the property. We are not able to check all of the information and therefore are unable to guarantee accuracy. All interested parties are therefore advised to undertake all necessary inspections and checks that they deem appropriate. Where displayed, the square footage is taken from the floor plans, which are created by an independent supplier. These measurements are approximate and included for illustrative purposes only. The measurements may vary. Winkworth does not make any representation as to the accuracy of these measurements and you should seek to verify them for yourself. Winkworth accept no liability for any loss you may suffer if you rely on these measurements. All fixtures and fittings, whether fitted or not are deemed removable by the vendor unless stated. Any reference to alterations to, or use of, any part of the property does not mean that any necessary planning, building regulations or other consent has been obtained. Amenities and appliances have not been tested

Maida Vale | 211-213 Sutherland Avenue, London, W9 1RU | 020 7289 1692 |



for every step...

winkworth.co.uk/maida-vale

Winkworth wishes to inform prospective buyers and tenants that these particulars are a guide and act as information only. All our details are given in good faith and believed to be correct at the time of printing but they don't form part of an offer or contract. No Winkworth employee has authority to make or give any representation or warranty in relation to this property. All fixtures and fittings, whether fitted or not are deemed removable by the vendor unless stated otherwise and room sizes are measured between internal wall surfaces, including furnishings.