



UPPER RICHMOND ROAD, SW15

**£3,000 PER MONTH FURNISHED, PART FURNISHED, UNFURNISHED**

**A stunning two bedroom two bathroom apartment extending to 936 sq. ft. in a sought-after development in central Putney**

Putney | 020 8877 1000 | [putney@winkworth.co.uk](mailto:putney@winkworth.co.uk)



## DESCRIPTION:

This lateral apartment is located on the second floor and benefits from a light and airy kitchen/reception room with raised dining area. Off the kitchen is a useful utility room with washer and dryer. The master bedroom features built-in wardrobes and luxurious ensuite bathroom with bath and shower over. The second bedroom also has built-in wardrobes and is serviced by a well-appointed bathroom with walk-in shower. There is a further storage cupboard in the hallway. Accessed from every room is a west facing balcony extending to 33 ft in length with views of the landscaped communal gardens. Parking via separate negotiation and subject to availability. Tileman House residents benefit from a secure building, a lift, concierge service and communal gardens. The development is located just 0.1 miles away from Putney Station which offers easy access to Waterloo, as well as just 0.2 miles from East Putney underground station which offers the district line. Putney local amenities are nearby and they include cafes, restaurants, bars and cinema.





Upper Richmond Road, SW15  
Approx. Gross Internal Floor Area 936 sq. ft / 86.94 sq. m

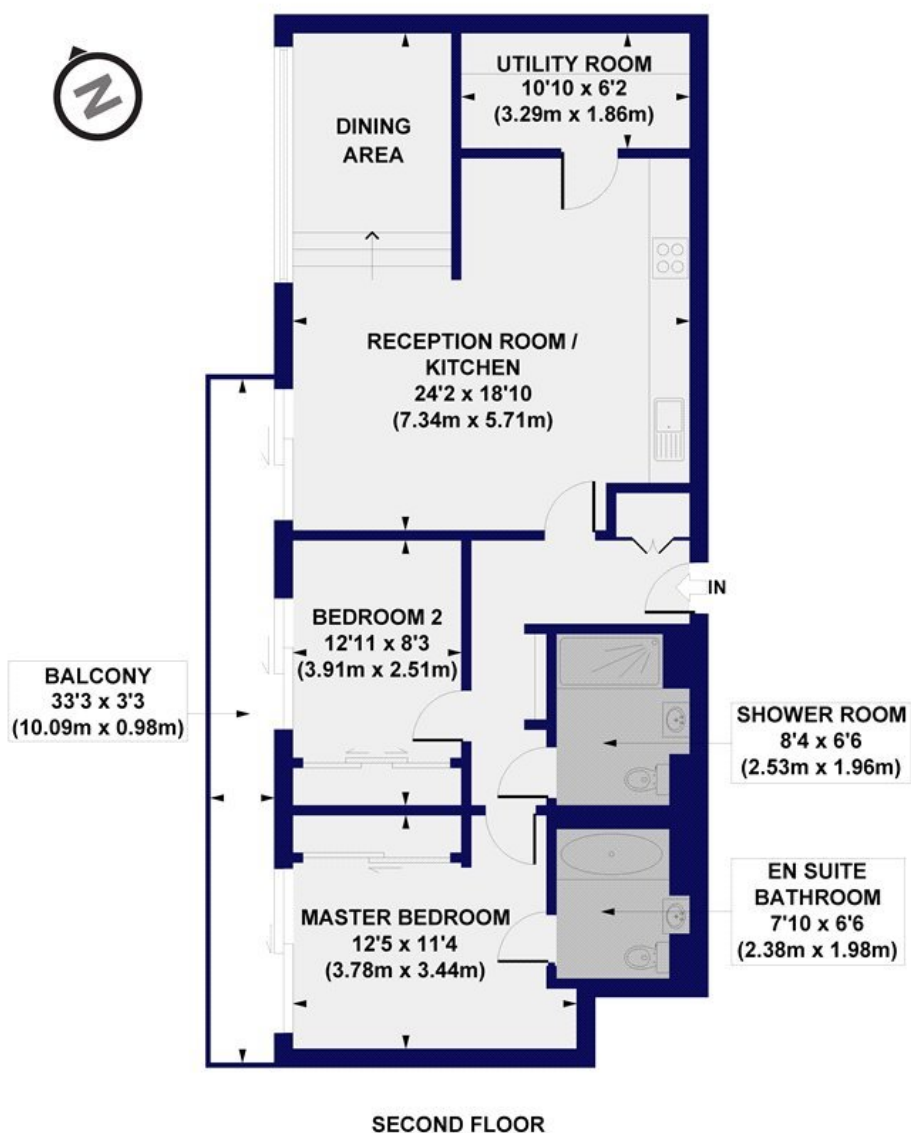

All measurements of walls, doors, windows, fittings and appliances, including their size and location, are shown as standard sizes and do not constitute any warranty or representation by the seller, their agent or CP Creative. Any intending purchaser must satisfy himself by inspection or otherwise as to the correctness of the information contained in these plans. This plan is for illustrative purposes only and should be used as such by any prospective purchasers.

**Winkworth**

This floorplan is for illustration purposes only and is not to scale. The position and size of doors, windows, appliances and other features are approximate.

**Deposit:** 1 week's rent

**Holding Deposit:** 5 weeks' rent

**Council Tax Band:** TBC

Where no figures are shown, we have been unable to ascertain the information. All figures that are shown were correct at the time of printing.