



BROOKLYN COURT, MAIN ROAD, OTTERBOURNE, HAMPSHIRE, SO21
£225,000 LEASEHOLD

Superb Apartment in Lovely Village Setting

Winchester, 01962866777, winchester@winkworth.co.uk

Winkworth

for every step...

winkworth.co.uk

DESCRIPTION:

This modern, well-presented apartment is situated in an exclusive gated development constructed by Pride Homes in 2004. Conveniently located in the heart of the sought after village of Otterbourne, highly regarded because of its proximity to the city and station, and because it has such an active community.

The property offers well-planned accommodation with nicely proportioned rooms. A lift provides access to the first floor where the communal entrance hall leads to the apartment. The hallway within provides access to all the accommodation. The sitting room is an excellent size with two windows to the front and the generous bedroom lies alongside. The kitchen is well-appointed with an integrated oven and hob along with a freestanding fridge/freezer and washing machine.

Access to Brooklyn Court is via an electric gated entrance and the apartment has an allocated parking space, with further visitor parking available. There is a secure outside bicycle/storage area, and beautiful communal gardens which are mainly laid to lawn with many mature trees and a stream.

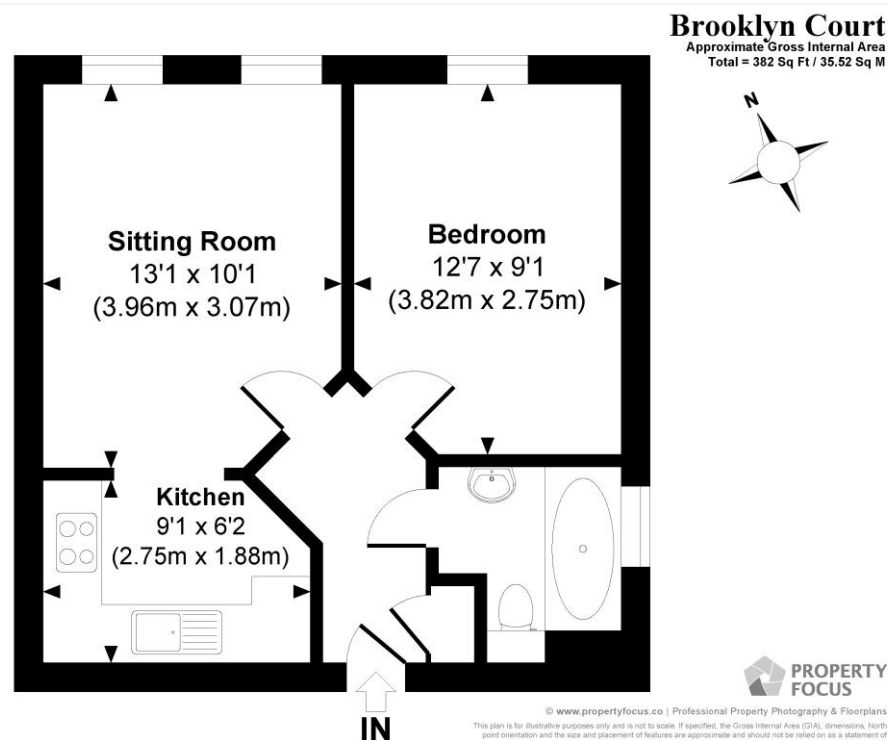

This floorplan is for illustration purposes only and is not to scale. The position and size of doors, windows, appliances and other features are approximate.

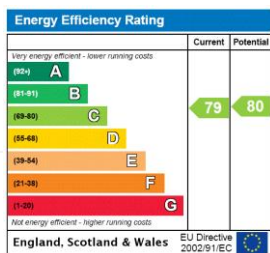

Tenure: Leasehold

Term: 104 year and 8 months

Service Charge: £2520 per annum

Ground Rent: £150 per annum

Council Tax Band: B

Where no figures are shown, we have been unable to ascertain the information. All figures that are shown were correct at the time of printing.

Winchester | 01962866777 | winchester@winkworth.co.uk

Winkworth

for every step...

winkworth.co.uk

Winkworth wishes to inform prospective buyers and tenants that these particulars are a guide and act as information only. All our details are given in good faith and believed to be correct at the time of printing but they don't form part of an offer or contract. No Winkworth employee has authority to make or give any representation or warranty in relation to this property. All fixtures and fittings, whether fitted or not are deemed removable by the vendor unless stated otherwise and room sizes are measured between internal wall surfaces, including furnishings.