



HOLDERS HILL GARDENS, HENDON, LONDON, NW4  
**OIEO £870,000 FREEHOLD**

## FOUR BEDROOM, SPACIOUS SEMI-DETACHED FAMILY HOME

Kingsbury | 020 8204 0000 | [kingsbury@winkworth.co.uk](mailto:kingsbury@winkworth.co.uk)

**Winkworth**

for every step...

[winkworth.co.uk](http://winkworth.co.uk)



**DESCRIPTION:**Winkworth are proud to present this charming four-bedroom semi-detached house, beautifully positioned in one of Hendon's most popular residences overlooking the serene Windsor Open Space. This inviting home serves as the perfect blank canvas for a family looking to infuse with their personal creative touch. The ground floor features a spacious through lounge, ideal for both relaxation and entertaining, and a well-appointed kitchen with a dining area, perfect for family meals. The first-floor hosts three well-sized bedrooms and a family bathroom, providing ample space for the entire family. The loft extension comprises a master bedroom with an en suite shower room, offering a private retreat within the home.



**Winkworth**

for every step...



**Winkworth**

for every step...

# Holdings Hill Gardens, NW4

Approx. Gross Internal Floor Area 1384 sq. ft / 128.63 sq. m (Including Storage)

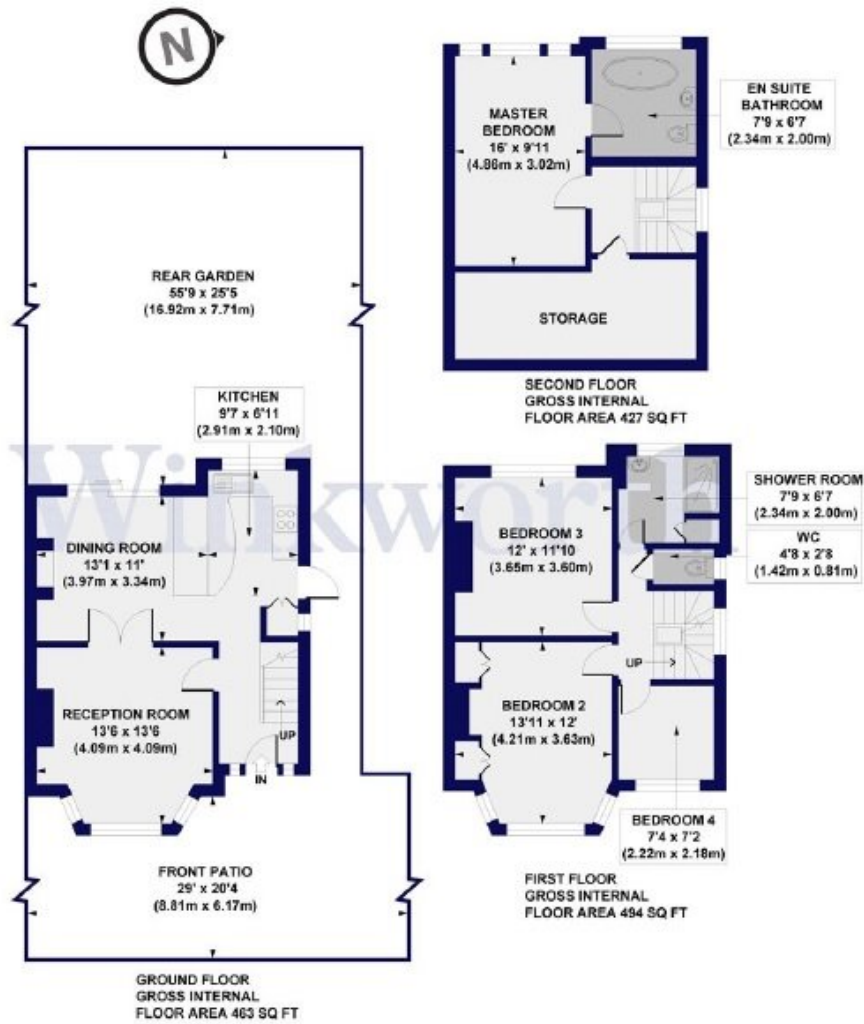

All measurements of walls, doors, windows, fittings and appliances, including their size and location, are shown as standard sizes and do not constitute any warranty or representation by the seller, their agent or CP Creative. Any intending purchaser must satisfy himself by inspection or otherwise as to the correctness of the information contained in these plans. This plan is for illustrative purposes only and should be used as such by any prospective purchasers.



This floorplan is for illustration purposes only and is not to scale. The position and size of doors, windows, appliances and other features are approximate.

Energy Efficiency Rating	
Current	Potential
Very energy efficient - lower running costs	
A (92)	71
B (81-91)	
C (69-80)	
D (55-68)	
E (39-54)	
F (21-58)	
G (1-20)	
Not energy efficient - higher running costs	
England, Scotland & Wales	
EU Directive 2002/91/EC	

Tenure: Freehold

Council Tax Band: E

Where no figures are shown, we have been unable to ascertain the information. All figures that are shown were correct at the time of printing.

Kingsbury | 020 8204 0000 | kingsbury@winkworth.co.uk



for every step...

winkworth.co.uk

Winkworth wishes to inform prospective buyers and tenants that these particulars are a guide and act as information only. All our details are given in good faith and believed to be correct at the time of printing but they don't form part of an offer or contract. No Winkworth employee has authority to make or give any representation or warranty in relation to this property. All fixtures and fittings, whether fitted or not are deemed removable by the vendor unless stated otherwise and room sizes are measured between internal wall surfaces, including furnishings.