



GRANVILLE PARK, LEWISHAM, SE13 7DW
£450,000

A LARGE TWO DOUBLE BEDROOM PERIOD CONVERSION FOUND ON THE FIRST FLOOR OF THIS IMPRESSIVE FOUR STOREY VICTORIAN HOUSE WITH A COMMUNAL GARDEN AND LOCATED CLOSE TO THE HEATH AND LEWISHAM STATION AND DLR.

Blackheath | 0208 8520999 | blackheath@winkworth.co.uk



DESCRIPTION:

A large two double bedroom period conversion found on the first floor of this impressive four storey Victorian house with a communal garden and located close to the Heath and Lewisham Station and DLR.

The accommodation comprise; a large 13'6 x 12'6 living room, and a separate and good sized kitchen, a large 13'8 x 13'6 master bedroom, second double bedroom and a bathroom with roll top bath with shower over. To the rear of the property is a good size communal garden. Features include sash windows and high ceilings.

This is a wonderful flat and the property is sold chain free. Your immediate viewing is strongly recommended.

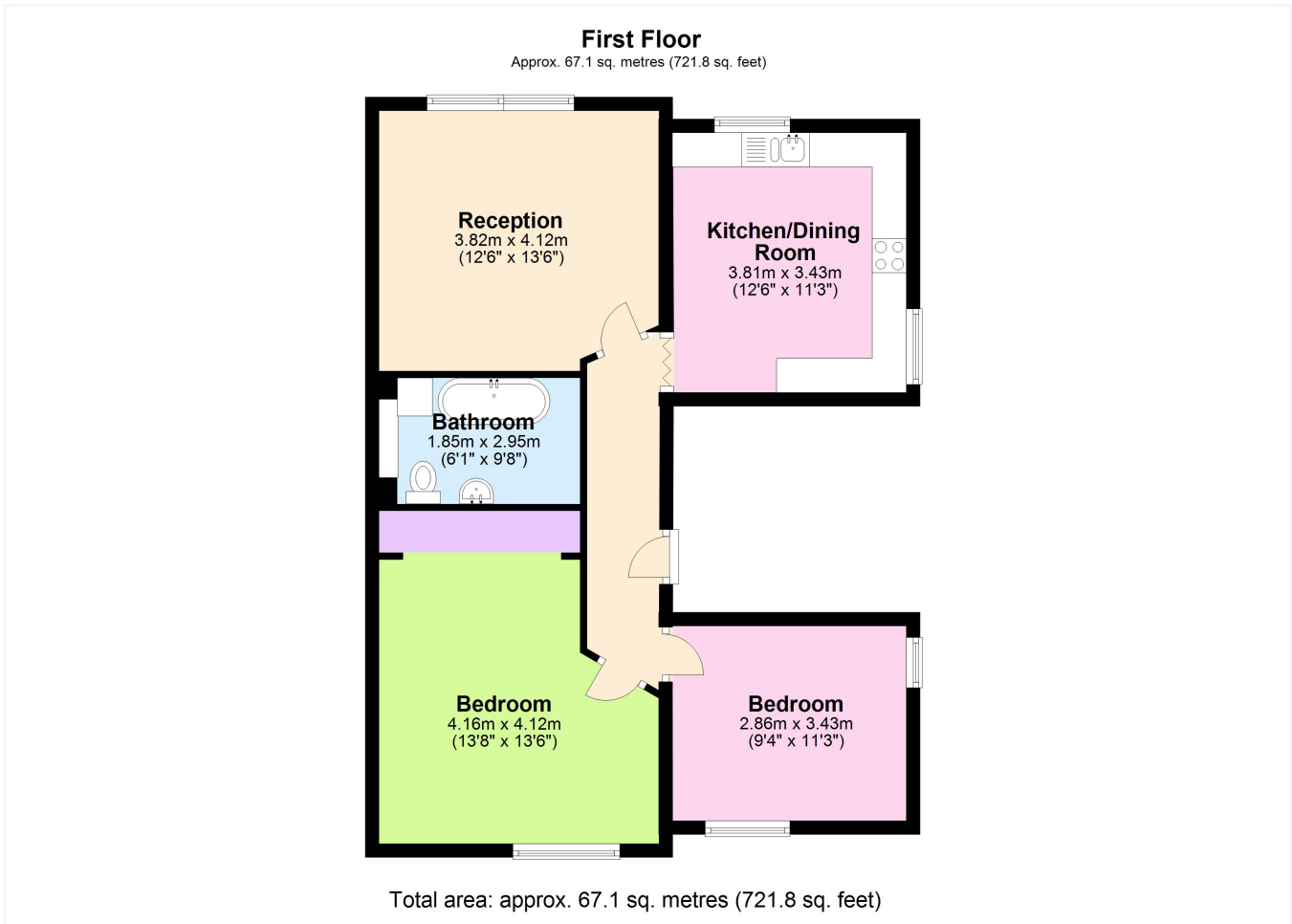

This floorplan is for illustration purposes only and is not to scale. The position and size of doors, windows, appliances and other features are approximate. Any lease and service charge details have been provided by the vendor. Any interest party should have these checked by a solicitor as part of the purchase process.

Energy Efficiency Rating		Current	Potential
Very energy efficient - lower running costs			
(92-100)	A		
(81-91)	B		
(69-80)	C		
(55-68)	D	66	79
(39-54)	E		
(21-38)	F		
(1-20)	G		
Not energy efficient - higher running costs			
England, Scotland & Wales		EU Directive 2002/91/EC	

Blackheath | 0208 8520999 | blackheath@winkworth.co.uk

