



ABERDEEN ROAD, LONDON, N5  
£580,000 SHARE OF FREEHOLD

A BRIGHT, ONE DOUBLE BEDROOM, RAISED  
GROUND FLOOR APARTMENT WITH  
COMMUNAL GARDEN.

Islington | 0207 354 2480 | [islington@winkworth.co.uk](mailto:islington@winkworth.co.uk)

**Winkworth**

[winkworth.co.uk](http://winkworth.co.uk)

See things differently





## DESCRIPTION:

A stunning, one double bedroom apartment positioned in this handsome Victorian building in Highbury, N5. Set on the raised ground floor, the property offers sensational light throughout from an east-west facing aspect and retains many original features. Accommodation comprises of a wonderfully spacious reception room benefiting from the original fireplace, ornate cornicing and original windows, while a fully fitted kitchen located at the rear of the property leads out into a tranquil, almost 70 ft, west facing garden shared with only one other flat. The property is completed with a sizeable double bedroom overlooking neighbouring gardens and a modern family bathroom.

The flat is set at the preferred end of Aberdeen Road, set just off the prestigious Aberdeen Park, on a no through road and is moments from Highbury Fields.

The well renowned Highbury barn offers a selection of independent local shops including Bournes fishmonger, Godfreys butcher, Di Marios Deli alongside various restaurants and tea rooms. Upper Street is only a short distance away and a selection of transport links are on hand for easy access to the City and West End.

Highbury and Islington offers the Victoria line and overground services whilst the Piccadilly line operates

**Winkworth**





Winkworth

**Aberdeen Road, N5**  
**Approx. Gross Internal Floor Area 454 sq. ft / 42.14 sq. m**

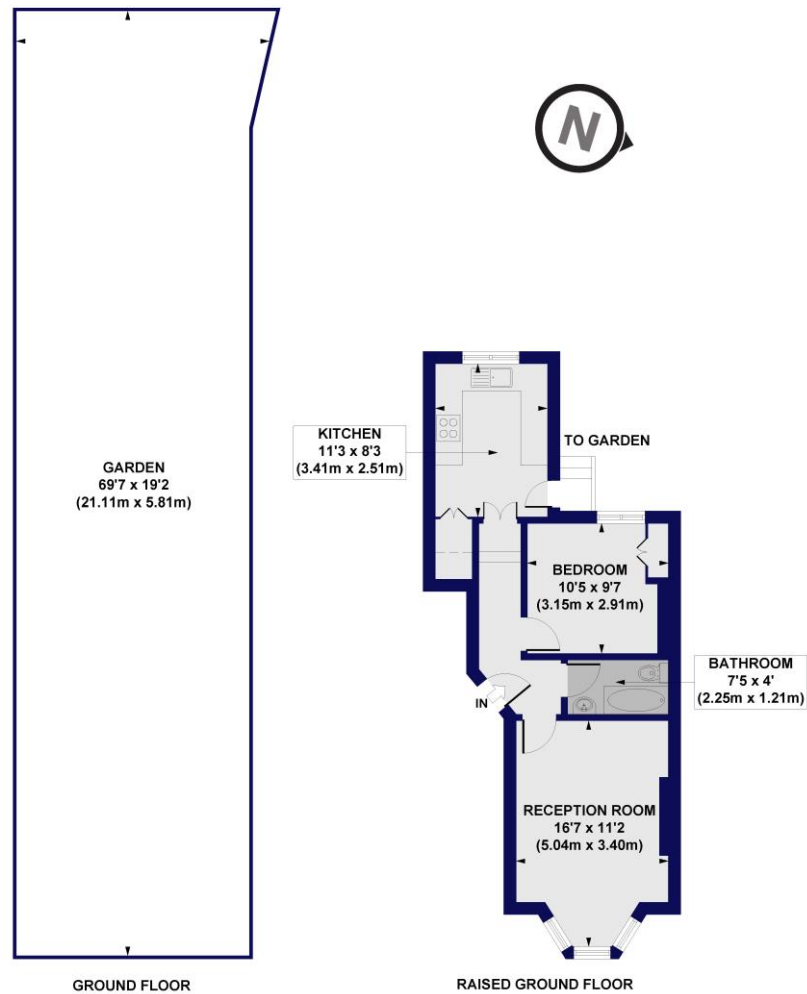

All measurements of walls, doors, windows, fittings and appliances, including their size and location, are shown as standard sizes and do not constitute any warranty or representation by the seller, their agent or CP Creative. Any intending purchaser must satisfy himself by inspection or otherwise as to the correctness of the information contained in these plans. This plan is for illustrative purposes only and should be used as such by any prospective purchasers.

**Winkworth**

This floorplan is for illustration purposes only and is not to scale. The position and size of doors, windows, appliances and other features are approximate.

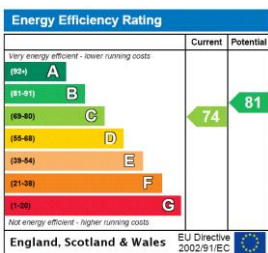

Islington | 0207 354 2480 | islington@winkworth.co.uk



winkworth.co.uk

See things differently

Winkworth wishes to inform prospective buyers and tenants that these particulars are a guide and act as information only. All our details are given in good faith and believed to be correct at the time of printing but they don't form part of an offer or contract. No Winkworth employee has authority to make or give any representation or warranty in relation to this property. All fixtures and fittings, whether fitted or not are deemed removable by the vendor unless stated otherwise and room sizes are measured between internal wall surfaces, including furnishings.