



WILTON ROAD, SW1V

£585,000

LEASEHOLD

At a glance...

- Modern Building
- One Bedroom
- 10th Floor with Lift
- Communal Roof Terrace
- Over 500 Square Feet
- Council Tax Band: D

Winkworth

for every step...



Energy Efficiency Rating		
	Current	Potential
Very energy efficient - lower running costs		
(92+) A		
(81-91) B		
(69-80) C	79	80
(55-68) D		
(39-54) E		
(21-38) F		
(1-20) G		
Not energy efficient - higher running costs		
England, Scotland & Wales	EU Directive 2002/91/EC	

WILTON ROAD, SW1V

£585,000

LEASEHOLD

A smart one bedroom flat in an incredibly convenient location - a stone's throw from Victoria Station.

Located on the 10th floor (with lift) the flat is bright and well presented offering over 500 sq ft.

With a communal roof terrace and being right in the heart of SW1, this flat would make an excellent London base or rental investment.

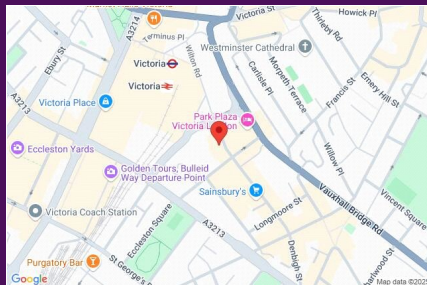

winkworth wishes to inform prospective buyers and tenants that these particulars are a guide and act as information only. All our details are given in good faith and believed to be correct at the time of printing but they don't form part of an offer or contract. No winkworth employee has authority to make or give any representation or warranty in relation to this property. All fixtures and fittings, whether fitted or not are deemed removable by the vendor unless stated otherwise and room sizes are measured between internal wall surfaces, including fire-chimneys.

Barrington Court, Wilton Road, SW1V

Approximate Gross Internal Area
47.98 sq m / 516 sq ft

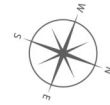

(CH = Ceiling Heights)

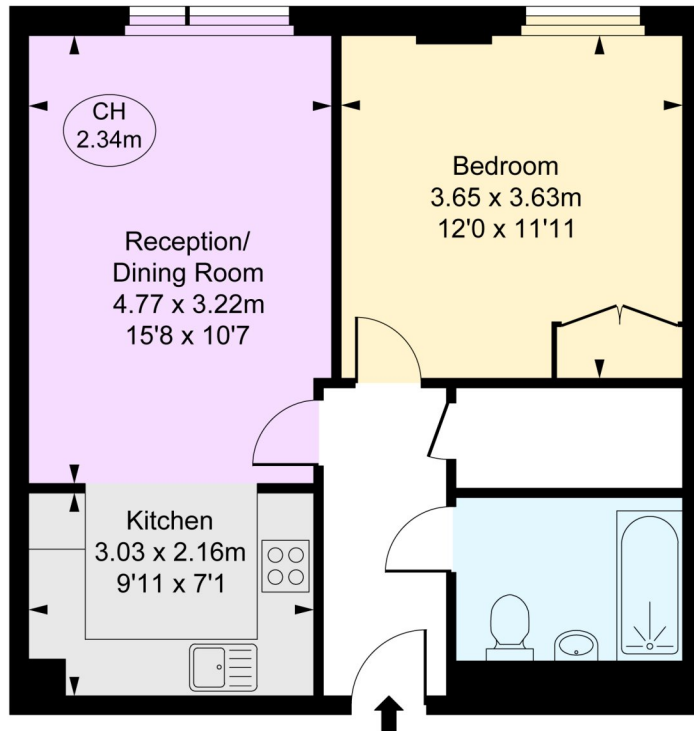

Tenth Floor

FULHAM
PERFORMANCE
PRECISION YOU CAN TRUST

This plan is not to a given scale. A detailed layout plan with dimensions is available on request.
All quoted measurements and areas are within 1% tolerance and have been prepared in accordance with industry standards as defined in the RICS Code of Measuring Practice.
© Fulham Performance

Pimlico & Westminster

020 7828 1786

pimlico@winkworth.co.uk

winkworth.co.uk/pimlico-westminster

Winkworth

for every step...