



FITZHUGH GROVE, SW18  
£350,000 LEASEHOLD

## A SUPERB TWO DOUBLE BEDROOM FIRST FLOOR FLAT

Tooting | 020 8767 5221 | tooting@winkworth.co.uk

**Winkworth**

for every step...

[winkworth.co.uk](http://winkworth.co.uk)



## DESCRIPTION:

This beautifully and immaculately presented first floor flat boasts two spacious double bedrooms, a sleek shower room, and a bright open-plan kitchen and reception area that seamlessly flows out onto a charming balcony. Additionally, residents enjoy the convenience of off-street parking and access to communal gardens.

Nestled within Morville House, part of a distinctive cluster of five buildings constructed after the war near the picturesque Wandsworth Common and neighbouring the historic Royal Victoria Patriotic Building, this residence offers a blend of modern comfort and historical charm. The nearby Clapham Junction railway station provides effortless connections to various destinations, while the vibrant neighbourhood is adorned with an array of specialty shops, eateries, and lively bars, ensuring a vibrant and convenient lifestyle.



# Moreville House, SW18

Approx. Gross Internal Floor Area 510 sq. ft / 47.34 sq. m

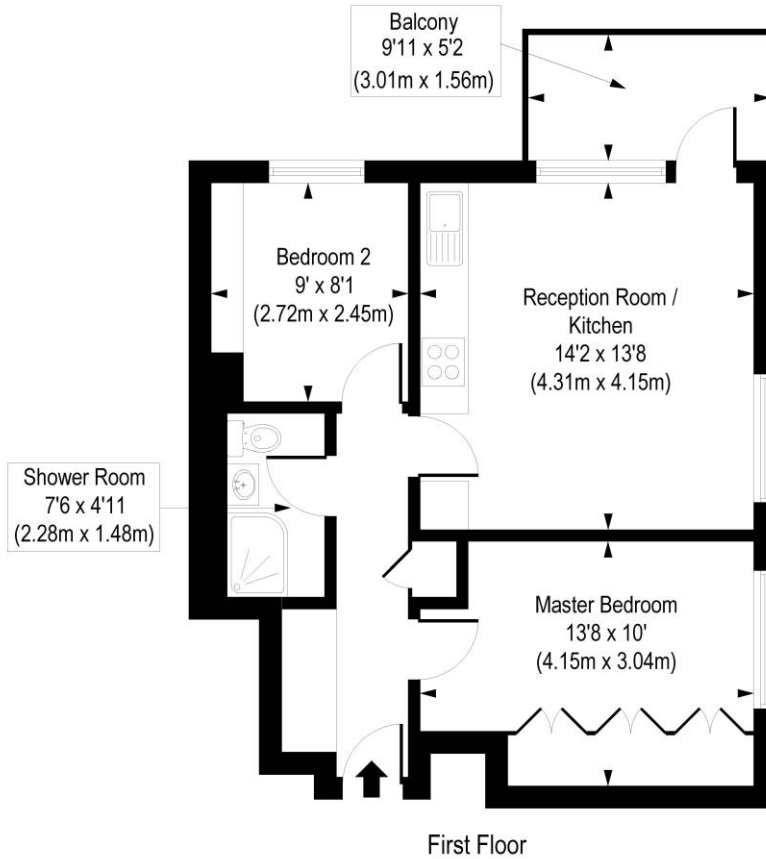
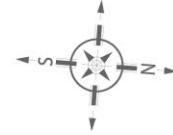

COMPLIANT WITH RICS CODE OF MEASURING PRACTICE. Floorplan is for illustrative purposes only and is not to scale. Every attempt has been made to ensure the accuracy of the floorplan shown, however all measurements, fixtures, fittings and data shown are an approximate interpretation for illustrative purposes only. Liability for errors, omissions or mis-statement through negligence or otherwise is hereby excluded.

This floorplan is for illustration purposes only and is not to scale. The position and size of doors, windows, appliances and other features are approximate.

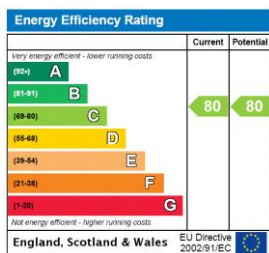

Tooting | 020 8767 5221 | tooting@winkworth.co.uk



for every step...

winkworth.co.uk

Winkworth wishes to inform prospective buyers and tenants that these particulars are a guide and act as information only. All our details are given in good faith and believed to be correct at the time of printing but they don't form part of an offer or contract. No Winkworth employee has authority to make or give any representation or warranty in relation to this property. All fixtures and fittings, whether fitted or not are deemed removable by the vendor unless stated otherwise and room sizes are measured between internal wall surfaces, including furnishings.