



**BELITHA VILLAS, LONDON, N1**  
**£1,175,000 SHARE OF FREEHOLD**

## **A STUNNING TWO BEDROOM FLAT WITH PRIVATE GARDEN IN BARNSBURY**

Islington | 0207 354 2480 | [islington@winkworth.co.uk](mailto:islington@winkworth.co.uk)

**Winkworth**

[winkworth.co.uk](http://winkworth.co.uk)

See things differently

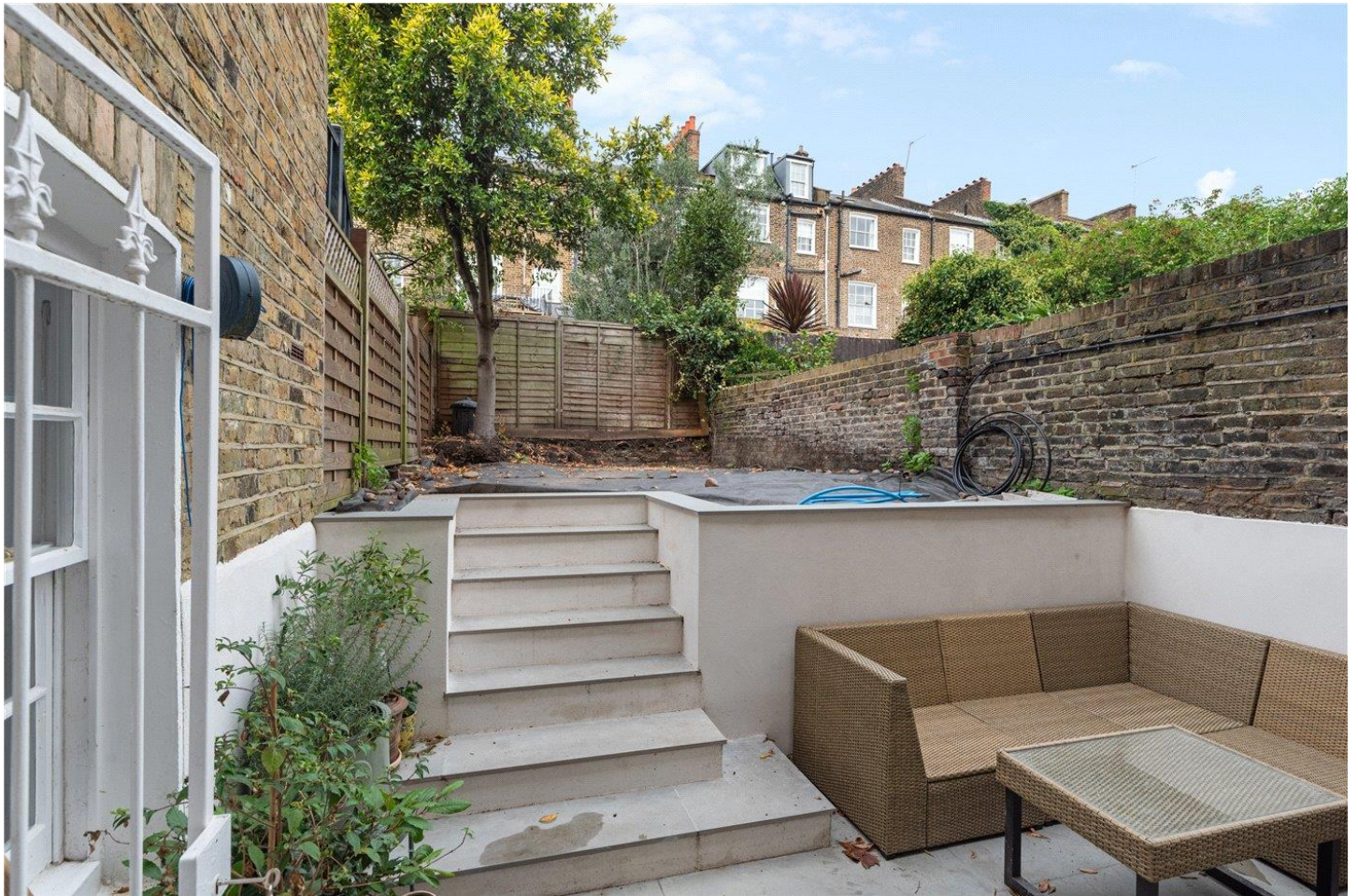

## DESCRIPTION:

Winkworth are delighted to present this beautiful two bedroom garden flat in the heart of Islington, N1. The property has been renovated to a very high standard and offers well-proportioned rooms throughout. Accommodation includes two double bedrooms to the rear of the property, alongside a luxurious family bathroom featuring a bathtub and marble tiles. The separate kitchen has integrated appliances and plentiful worktop space, while the south-facing reception room is flooded with natural light. The property is completed with a private garden, its own front door and is being sold with a share of the freehold.

Belitha Villas is ideally located for easy access to the City and the West End and is set moments from the many bars, restaurants and boutique shops on Upper Street. The closest transport links can be found at Highbury and Islington (Victoria Line) with Caledonian Road (Piccadilly Line) also within easy reach. Overground services are located at Caledonian and Barnsbury whilst international transport is facilitated from St Pancras.

\*Any associated charges including, but not limited to, service charge, ground rent and sinking funds

**Winkworth**



**Winkworth**

# Belitha Villas, N1

Approx. Gross Internal Floor Area 822 sq. ft / 76.41 sq. m

Key :  
CH - Ceiling Height

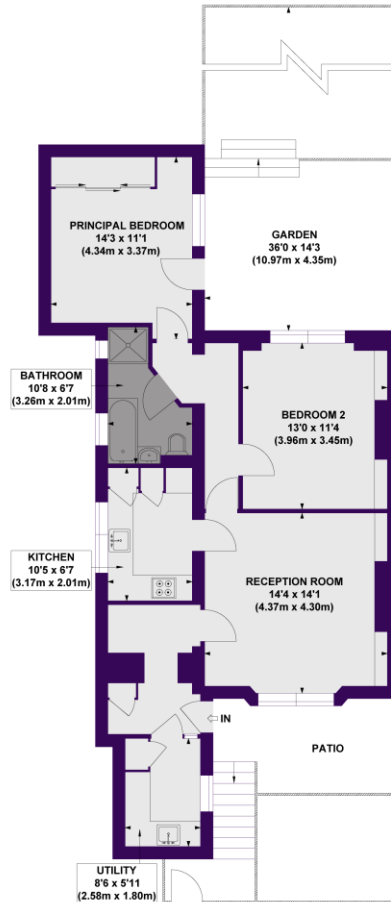

LOWER GROUND FLOOR  
GROSS INTERNAL  
FLOOR AREA 818 SQ FT

**Winkworth**

This floorplan is for illustration purposes only and is not to scale. The position and size of doors, windows, appliances and other features are approximate.

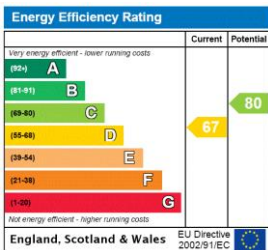

Islington | 0207 354 2480 | islington@winkworth.co.uk

**Winkworth**

winkworth.co.uk

See things differently

Winkworth wishes to inform prospective buyers and tenants that these particulars are a guide and act as information only. All our details are given in good faith and believed to be correct at the time of printing but they don't form part of an offer or contract. No Winkworth employee has authority to make or give any representation or warranty in relation to this property. All fixtures and fittings, whether fitted or not are deemed removable by the vendor unless stated otherwise and room sizes are measured between internal wall surfaces, including furnishings.