



Woodland Drove, Main Road, Twyford, Winchester, SO21 1EX

Winkworth

Woodland Drive, Main Road, Twyford, Winchester, SO21 1EX

Beautifully presented two-bedroom house

This beautifully presented and attractive two-bedroom house is in a lovely position surrounded by fields in the village of Twyford.

The entrance porch of the property opens into the cosy sitting room which has an attractive wood burner as a centrepiece. This room is open-plan to the dining area where the smart, modern kitchen has ample floor and eye-level units together with a useful breakfast bar. Fitted appliances including fridge, washing machine and oven. There is space for a dining table to one side and double doors provide access out to the conservatory - a lovely space for relaxing and enjoying the summer months. A further set of double doors open out to the garden.

Stairs rise to the first floor where there are two bright double bedrooms. Bedroom one enjoys an en-suite shower room and an attractive bay style window. A contemporary bathroom is also located on this floor.

Outside to the rear of the property, the private garden is mostly laid to lawn and there is a patio area for seating to one side. Shrubs line the borders and a door provided access into the garage. To the front of the property a large gravel driveway provides plenty of parking leading to the garage. A neatly kept hedge divides the property from the neighbour and a wall to the other side has been created as a planter for flowers and shrubs.





Woodland Drive, Main Road, Twyford, Winchester, SO21 1EX

Directions

Head south on Southgate Street towards St Thomas' Passage. Continue to follow B3335. At the roundabout, take the first exit onto Hockley Link. At the roundabout, take the first exit and stay on Hockley Link. Turn right onto B3335. Continue onto B3354. Turn left onto Woodland Drive.

Location

Twyford is a village located approximately three miles south of Winchester city centre with its high street shops, boutiques, library, coffee shops, public houses, restaurants, theatre, cinema, museums and, of course, the city's historic cathedral. Local amenities in Twyford include a village school, St. Mary's Primary School, St Mary's Church, a doctor's surgery and pharmacy, a grocer's shop and Post Office.

COUNCIL TAX: Band D, Winchester City Council.
SERVICES: Mains Gas, Electricity, Water & Drainage.
BROADBAND: Superfast Broadband Available. FTTC (Fibre to the Cabinet). Checked on Openreach March 2025.
MOBILE SIGNAL: Coverage With Certain Providers.
HEATING: Mains Gas Central Heating.
TENURE: Freehold.
EPC RATING: C
PARKING: Off street parking on driveway.

Viewings

Strictly by appointment with Winkworth Winchester Office

Winkworth.co.uk/winchester

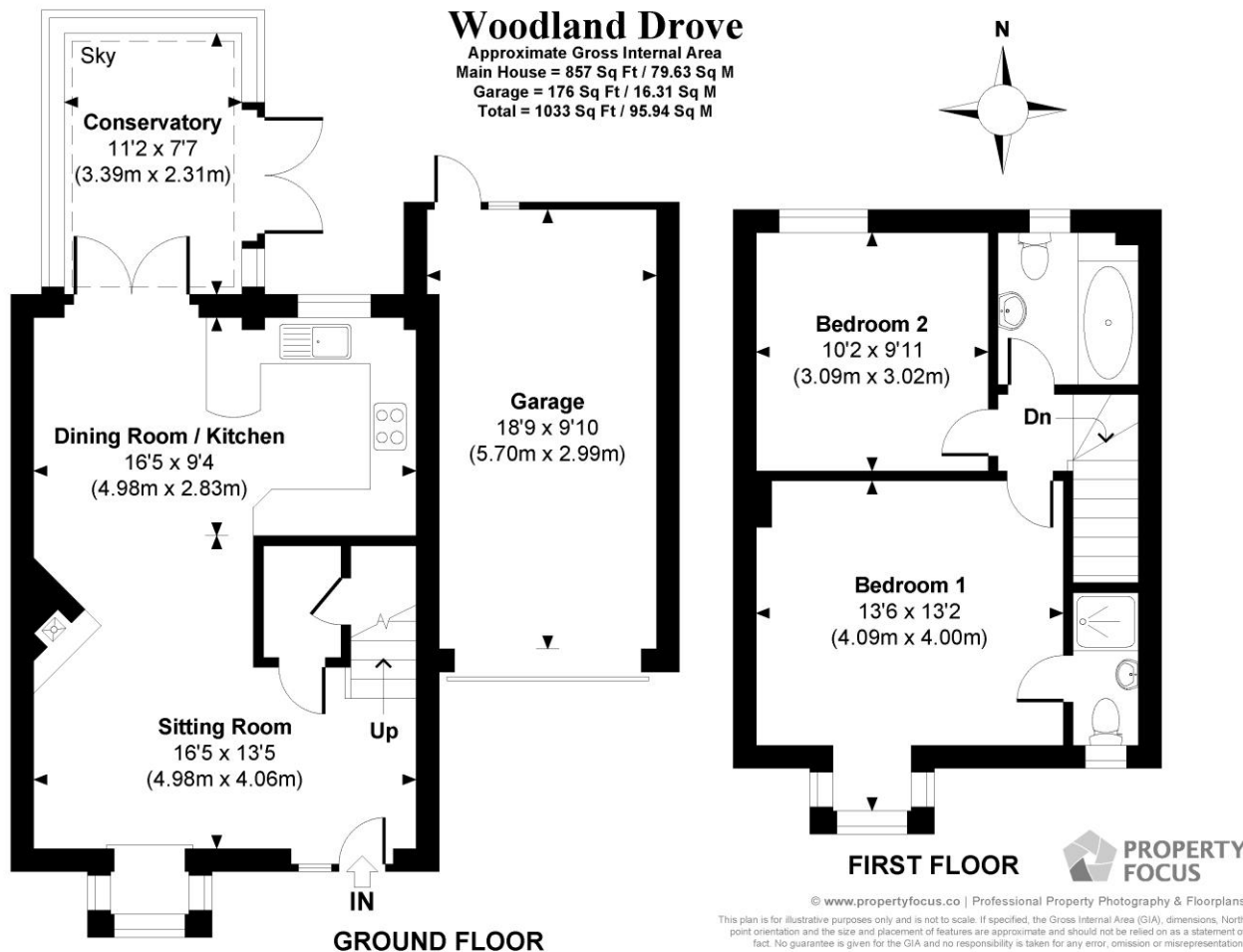

Winkworth Winchester

72 High Street, Winchester, SO23 9DA
01962 866 777 | winchester@winkworth.co.uk

Winkworth Country House Department

13 Charles II Street, St James's, London, SW1Y 4QU
020 7870 4878 | countryhouse@winkworth.co.uk

Winkworth

See things differently