



GREENWICH CHURCH STREET, LONDON, SE10
£2,500 PER MONTH PART FURNISHED

DESCRIPTION:

A stunning and large two bedroom, two bathroom 2nd floor apartment which is perfectly located within the heart of Greenwich town centre. Offered part-furnished and available from 7th April 2025, your earliest viewing is recommended.

Blackheath | 0208 8520999 | blackheath@winkworth.co.uk

Second Floor

Approx. 64.6 sq. metres (695.4 sq. feet)

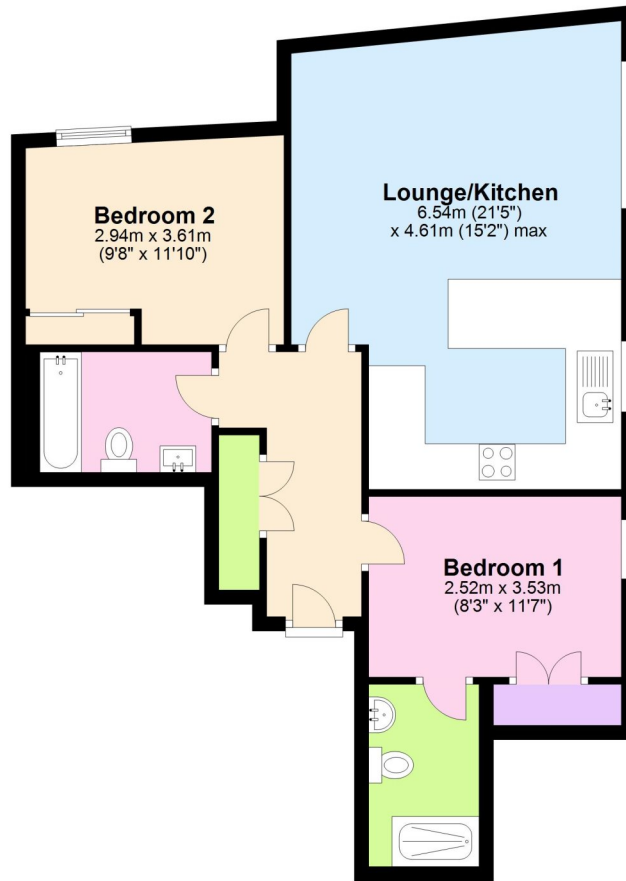

Total area: approx. 64.6 sq. metres (695.4 sq. feet)

This floorplan is for illustration purposes only and is not to scale. The position and size of doors, windows, appliances and other features are approximate.

Energy Efficiency Rating		Current	Potential
Very energy efficient - lower running costs			
(92+)	A		
(81-91)	B	84	84
(69-80)	C		
(55-68)	D		
(39-54)	E		
(21-38)	F		
(1-20)	G		
Not energy efficient - higher running costs			
England, Scotland & Wales		EU Directive 2002/91/EC	

Deposit: £2,884.62

Holding Deposit:

Council Tax Band:

Where no figures are shown, we have been unable to ascertain the information. All figures that are shown were correct at the time of printing.