



Lime Grove, Shepherd's Bush, W12

£700,000 Leasehold

A spacious two bedroom split level flat with private garden, on the ground floor of a red brick mid-terrace Victorian house.

Reception Room | Kitchen | 2 Bedrooms | Bathroom | Utility Room | Conservatory | Garden | 986 Sq Ft / 92 Sq M | Council Tax Band E | EPC Rating Band E

Winkworth



LOCATION

Lime Grove is an attractive residential street which runs between Goldhawk Road and Uxbridge Road. Moments from Shepherd's Bush Green, Westfield London shopping centre, an abundance of independent shops, restaurants and an internationally famous music venue, as well as outstanding transport links. Shepherd's Bush Market Underground station is within 2-3 minutes' walk, with Shepherd's Bush also within easy reach, offering both Central line and London Overground services.

DESCRIPTION

The property is offered in good condition throughout with accommodation comprising entrance hall, reception room with numerous period features, two bedrooms, kitchen, bathroom, utility room and conservatory. The property further benefits from a private garden.





LOCAL AUTHORITY
Hammersmith & Fulham

TENURE
Leasehold.

PRICE: £700,000 Leasehold

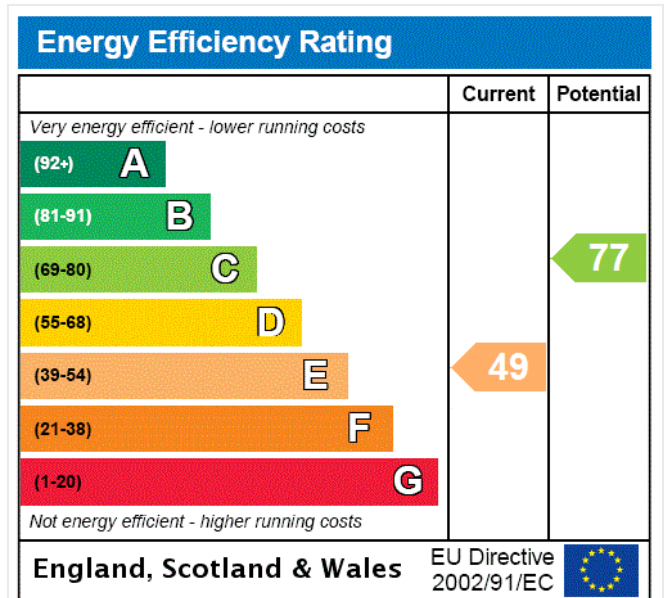

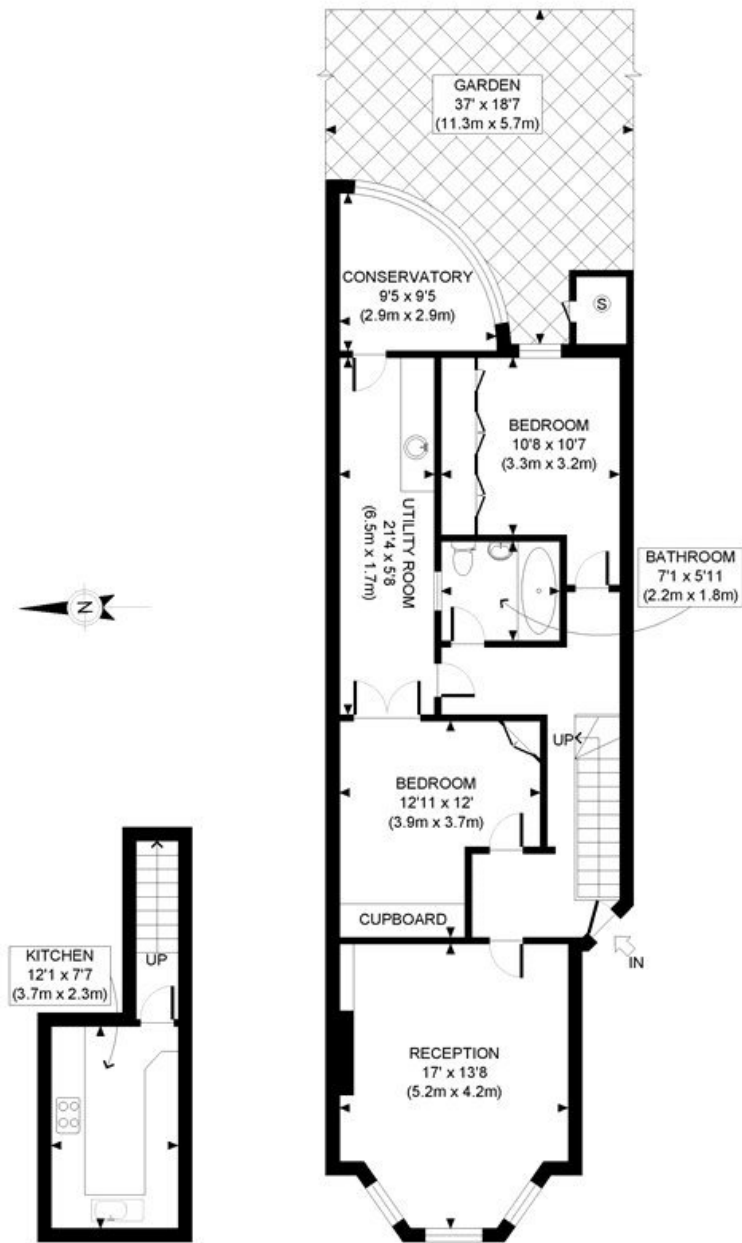

LOWER GROUND FLOOR
GROSS INTERNAL
FLOOR AREA 119 SQ FT

GROUND FLOOR
GROSS INTERNAL
FLOOR AREA 867 SQ FT

APPROX. GROSS INTERNAL FLOOR AREA: 986 SQ FT/ 92 SQM

Winkworth

This plan is for illustrative purposes only and should be used as such by any prospective client. Whilst every attempt has been made to ensure the accuracy of the Floor Plan contained here, measurements of the doors, windows, rooms and any other items are approximate and no responsibility is taken for any errors, omissions, or misstatement. The services, systems and appliances shown have not been tested and no guarantee as to the operability or efficiency can be given.

PROPERTY PHOTO PLANS
THE UK'S LEADING IN PROPERTY PHOTOGRAPHERS

The displayed square footage is taken from the floor plans with measurements created using the Royal Institute of Chartered Surveyors' Code of Practice for Measuring. These measurements are approximate and included for illustrative purposes only. Winkworth does not make any representation as to the accuracy of these measurements and you should seek to verify them for yourself. Winkworth accept no liability for any loss you may suffer if you rely on these measurements.

Shepherds Bush | 020 8735 3266 | shepherdsbush@winkworth.co.uk

Winkworth

for every step...

Under the Property Misdescriptions Act 1991, these Particulars are a guide and act as information only. All details are given in good faith and are believed to be correct at time of printing. Winkworth give no representation as to their accuracy and potential purchasers or tenants must satisfy themselves by inspection or otherwise as to their correctness. No employee of Winkworth has authority to make or give any representation or warranty in relation to this property.