



WOODSIDE AVENUE, LONDON, N12
£465,000 SHARE OF FREEHOLD

A WELL-PRESENTED, TWO BEDROOM, GROUND FLOOR MAISONETTE

Finchley | 020 8349 3388 | finchley@winkworth.co.uk

Winkworth

for every step...

winkworth.co.uk



DESCRIPTION:

We are pleased to offer this well-presented, two bedroom, ground floor maisonette, set in a quiet residential turning within a stones throw of Woodside Park underground station and North Finchley amenities. The property comprises of a spacious reception room, modern fully fitted kitchen, two double bedrooms, modern bathroom and ample storage throughout. Further benefits include a long lease, share of freehold, garage and residents parking. Double glazed throughout. Offered on a chain free basis.

AT A GLANCE

- GROUND FLOOR
- SPACIOUS RECEPTION ROOM
- TWO DOUBLE BEDROOMS
- MODERN FITTED KITCHEN & BATHROOM
- PARKING & GARAGE
- IDEAL LOCATION FOR TRANSPORT & AMENITIES
- SHARE OF FREEHOLD & LONG LEASE
- OFFERED CHAIN FREE
- DOUBLE GLAZED THROUGHOUT





Winkworth



Winkworth



Winkworth



Winkworth



Winkworth

Claire Court, Woodside Avenue, N12
 Approx. Gross Internal Floor Area 791 sq. ft / 73.46 sq. m

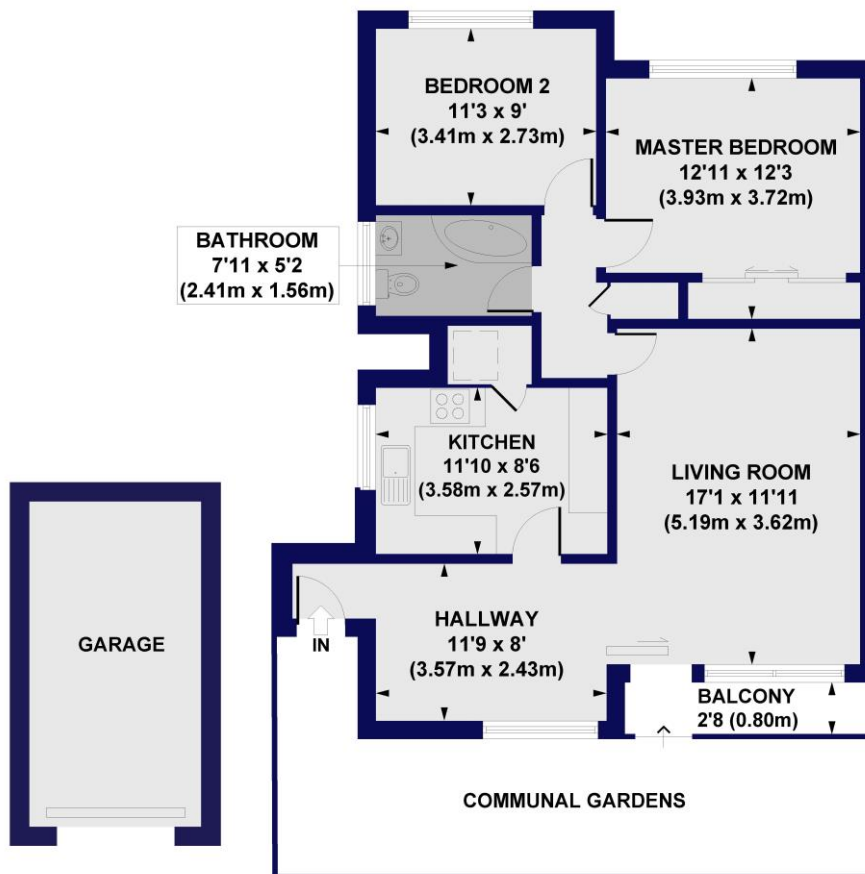

GROUND FLOOR

All measurements of walls, doors, windows, fittings and appliances, including their size and location, are shown as standard sizes and do not constitute any warranty or representation by the seller, their agent or CP Creative. Any intending purchaser must satisfy himself by inspection or otherwise as to the correctness of the information contained in these plans. This plan is for illustrative purposes only and should be used as such by any prospective purchasers.

Winkworth

This floorplan is for illustration purposes only and is not to scale. The position and size of doors, windows, appliances and other features are approximate.

Score	Energy rating	Current	Potential
92+	A		
81-91	B		
69-80	C		
55-68	D	66 D	75 C
39-54	E		
21-38	F		
1-20	G		

Tenure: Share of Freehold
Service Charge: £675 per
Ground Rent: £ Peppercorn
Council Tax Band: C

Where no figures are shown, we have been unable to ascertain the information. All figures that are shown were correct at the time of printing.

Winkworth

Finchley | 020 8349 3388 | finchley@winkworth.co.uk

for every step...

winkworth.co.uk

Winkworth wishes to inform prospective buyers and tenants that these particulars are a guide and act as information only. All our details are given in good faith and believed to be correct at the time of printing but they don't form part of an offer or contract. No Winkworth employee has authority to make or give any representation or warranty in relation to this property. All fixtures and fittings, whether fitted or not are deemed removable by the vendor unless stated otherwise and room sizes are measured between internal wall surfaces, including furnishings.