



PYRLAND ROAD, NEWINGTON GREEN, N5
£400 PER WEEK FURNISHED

THIS WONDERFUL 1.5 BEDROOM FIRST FLOOR APARTMENT IS SET IN A CHARMING PERIOD TERRACE IN THE HEART OF CANONBURY

Islington | 0207 354 2480 | islington@winkworth.co.uk

Winkworth

Tenant Fees Apply: Details of fees for tenant referencing, tenancy agreement admin fees and renewal fees are available on the Winkworth website and the link can be found with the displayed rent for the property. Tenants should ensure they are fully conversant with these upfront fees and other costs that are involved at the outset of the tenancy before making an offer to rent and your local Winkworth office will provide written details upon request.

winkworth.co.uk

See things differently



DESCRIPTION:

This wonderful 1.5 bedroom first floor apartment is set in a charming period terrace in the heart of Canonbury and boasts period features and a smart interior. The property also boasts a large study room and comprises of a bright and airy reception room, spacious double bedroom, a well furnished kitchen that includes a dishwasher and a stylish bathroom. It comes fully furnished and is suitable for a single or couple. There are a number of transport links close by including Canonbury Overground Station, Highbury & Islington tube station and bus links into both Central London and The City. There are several bus routes one minute walk on Newington Green Road taking you to Angel station, Central London, Finsbury Park, London Bridge.

Winkworth



Winkworth

Pyrland Road, N5

Approx. Gross Internal Area 540 sq. ft / 50.13 sq. m

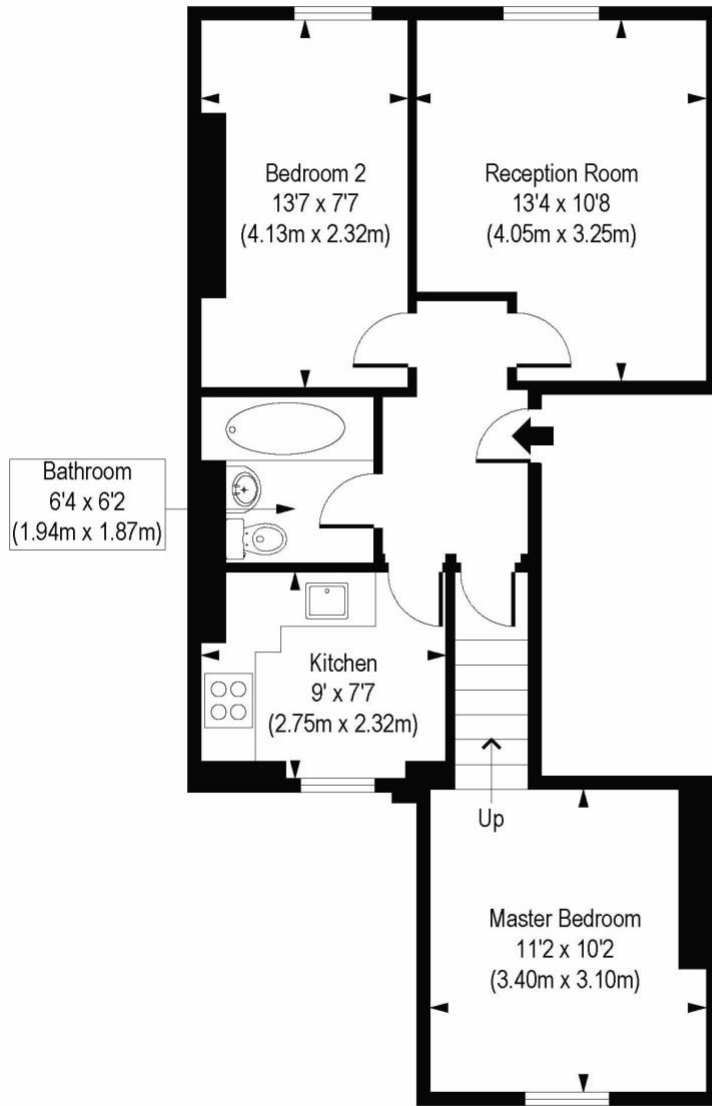

First Floor

COMPLIANT WITH RICS CODE OF MEASURING PRACTICE. Floorplan is for illustrative purposes only and is not to scale. Every attempt has been made to ensure the accuracy of the floorplan shown, however all measurements, fixtures, fittings and data shown are an approximate interpretation for illustrative purposes only. Liability for errors, omissions or mis-statement through negligence or otherwise is hereby excluded.

This floorplan is for illustration purposes only and is not to scale. The position and size of doors, windows, appliances and other features are approximate.

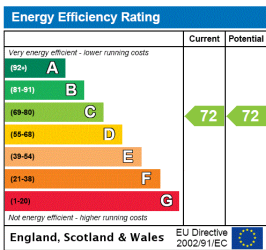

Islington | 0207 354 2480 | islington@winkworth.co.uk



winkworth.co.uk

See things differently

Winkworth wishes to inform prospective buyers and tenants that these particulars are a guide and act as information only. All our details are given in good faith and believed to be correct at the time of printing but they don't form part of an offer or contract. No Winkworth employee has authority to make or give any representation or warranty in relation to this property. All fixtures and fittings, whether fitted or not are deemed removable by the vendor unless stated otherwise and room sizes are measured between internal wall surfaces, including furnishings.