



WINTERFOLD CLOSE, SW19

**£2,250 PER MONTH FURNISHED, PART FURNISHED, UNFURNISHED**

**A bright and well presented three bedroom flat with a sunny south west facing balcony between Southfields and Wimbledon**

Southfields | 020 8877 1000 | southfields@winkworth.co.uk

**Winkworth**

for every step...

*winkworth.co.uk*





### **DESCRIPTION:**

This light and airy three bedroom flat is situated on the first floor and comprises of three bedrooms, a bathroom, separate w/c, eat-in kitchen, and reception room. Accessed from both the kitchen and reception room is a sunny south west facing balcony with beautiful views.

Winterfold Close is situated in the very sought-after area of Southfields, within walking distance to the green spaces of both Wimbledon Park and Wimbledon Common. Ideally positioned for easy access to Southfields Village and Southfields Underground Station (District Line).

### **ACCOMMODATION**

Long Let, 3 Bedrooms, 1 Reception Room, 1 Bathroom, Flat/Apartment, First Floor, Balcony, Residents Parking, Town/City, Furnished, Part Furnished, Unfurnished, 820 Approx Sq Ft







Winterfold Close, SW19  
Approx. Gross Internal Floor Area 820 sq. ft / 76.18 sq. m

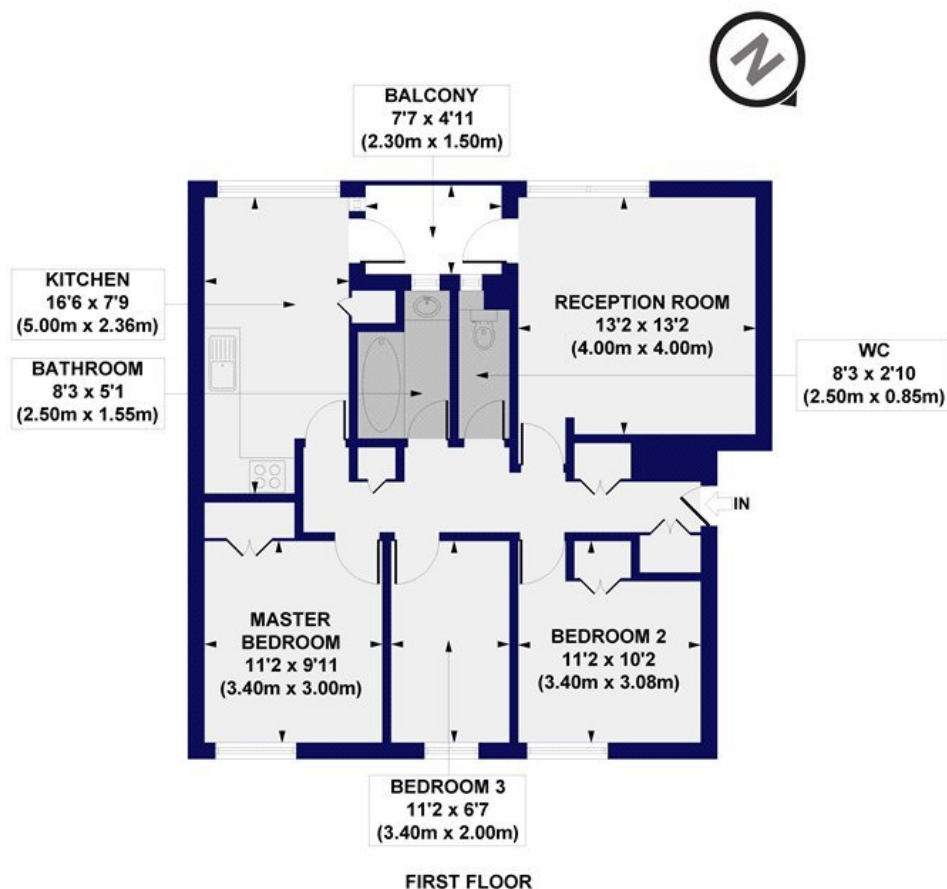

All measurements of walls, doors, windows, fittings and appliances, including their size and location, are shown as standard sizes and do not constitute any warranty or representation by the seller, their agent or CP Creative. Any intending purchaser must satisfy himself by inspection or otherwise as to the correctness of the information contained in these plans. This plan is for illustrative purposes only and should be used as such by any prospective purchasers.

**Winkworth**

This floorplan is for illustration purposes only and is not to scale. The position and size of doors, windows, appliances and other features are approximate.

**Deposit:** 5 weeks' rent

**Holding Deposit:** 1 week's rent

**Council Tax Band:** TBC

Where no figures are shown, we have been unable to ascertain the information. All figures that are shown were correct at the time of printing.

Southfields | 020 8877 1000 | southfields@winkworth.co.uk

**Winkworth**

for every step...

winkworth.co.uk

Winkworth wishes to inform prospective buyers and tenants that these particulars are a guide and act as information only. All our details are given in good faith and believed to be correct at the time of printing but they don't form part of an offer or contract. No Winkworth employee has authority to make or give any representation or warranty in relation to this property. All fixtures and fittings, whether fitted or not are deemed removable by the vendor unless stated otherwise and room sizes are measured between internal wall surfaces, including furnishings.