



ARIEL HOUSE, VAUGHAN WAY, LONDON, E1W
£675 PER WEEK FURNISHED

AN OUTSTANDING APARTMENT IN THE HIGHLY SOUGHT AFTER LONDON DOCK DEVELOPMENT

Shoreditch | 020 7749 7650 | shoreditch@winkworth.co.uk

Tenant Fees Apply: Details of fees for tenant referencing, tenancy agreement admin fees and renewal fees are available on the Winkworth website and the link can be found with the displayed rent for the property. Tenants should ensure they are fully conversant with these upfront fees and other costs that are involved at the outset of the tenancy before making an offer to rent and your local Winkworth office will provide written details upon request.

winkworth.co.uk

Winkworth

See things differently



DESCRIPTION:

Winkworth are delighted to offer this outstanding spacious apartment within the high end London Dock development and benefits from use of the residents facilities which includes: Residents private lounge, Gymnasium, Sauna, Swimming Pool, Virtual Golf, 24 hour concierge and more.

The property is located on the fourth floor and encompasses 800sq ft of space as well as a private balcony. It boasts two double bedrooms (with fitted wardrobe), ensuite shower room, fully tiled bathroom suite, spacious reception room leading to private balcony and fully fitted kitchen with Siemens appliances.

The whole property is finished to an impeccable standard, has air-conditioning and is offered furnished or unfurnished.

Ariel House is located in an excellent position at the North-West corner of Wapping close to Tower Hill and St Katherine's Dock. It has great amenities nearby such as Waitrose being just 1 minute away.

Winkworth



Winkworth

Ariel House, E1W

Approx. Gross Internal Floor Area 786 sq. ft / 73.03 sq. m

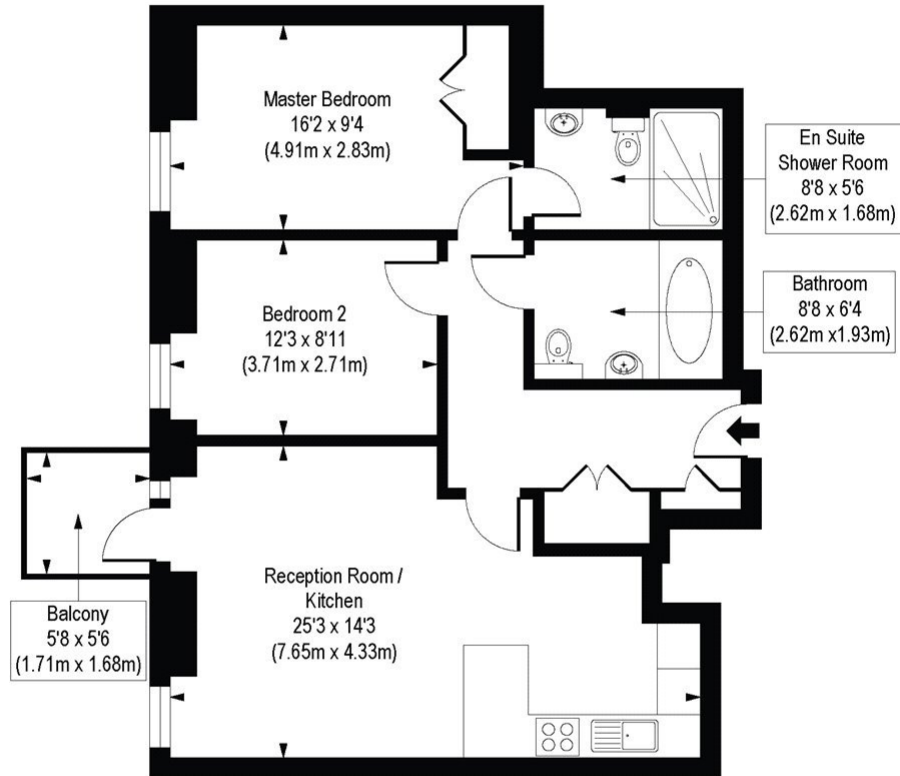

Fourth Floor

COMPLIANT WITH BCS CODE OF MEASURING PRACTICE. Floorplan is for illustrative purposes only and is not to scale. Every attempt has been made to ensure the accuracy of the floorplan shown, however all measurements, fixtures, fittings and data shown are an approximate interpretation for illustrative purposes only. Liability for errors, omissions or mis-statement through negligence or otherwise is hereby excluded.

This floorplan is for illustration purposes only and is not to scale. The position and size of doors, windows, appliances and other features are approximate.

Shoreditch | 020 7749 7650 | shoreditch@winkworth.co.uk

Winkworth

winkworth.co.uk

See things differently

Winkworth wishes to inform prospective buyers and tenants that these particulars are a guide and act as information only. All our details are given in good faith and believed to be correct at the time of printing but they don't form part of an offer or contract. No Winkworth employee has authority to make or give any representation or warranty in relation to this property. All fixtures and fittings, whether fitted or not are deemed removable by the vendor unless stated otherwise and room sizes are measured between internal wall surfaces, including furnishings.