



WILKINS CLOSE, CR4
£235,000 LEASEHOLD

A ONE BEDROOM PURPOSE BUILT FLAT.

Tooting | 020 8767 5221 | tooting@winkworth.co.uk

Winkworth

for every step...

winkworth.co.uk



DESCRIPTION:

This well-presented first-floor purpose-built flat offers excellent value for money. It includes a spacious double bedroom with built-in wardrobes, a bathroom, a reception room with a kitchen, and residents' parking. While the property is in good condition, it would benefit from some cosmetic updating.

Additional highlights include electric heating, and a designated parking space. Conveniently located to Colliers Wood (0.7 miles) and Tooting (1.6 miles) Railway Station, as well as local buses, shops, and amenities.

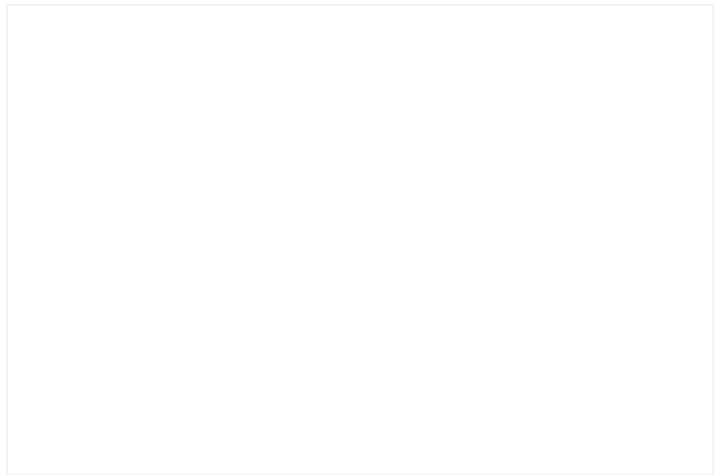

Heron Court, Wilkins Close, London, CR4

Approx. Gross Internal Floor Area 356 sq. ft / 33.06 sq. m

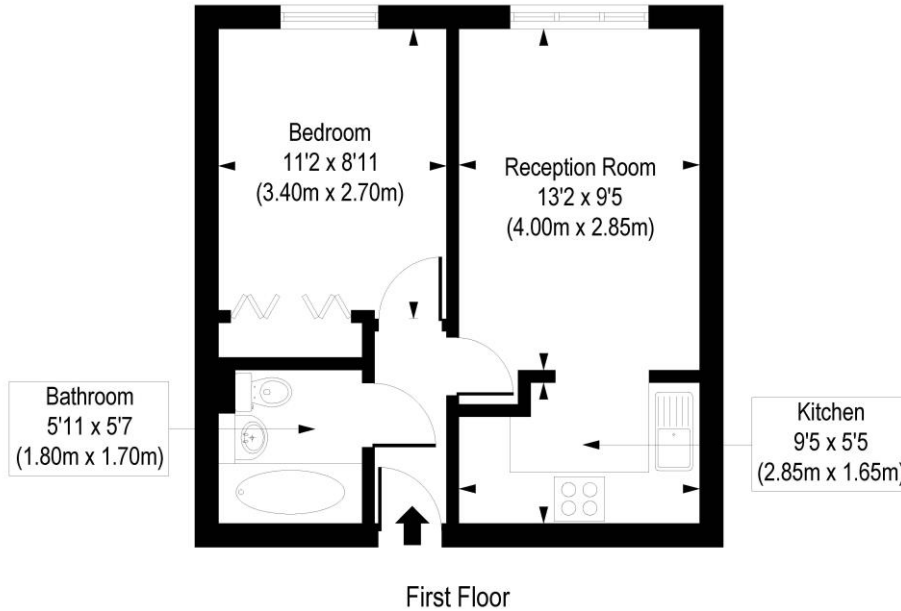
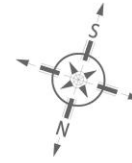

COMPLIANT WITH RICS CODE OF MEASURING PRACTICE. Floorplan is for illustrative purposes only and is not to scale. Every attempt has been made to ensure the accuracy of the floorplan shown, however all measurements, fixtures, fittings and data shown are an approximate interpretation for illustrative purposes only. Liability for errors, omissions or mis-statement through negligence or otherwise is hereby excluded.

This floorplan is for illustration purposes only and is not to scale. The position and size of doors, windows, appliances and other features are approximate.

Tenure: Leasehold

Term: 0 year and 0 months

Service Charge: £0 per annum

Ground Rent: £ 0 Annually (subject to increase)

Council Tax Band:

Where no figures are shown, we have been unable to ascertain the information. All figures that are shown were correct at the time of printing.

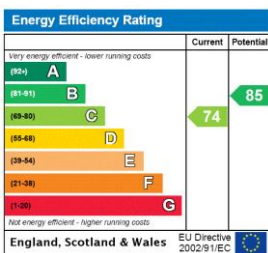

Tooting | 020 8767 5221 | tooting@winkworth.co.uk

Winkworth

for every step...

winkworth.co.uk

Winkworth wishes to inform prospective buyers and tenants that these particulars are a guide and act as information only. All our details are given in good faith and believed to be correct at the time of printing but they don't form part of an offer or contract. No Winkworth employee has authority to make or give any representation or warranty in relation to this property. All fixtures and fittings, whether fitted or not are deemed removable by the vendor unless stated otherwise and room sizes are measured between internal wall surfaces, including furnishings.