



**SHOOTERS HILL ROAD, BLACKHEATH, LONDON, SE3  
£2,700 PER MONTH UNFURNISHED**

**DESCRIPTION:**

**\* SORRY BUT THIS PROPERTY IS NOT SUITABLE FOR SHARERS \***

An extremely spacious three-bedroom, two bathroom apartment found on the top floor of this impressive period house on the edge of the heath. Offered unfurnished and available from 7th March 2025.

**Blackheath | 0208 8520999 | [blackheath@winkworth.co.uk](mailto:blackheath@winkworth.co.uk)**

## Second Floor

Approx. 134.8 sq. metres (1451.4 sq. feet)

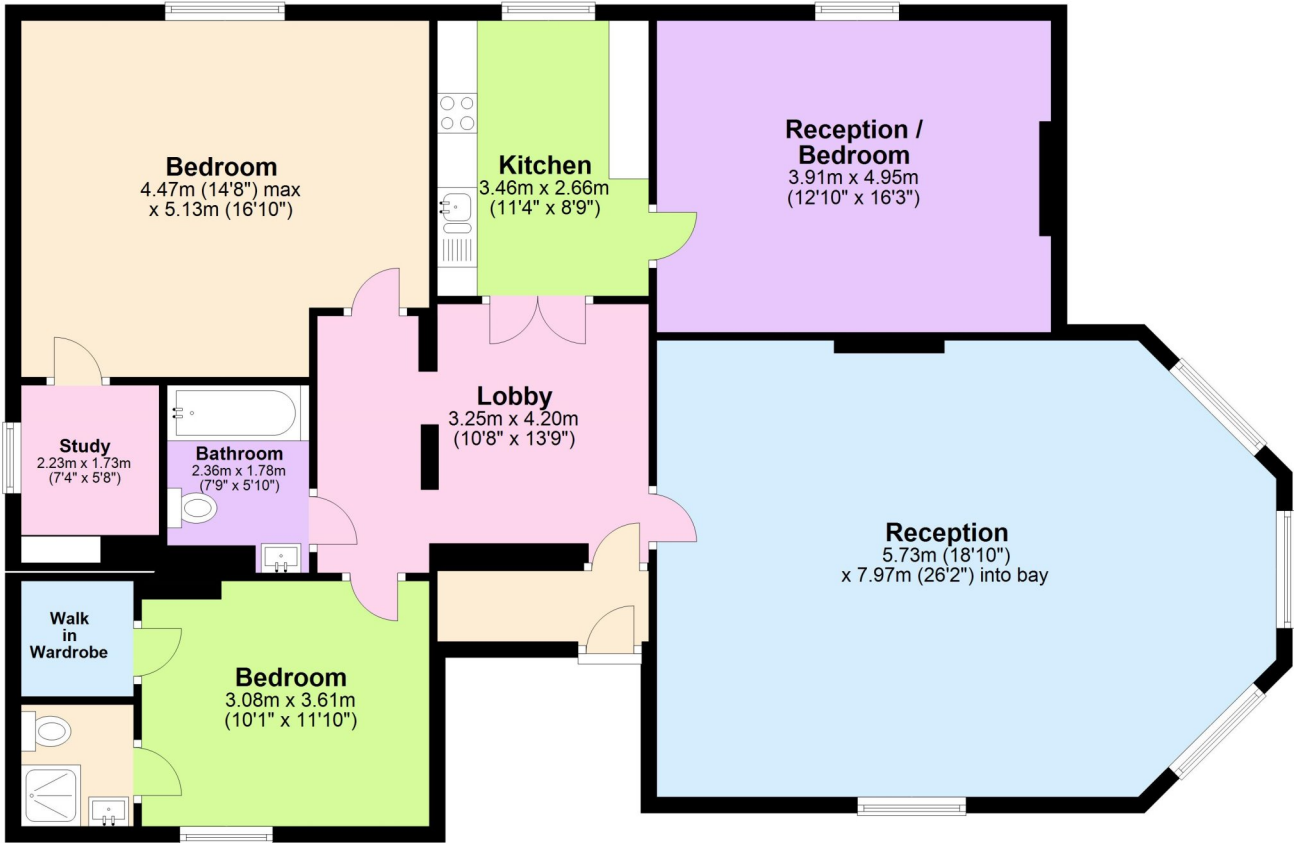

Total area: approx. 134.8 sq. metres (1451.4 sq. feet)

This floorplan is for illustration purposes only and is not to scale. The position and size of doors, windows, appliances and other features are approximate.

Energy Efficiency Rating		Current	Potential
Very energy efficient - lower running costs			
(92+)	A		
(81-91)	B		
(69-80)	C		80
(55-68)	D		
(39-54)	E	49	
(21-38)	F		
(1-20)	G		
Not energy efficient - higher running costs			
England, Scotland & Wales		EU Directive 2002/91/EC	

**Deposit:** £3,115.38

**Holding Deposit:**

**Council Tax Band:**

Where no figures are shown, we have been unable to ascertain the information. All figures that are shown were correct at the time of printing.