



GLENARM ROAD, LONDON, E5
£550,000 LEASEHOLD

A WELL-PROPORTIONED THREE-BEDROOM FLAT LOCATED ON THE FIRST FLOOR OF A POPULAR PURPOSE-BUILT BLOCK.

Hackney | 020 8986 4216 | hackney@winkworth.co.uk

Winkworth

winkworth.co.uk

See things differently



DESCRIPTION:

An incredibly well-proportioned three-bedroom flat located on the first floor of a popular purpose-built block, on the sought-after Glenarm Road.

Boasting three double bedrooms, each offering ample storage and plenty of natural light from large windows throughout. A spacious kitchen, flows seamlessly into the bright reception and dining area, creating a perfect space for both entertaining and relaxation. The bathroom features a shower over the bath, plus an additional separate WC for added convenience.

The reception opens out to a south-facing balcony, perfect for morning coffee. The property also benefits from a private south-facing garden, located separately on the ground floor, offering a tranquil outdoor space ideal for gardening or unwinding.

Conveniently located in the vibrant area of Lower Clapton, a short walk from Chatsworth Road, the property is close to local amenities, transport links and green spaces.

Winkworth



Winkworth

Glenarm Road, E5
Approx. Gross Internal Floor Area 880 sq. ft / 81.79 sq. m

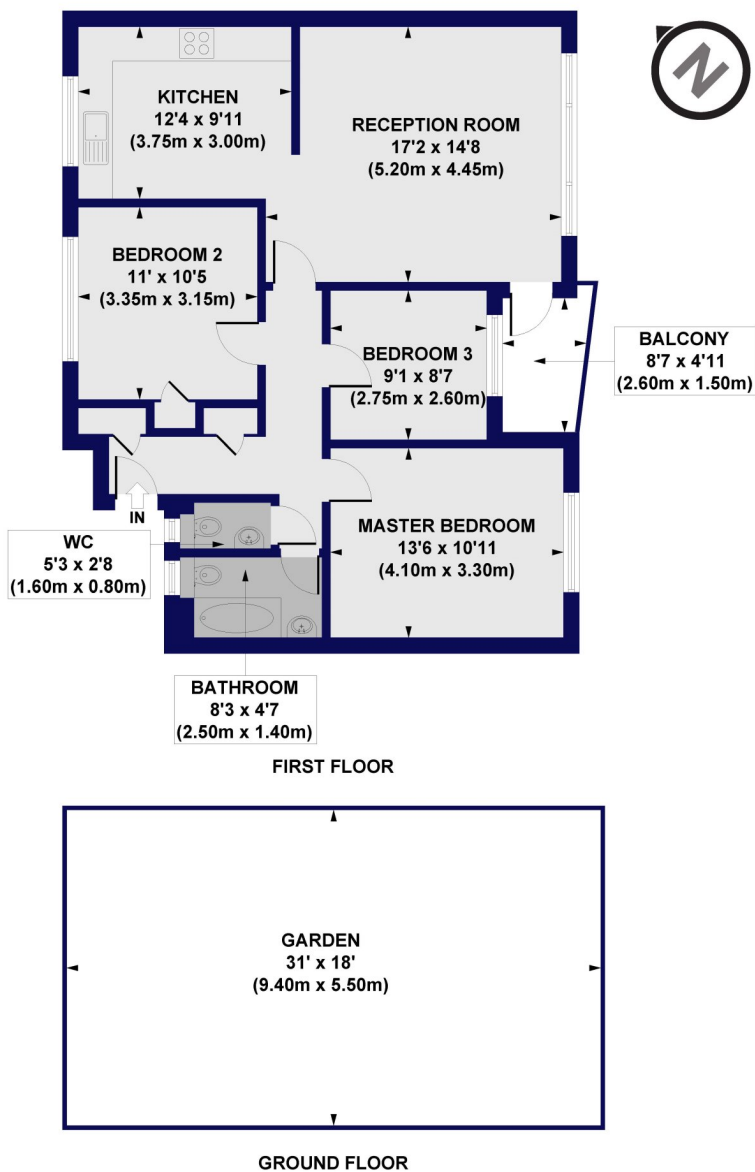

All measurements of walls, doors, windows, fittings and appliances, including their size and location, are shown as standard sizes and do not constitute any warranty or representation by the seller, their agent or CP Creative. Any intending purchaser must satisfy himself by inspection or otherwise as to the correctness of the information contained in these plans. This plan is for illustrative purposes only and should be used as such by any prospective purchasers.

Winkworth

This floorplan is for illustration purposes only and is not to scale. The position and size of doors, windows, appliances and other features are approximate.

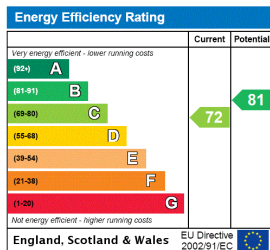

Hackney | 020 8986 4216 | hackney@winkworth.co.uk

Winkworth

winkworth.co.uk

See things differently

Winkworth wishes to inform prospective buyers and tenants that these particulars are a guide and act as information only. All our details are given in good faith and believed to be correct at the time of printing but they don't form part of an offer or contract. No Winkworth employee has authority to make or give any representation or warranty in relation to this property. All fixtures and fittings, whether fitted or not are deemed removable by the vendor unless stated otherwise and room sizes are measured between internal wall surfaces, including furnishings.