



SUTTON STREET, LONDON, E1
£720,000 FREEHOLD

A CHARMING TWO BEDROOM, FAMILY HOME STANDING IN CONVERSATION AREA

Shoreditch | 020 7749 7650 | shoreditch@winkworth.co.uk

Winkworth

winkworth.co.uk

See things differently



DESCRIPTION:

A spacious, bright, two- bedroom home with conservatory and West facing garden positioned in the Commercial Road Conservation Area.

Standing close to 900 sq. ft., this chain free property offers a wealth of character throughout. Accommodation comprises of a bright reception room on the ground floor with a sizeable kitchen, dining room and conservatory leading out to the easily maintainable private west-facing garden. The first floor occupies a spacious master bedroom which includes beautiful sash windows, secondary glazing, and wooden shutters, along with the second double bedroom and family bathroom with bathtub as well as walk-in shower. The property is complete with loft storage in the butterfly roof.

Located opposite St Mary & St Michael Catholic Primary School, the property is only 0.3 miles from Shadwell Overground & DLR station and stands enviably on the fringes of Limehouse and Wapping, E1. within close proximity to a number of parks such as King Edward Memorial Park, Mile End Park and Stepney Green Parks. Ideally located for easy access to Canary Wharf and The City via the Elizabeth Line, Overground and DLR.

Winkworth



Winkworth

Sutton Street, E1
Approx. Gross Internal Floor Area 869 sq. ft / 80.72 sq. m

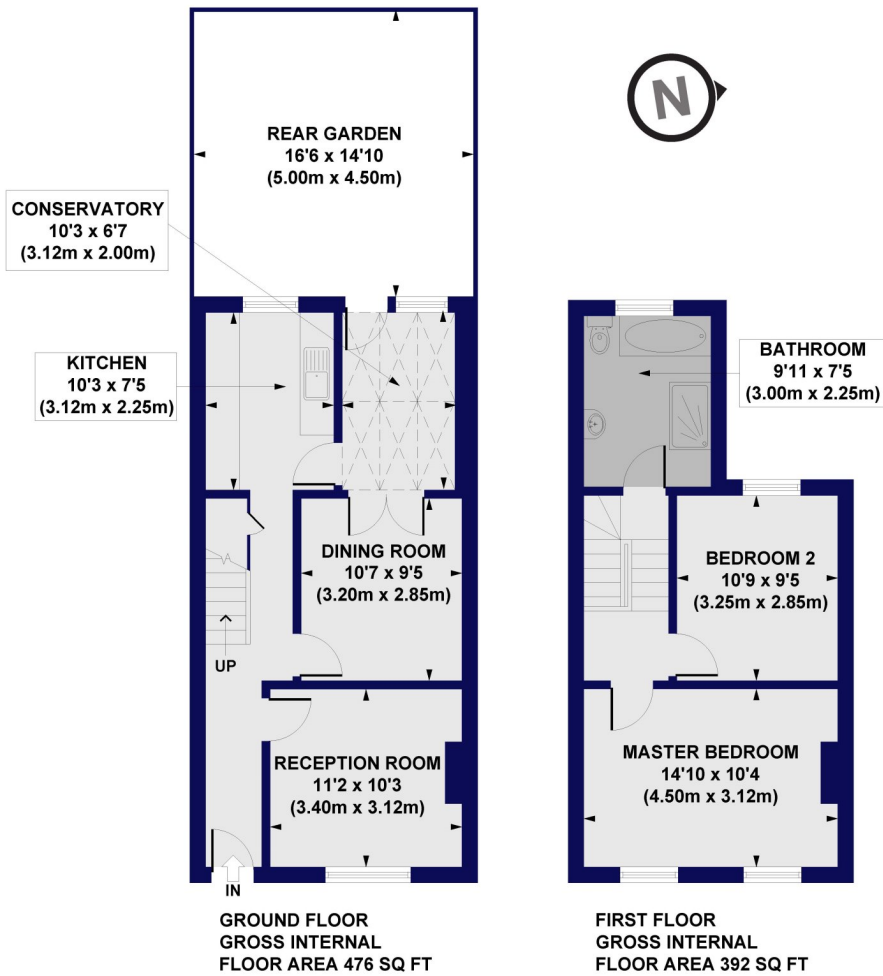

All measurements of walls, doors, windows, fittings and appliances, including their size and location, are shown as standard sizes and do not constitute any warranty or representation by the seller, their agent or CP Creative. Any intending purchaser must satisfy himself by inspection or otherwise as to the correctness of the information contained in these plans. This plan is for illustrative purposes only and should be used as such by any prospective purchasers.

Winkworth

This floorplan is for illustration purposes only and is not to scale. The position and size of doors, windows, appliances and other features are approximate.

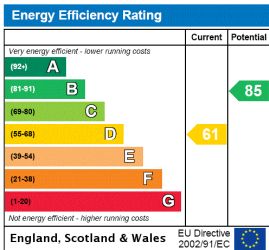

Shoreditch | 020 7749 7650 | shoreditch@winkworth.co.uk



winkworth.co.uk

See things differently

Winkworth wishes to inform prospective buyers and tenants that these particulars are a guide and act as information only. All our details are given in good faith and believed to be correct at the time of printing but they don't form part of an offer or contract. No Winkworth employee has authority to make or give any representation or warranty in relation to this property. All fixtures and fittings, whether fitted or not are deemed removable by the vendor unless stated otherwise and room sizes are measured between internal wall surfaces, including furnishings.