



**SISPARA GARDENS, SW18**  
**£6,500 PER MONTH UNFURNISHED**

**This exceptional seven double bedroom family home, set on a highly south-after road and spanning 4070 sq. ft, has been recently refurbished to exacting standards.**

Southfields | 020 8877 1000 | southfields@winkworth.co.uk

**Winkworth**

for every step...

*winkworth.co.uk*

## Sispara Gardens, SW18

Approx. Gross Internal Area 375.97 sq m / 4047 sq ft (Including Eaves Storage)  
 Approx. Gross Internal Area 363.39 sq m / 3804 sq ft (Excluding Eaves Storage)

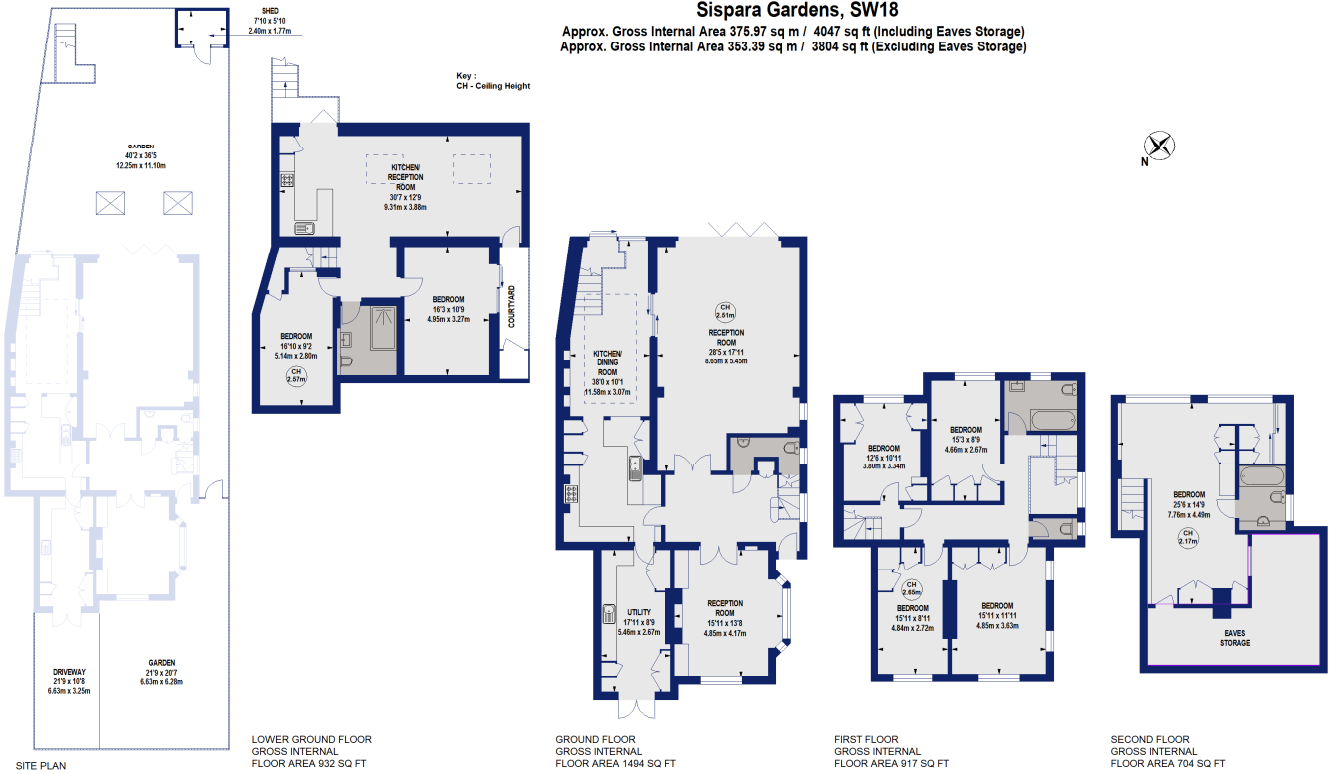

Not to scale, for guidance only and must not be relied upon as a statement of fact. All measurements and areas are approximate only.



This floorplan is for illustration purposes only and is not to scale. The position and size of doors, windows, appliances and other features are approximate.

**Deposit:** 6 week's rent

**Holding Deposit:** 1 weeks' rent

**Council Tax Band:** Wandsworth

Where no figures are shown, we have been unable to ascertain the information. All figures that are shown were correct at the time of printing.

Southfields | 020 8877 1000 | southfields@winkworth.co.uk



for every step...

winkworth.co.uk

Winkworth wishes to inform prospective buyers and tenants that these particulars are a guide and act as information only. All our details are given in good faith and believed to be correct at the time of printing but they don't form part of an offer or contract. No Winkworth employee has authority to make or give any representation or warranty in relation to this property. All fixtures and fittings, whether fitted or not are deemed removable by the vendor unless stated otherwise and room sizes are measured between internal wall surfaces, including furnishings.