



BASEVI WAY, DEPTFORD, LONDON, SE8
GUIDE PRICE £325,000 - £335,000 LEASEHOLD

A WONDERFUL ONE BEDROOM, GROUND FLOOR FLAT WHICH IS PART OF THE POPULAR MILLENNIUM QUAY RIVERSIDE DEVELOPMENT, WITHIN CLOSE WALKING DISTANCE TO CENTRAL GREENWICH

Greenwich | 02030533033 | greenwich@winkworth.co.uk

Winkworth

for every step...

winkworth.co.uk



DESCRIPTION:

A wonderful one bedroom, ground floor flat which is part of the popular Millenium Quay riverside development, within close walking distance to central Greenwich and Cutty Sark DLR. Offered in good decorative order, the accommodation comprises a fitted kitchen, separate reception room, a good sized double bedroom and a lovely modern shower room. Added features include double glazing and electric heating. There is residents parking to the front, along with a porters lodge at the developments entrance. Millennium Quay sits just slightly west of Greenwich town centre which gives it easy and quick access to a fine array of shops and restaurants, along with mainline rail, DLR and riverboat service. A large Waitrose and Costa coffee are also within a few minutes walk.

AT A GLANCE

- Millenium Quay development
- One bedroom apartment
- Modern shower room
- Separate Kitchen
- Porters Lodge
- Residents Parking
- Close to central Greenwich
- Close to transport links





Ground Floor

Approx. 37.1 sq. metres (399.6 sq. feet)

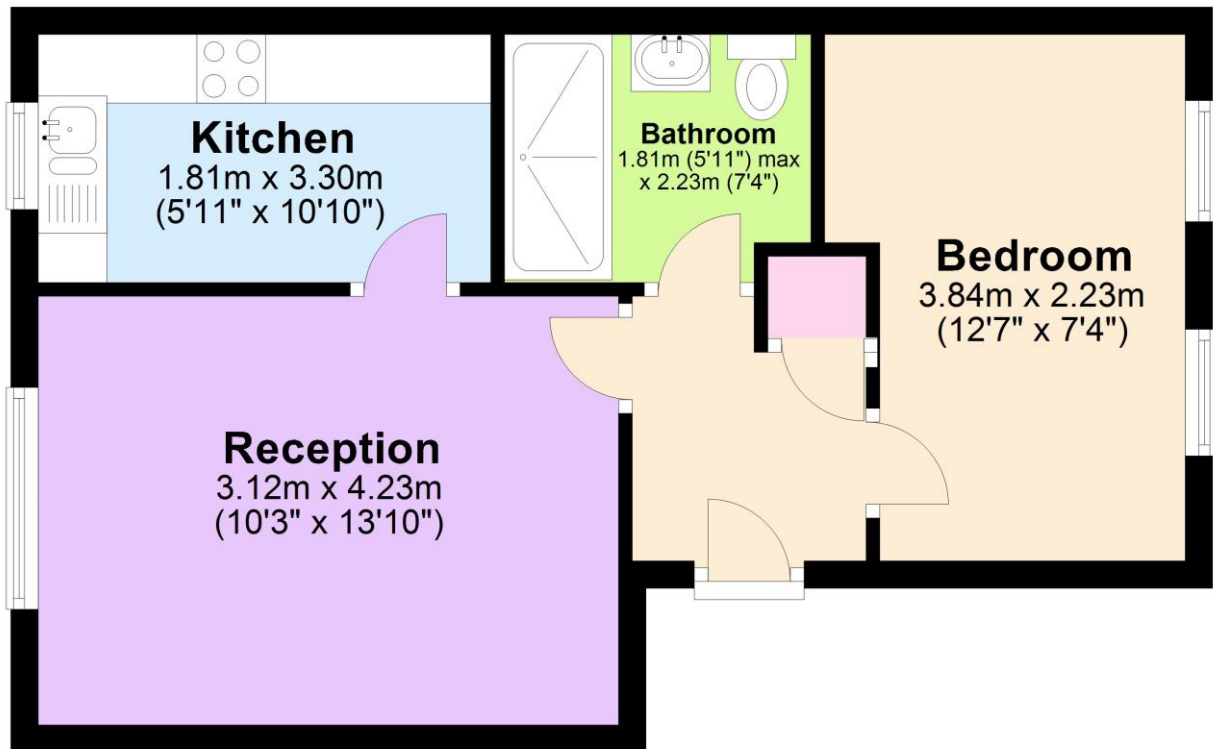

Total area: approx. 37.1 sq. metres (399.6 sq. feet)

This floorplan is for illustration purposes only and is not to scale. The position and size of doors, windows, appliances and other features are approximate.

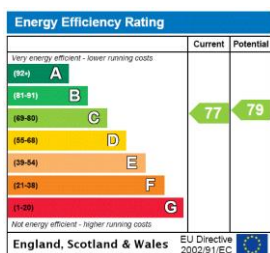

Tenure: Leasehold

Term: 162 year and 10 months

Service Charge: £1907 per annum

Ground Rent: £ 505 Annually (subject to increase)

Council Tax Band: C

Where no figures are shown, we have been unable to ascertain the information. All figures that are shown were correct at the time of printing.

Greenwich | 02030533033 | greenwich@winkworth.co.uk

Winkworth

for every step...

winkworth.co.uk

Winkworth wishes to inform prospective buyers and tenants that these particulars are a guide and act as information only. All our details are given in good faith and believed to be correct at the time of printing but they don't form part of an offer or contract. No Winkworth employee has authority to make or give any representation or warranty in relation to this property. All fixtures and fittings, whether fitted or not are deemed removable by the vendor unless stated otherwise and room sizes are measured between internal wall surfaces, including furnishings.