



FOUNTAIN ROAD, TOOTING, LONDON, SW17
£450,000 LEASEHOLD

A SPACIOUS THREE DOUBLE BEDROOM FIRST FLOOR FLAT.

Tooting | 020 8767 5221 | tooting@winkworth.co.uk

Winkworth

for every step...

winkworth.co.uk



DESCRIPTION:

A generously proportioned three-bedroom first-floor apartment boasting ample natural light and a charming balcony. This well-kept property features three spacious double bedrooms, a large reception room, a separate kitchen, a recently refurbished bathroom with a separate WC, and a cozy small balcony.

Residents can enjoy access to a communal courtyard, and the convenience of being only 0.6 miles away from Tooting Broadway tube station (Northern Line, Zone 3), with its abundance of shops, bars, and restaurants. Additionally, the flat is conveniently close to St. George's Hospital. Offered Chain Free, estate permit parking can be arranged through application to the council.



Anderson House, Fountain Road, SW17

Approx. Gross Internal Floor Area 805 sq. ft / 74.76 sq. m

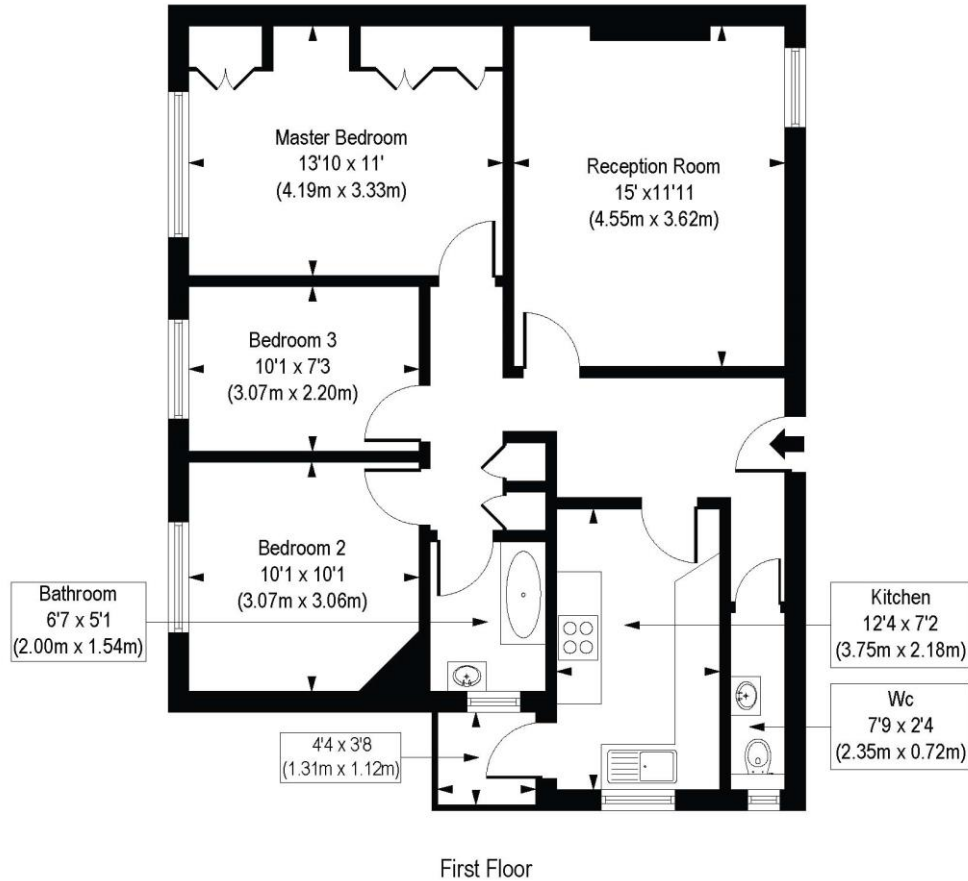

COMPLIANT WITH RICS CODE OF MEASURING PRACTICE. Floorplan is for illustrative purposes only and is not to scale. Every attempt has been made to ensure the accuracy of the floorplan shown, however all measurements, fixtures, fittings and data shown are an approximate interpretation for illustrative purposes only. Liability for errors, omissions or mis-statement through negligence or otherwise is hereby excluded.

This floorplan is for illustration purposes only and is not to scale. The position and size of doors, windows, appliances and other features are approximate.

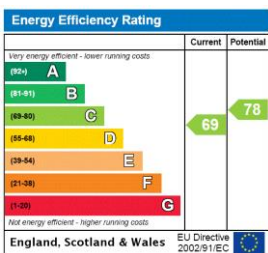

Tooting | 020 8767 5221 | tooting@winkworth.co.uk

for every step...

winkworth.co.uk

Winkworth wishes to inform prospective buyers and tenants that these particulars are a guide and act as information only. All our details are given in good faith and believed to be correct at the time of printing but they don't form part of an offer or contract. No Winkworth employee has authority to make or give any representation or warranty in relation to this property. All fixtures and fittings, whether fitted or not are deemed removable by the vendor unless stated otherwise and room sizes are measured between internal wall surfaces, including furnishings.