



VARTRY ROAD, LONDON, N15
£450,000 SHARE OF FREEHOLD

**ATTRACTIVE AND SPACIOUS RAISED GROUND
FLOOR ONE-BEDROOM CONVERSION WITH ACCESS
TO A PRIVATE GARDEN.**

Stoke Newington | 020 3869 9000 | stokenewington@winkworth.co.uk

Winkworth

winkworth.co.uk

See things differently



DESCRIPTION:

Tucked away down a highly coveted residential street, this attractive and spacious raised ground floor one-bedroom conversion with access to a private garden is truly a stand-out first time buy. Available Chain-Free, this larger than average apartment occupies 554 Sq. Ft / 51.45 Sq. m, retaining original character and providing a tasteful first home with neutral décor throughout.

Arranged over the entire raised ground floor and boasting well-proportioned rooms with high ceilings throughout, this Fantastic one-bedroom flat provides a functional and bright social space for a professional person or couple looking to settle their roots in Stamford Hill. The accommodation is flexible and includes a spacious living room measuring approx. 20ft x 12 ft with a separate modern kitchen, opening on to a stair well which takes you to your own private garden. Other accommodation includes – Large double bedroom with bespoke fitted wardrobes and spacious shower room.

Transportation options abound, with Stamford Hill train stations (Overground) a mere 7-minute walk away. Seven Sisters (Victoria Line) is just a 5-minute bus ride away, while South Tottenham (Overground), Manor House (Piccadilly Line), and Finsbury Park (Piccadilly & Victoria Lines and National Rail) are easily accessible by bus, offering routes to The City and West End.

For those commuting, Manor House station on the Piccadilly line is a quick 10-minute bus ride away, or a pleasant 15-minute walk along the New River, offering scenic views of the local wildlife. Stamford Hill Station is conveniently located within a 7-minute walk, providing a regular service into Liverpool Street, alongside numerous bus options. Stoke Newington Church St is also a comfortable 15-minute stroll away. Furthermore, the area boasts an array of accessible green spaces, including Woodberry Wetlands, Clissold Park, Springfield Park, Hackney Marshes, and Finsbury Park, catering to outdoor enthusiasts. Safe cycling routes into the City and the West End add to the area's connectivity and appeal.

Winkworth



Winkworth

Vartry Road, N15
Approx. Gross Internal Floor Area 554 sq. ft / 51.45 sq. m

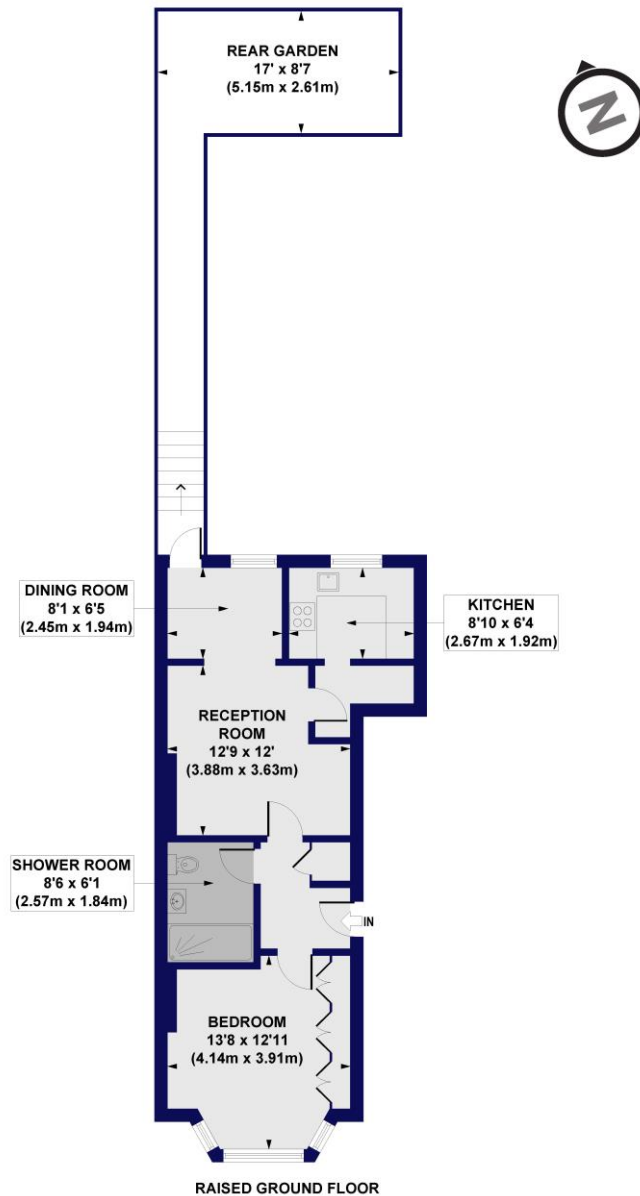

All measurements of walls, doors, windows, fittings and appliances, including their size and location, are shown as standard sizes and do not constitute any warranty or representation by the seller, their agent or CP Creative. Any intending purchaser must satisfy himself by inspection or otherwise as to the correctness of the information contained in these plans. This plan is for illustrative purposes only and should be used as such by any prospective purchasers.

Winkworth

This floorplan is for illustration purposes only and is not to scale. The position and size of doors, windows, appliances and other features are approximate.

Shoreditch | 020 7749 7650 | shoreditch@winkworth.co.uk

Winkworth

winkworth.co.uk

See things differently

Winkworth wishes to inform prospective buyers and tenants that these particulars are a guide and act as information only. All our details are given in good faith and believed to be correct at the time of printing but they don't form part of an offer or contract. No Winkworth employee has authority to make or give any representation or warranty in relation to this property. All fixtures and fittings, whether fitted or not are deemed removable by the vendor unless stated otherwise and room sizes are measured between internal wall surfaces, including furnishings.