



IVES STREET, SW3
£8,000 PER MONTH | £1,846 PER WEEK | UNFURNISHED

DESCRIPTION:

Located on a quiet residential street, this charming three bedroom, three bathroom house is within 10 minutes walking distance to both South Kensington and Sloane Square.

The property is finished to a very high standard from top to bottom with a tasteful mixture of dark wooden flooring and high quality marble. The house also offers air-conditioning throughout.

Knightsbridge & Chelsea | 0207 589 6616 | knightsbridge@winkworth.co.uk



for every step...

Ives Street, SW3

- Approximate Gross Internal Area
169.42 sq m / 1,824 sq ft
- Eaves Storage
5.16 sq m / 56 sq ft

Total Areas Including Eaves
174.60 sq m / 1,879 sq ft

(Including restricted height
under 1.5m [- - - -])
(CH = Ceiling Heights)

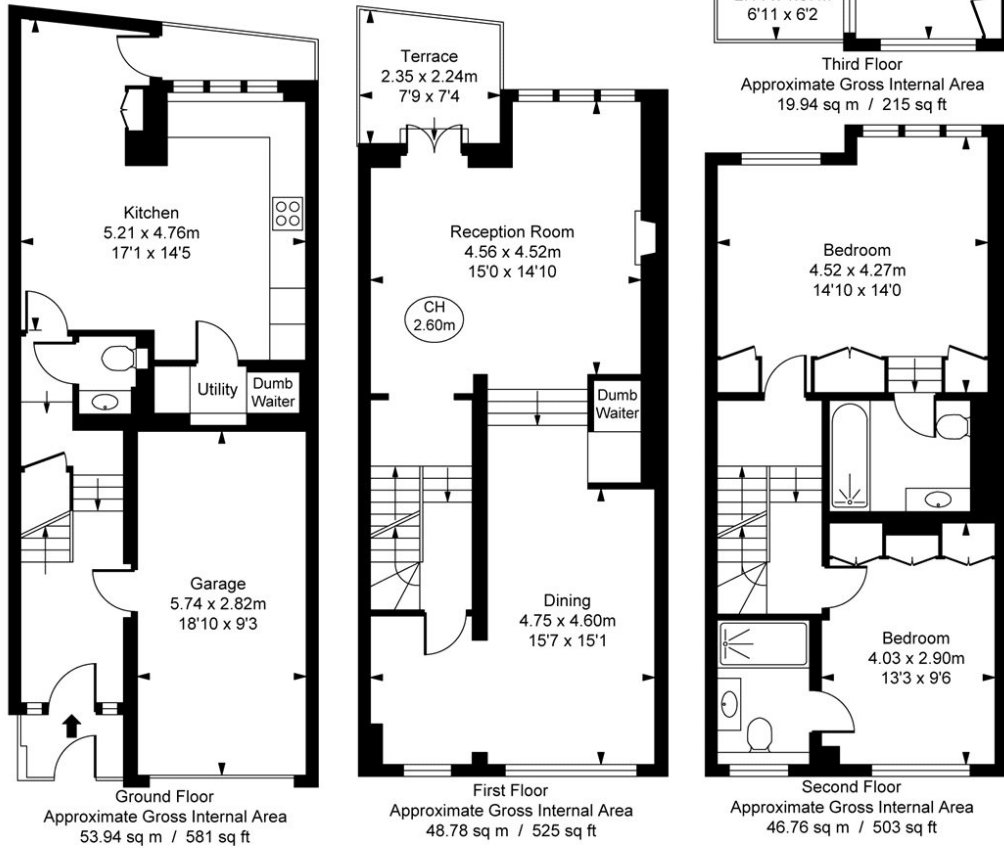

This plan is not to scale. It is for guidance and not for valuation purposes.
 All measurements and areas are approximate only, and have been prepared in accordance with the current edition of the RICS Code of Measuring Practice.
 © Fulham Performance

This floorplan is for illustration purposes only and is not to scale. The position and size of doors, windows, appliances and other features are approximate.

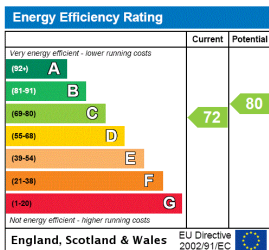

Deposit: £11,080

Holding Deposit: £1,846

Council Tax Band: H

Where no figures are shown, we have been unable to ascertain the information.
 All figures that are shown were correct at the time of printing.

Knightsbridge & Chelsea | 0207 589 6616 | knightsbridge@winkworth.co.uk



for every step...

winkworth.co.uk

Winkworth wishes to inform prospective buyers and tenants that these particulars are a guide and act as information only. All our details are given in good faith and believed to be correct at the time of printing but they don't form part of an offer or contract. No Winkworth employee has authority to make or give any representation or warranty in relation to this property. All fixtures and fittings, whether fitted or not are deemed removable by the vendor unless stated otherwise and room sizes are measured between internal wall surfaces, including furnishings.