



**KNEBORTH HOUSE, LONDESBOROUGH ROAD, LONDON, N16
OFFERS IN EXCESS OF £450,000**

**A WELL PRESENTED 697 SQ FT, TWO BEDROOM
CORNER FLAT WITH BALCONY, IN STOKE
NEWINGTON.**

Stoke Newington | | stokenewington@winkworth.co.uk



DESCRIPTION:

A lovely 697 sq. ft, two bedroom flat with balcony, set on the fourth floor of this well-kept block. The property comprises a generous sized living room with door out to a large balcony, recently renovated separate kitchen/diner, bathroom, separate WC and two large double bedrooms.

The property is set on Londesborough Road which is just a few minutes' walk from leafy Clissold Park and Church Street's array of restaurants, bars and independent shops. Convenient transport links are also nearby, with numerous buses to The West End and City, and trains from Stoke Newington BR to Liverpool Street every fifteen minutes.



Knebworth House, Londesborough Road, N16
Approx. Gross Internal Floor Area 697 sq. ft / 64.76 sq. m

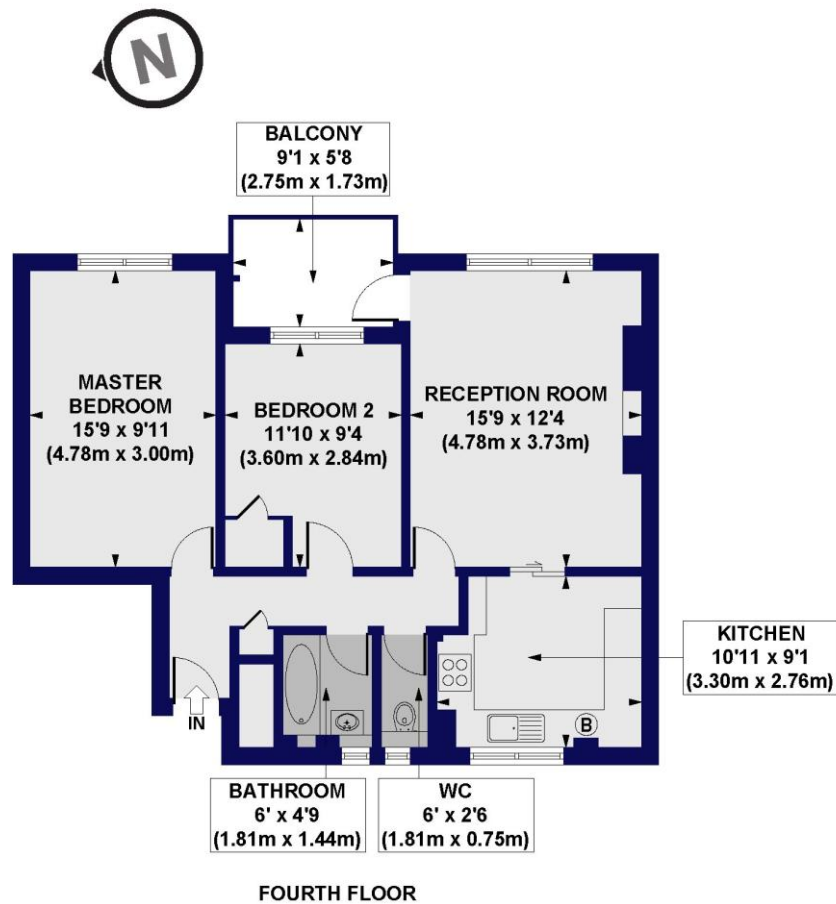

All measurements of walls, doors, windows, fittings and appliances, including their size and location, are shown as standard sizes and do not constitute any warranty or representation by the seller, their agent or CP Creative. Any intending purchaser must satisfy himself by inspection or otherwise as to the correctness of the information contained in these plans. This plan is for illustrative purposes only and should be used as such by any prospective purchasers.

Winkworth

This floorplan is for illustration purposes only and is not to scale. The position and size of doors, windows, appliances and other features are approximate.