



STURGESS AVENUE, LONDON, NW4
£975,000 FREEHOLD

STUNNING FOUR BEDROOM SEMI DETACHED RESIDENCE IN A SOUGHT AFTER LOCATION

Kingsbury | 020 8204 0000 | kingsbury@winkworth.co.uk

Winkworth

for every step...

winkworth.co.uk



This exquisite four-bedroom semi-detached house offers a perfect blend of luxury, and convenience making it the ideal home for families and professionals alike. Boasting four spacious bedrooms, each room is designed with style and comfort in mind, providing ample space for relaxation and rest. The reception rooms host perfect space for entertaining guests or enjoying family time, flooded with an abundance of warm natural light. Three modern bathrooms ensure ease for all family members. Hassle free off-street parking is a breath of fresh air, whilst the gorgeous rear garden provides a heavenly outdoor retreat. This property benefits from a prime location with excellent transport links, schools, and amenities. Don't miss out on this fantastic property – contact us today to arrange your personal insight.



Winkworth

for every step...

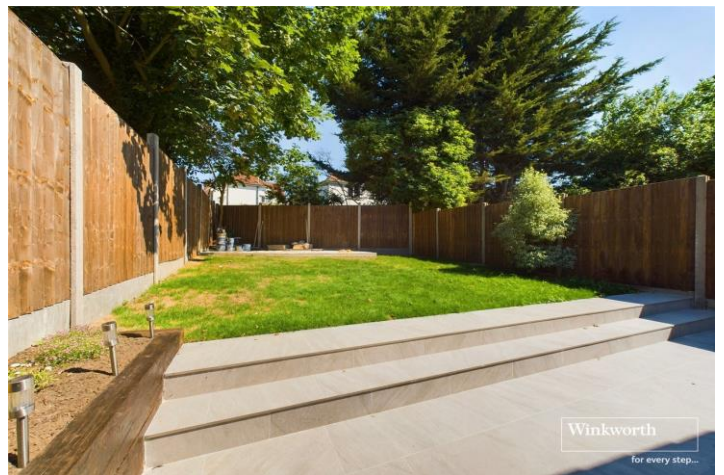

Winkworth

for every step...

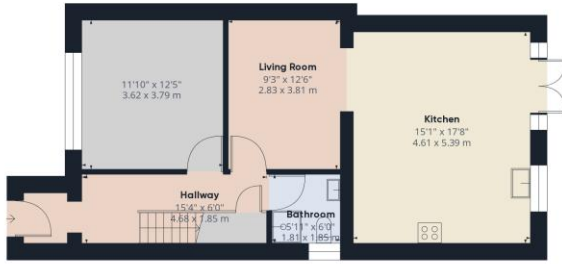

Ground Floor

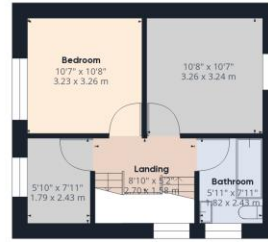

Floor 1



Floor 2

Approximate total area⁽¹⁾
1368.07 ft²
127.1 m²

Reduced headroom
30.93 ft²
2.87 m²

(1) Excluding balconies and terraces

Reduced headroom (below 1.5m/4.92ft)

While every attempt has been made to ensure accuracy, all measurements are approximate, not to scale. This floor plan is for illustrative purposes only.

GIRAFFE360

This floorplan is for illustration purposes only and is not to scale. The position and size of doors, windows, appliances and other features are approximate.

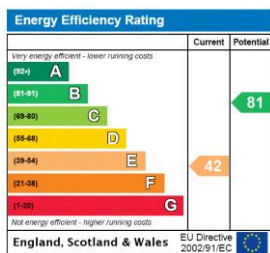

Tenure: Freehold

Council Tax Band: D

Where no figures are shown, we have been unable to ascertain the information. All figures that are shown were correct at the time of printing.

Kingsbury | 020 8204 0000 | kingsbury@winkworth.co.uk

Winkworth

for every step...

winkworth.co.uk

Winkworth wishes to inform prospective buyers and tenants that these particulars are a guide and act as information only. All our details are given in good faith and believed to be correct at the time of printing but they don't form part of an offer or contract. No Winkworth employee has authority to make or give any representation or warranty in relation to this property. All fixtures and fittings, whether fitted or not are deemed removable by the vendor unless stated otherwise and room sizes are measured between internal wall surfaces, including furnishings.