



Perry Vale, SE23

Offers In Excess Of £650,000

Gorgeous period coach house, that has been lovingly refurbished from top to bottom. The property benefits from two double bedrooms, a spacious kitchen/diner ideal for entertaining, a separate formal reception and large private garden.



DESCRIPTION

Gorgeous period coach house, that has been lovingly refurbished from top to bottom. The property consists of two double bedrooms, a spacious kitchen/diner ideal for entertaining and a separate formal reception.

The property has been re-wired, re-plumbed, (with new radiators and boiler), re-plastered, re-insulated and has brand new bespoke double glazed wooden sash windows.

With an abundance of period features retained during the renovation, such as fireplaces and original doors, the property is full of character. The workmanship has been completed to a high specification throughout with no expense spared and the refurbishments are sympathetic to the property's heritage.

The shaker style kitchen has granite work tops, with solid brass handles, fully integrated appliances and is big enough to dine in. Engineered hard wood Oak flooring runs the expanse of the ground floor and the remodelled bathroom benefits from under floor heating. Set back from the road the property is quiet, has a good-sized private garden and with a south facing aspect is flooded with light.

Perry Vale is a short walk to Forest Hill station, and all the amenities that the area has to offer. Close to a selection of fantastic schools and wide array green spaces, including Horniman's Museum and Gardens, Sydenham Hill, and Mayow & Peckham Rye Parks.

With not many houses available in the area for this price point, it would suit a first-time buyer looking for a freehold property or someone looking to downsize who prefers a house.

AT A GLANCE

- Converted Period Coach House
- Refurbished throughout to a high specification
- Two double bedrooms
- Kitchen/diner ideal for entertaining
- Re-wired, re-plumbed, re-insulated
- Bespoke wooden sash windows
- Original period features
- Large private garden
- South facing



LOCATION

Perry Vale is located a few minutes from Forest Hill station with fast and frequent trains, ideal for those looking to commute into central, west or east London.

5 minutes from a large array of café's, restaurants, supermarkets, gastro pubs and delicatessens.

The Horniman's Museum and Gardens with wonderful skyline views of London is close by, as are an array of green open spaces including Peckham Rye Park, Sydenham Hill, Mayow Park and Dulwich Parks.

PERRY VALE, SE23

Approx. Gross Internal Floor Area

650 Sq. ft/60.38 Sq. m

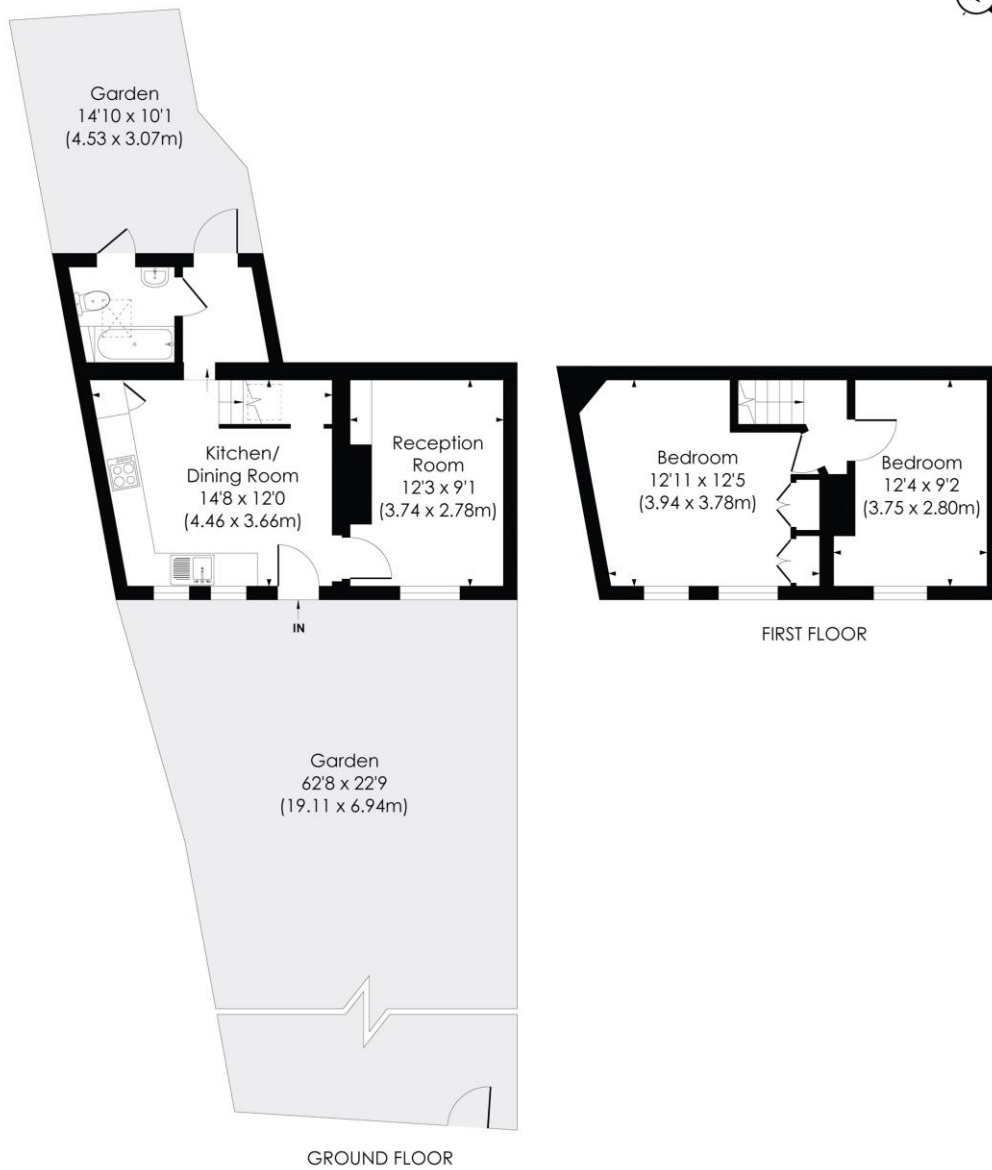
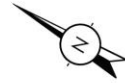

© Pixangle Property Marketing Ltd. info@pixangle.com Tel: 0208 870 2118

pixangle
PROPERTY MARKETING

This floor plan has been prepared for the purpose of illustration only in accordance with the latest RICS code of measuring practice and is not to scale. All measurements and areas are approximate and whilst every effort has been made to ensure the accuracy of the plan contained here, no responsibility is taken for any error, omission or misstatement.

Tenure: Freehold

Borough: Lewisham

NOTICE: Whilst every effort has been made to ensure the accuracy of these sales details, they are for guidance purposes only and prospective purchasers are advised to seek their own professional advice as well as to satisfy themselves by inspection or otherwise as to their correctness. No representation or warranty whatsoever is made in relation to this property by Winkworth or its employees nor do such sales details form part of any offer or contract.