



CAMBALT ROAD, SW15

**£1,800 PER MONTH UNFURNISHED**

**AN INCREDIBLY BRIGHT ONE BEDROOM FLAT IS SITUATED ON THE GROUND FLOOR ON CAMBALT ROAD.**

Putney | 020 8788 9295 | [putney@winkworth.co.uk](mailto:putney@winkworth.co.uk)

**Winkworth**

for every step...

*winkworth.co.uk*



## DESCRIPTION:

This incredibly bright one bedroom flat is situated on the ground floor of a well-maintained building on Cambalt Road, a short walk from the amenities and transport links of East Putney and Putney High Street.

A very generous sized master bedroom with plenty of built-in wardrobes with a smart bathroom adjacent with a bath and shower over.

Whilst the reception room is of a significant size for both living and dining there is also space in the kitchen for an additional table and chairs. The whole property benefits from beautiful views of the gardens and an abundance of natural light.

Cambalt Road is a quiet residential street just off Putney Hill within a short walk of both East Putney Underground (District Line) and Putney Mainline (South Western Railway) as well as the shops, restaurants, cafes and bars the area has to offer.





**Cambalt Road, SW15**  
Approx. Gross Internal Floor Area 627 sq. ft / 58.27 sq. m

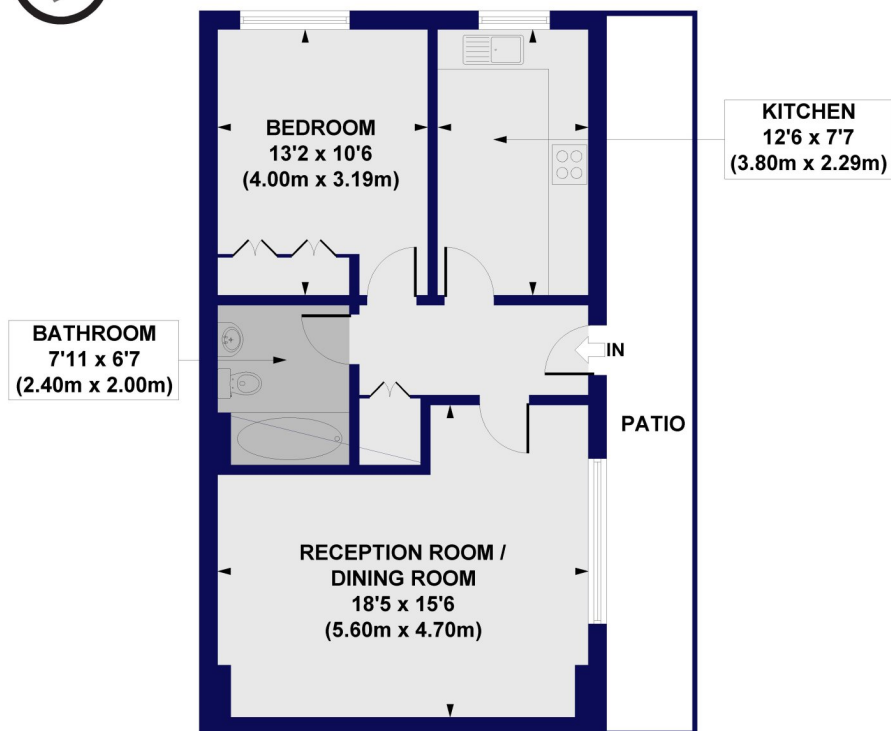

**GROUND FLOOR**

All measurements of walls, doors, windows, fittings and appliances, including their size and location, are shown as standard sizes and do not constitute any warranty or representation by the seller, their agent or CP Creative. Any intending purchaser must satisfy himself by inspection or otherwise as to the correctness of the information contained in these plans. This plan is for illustrative purposes only and should be used as such by any prospective purchasers.

**Winkworth**

This floorplan is for illustration purposes only and is not to scale. The position and size of doors, windows, appliances and other features are approximate.

**Deposit:** 5 weeks rent

**Holding Deposit:** 1 week of rent which gets deducted from deposit

**Council Tax Band:** Wandsworth

Where no figures are shown, we have been unable to ascertain the information. All figures that are shown were correct at the time of printing.

Putney | 020 8788 9295 | [putney@winkworth.co.uk](mailto:putney@winkworth.co.uk)

**Winkworth**

for every step...

[winkworth.co.uk](http://winkworth.co.uk)

Winkworth wishes to inform prospective buyers and tenants that these particulars are a guide and act as information only. All our details are given in good faith and believed to be correct at the time of printing but they don't form part of an offer or contract. No Winkworth employee has authority to make or give any representation or warranty in relation to this property. All fixtures and fittings, whether fitted or not are deemed removable by the vendor unless stated otherwise and room sizes are measured between internal wall surfaces, including furnishings.