



**114 Ringwood Drive, North Baddesley, Hampshire, SO52 9GT**

**Winkworth**





## SEMI-DETACHED BUNGALOW

This semi-detached, two-bedroom bungalow is in a desirable location in the ever-popular North Baddesley and within close proximity of the highly sought after Mountbatten school. North Baddesley offers a selection of local shops, an infant & junior school, both rated good by Ofsted, hairdressers, pubs and green spaces. The property is also within easy reach of Romsey town centre with its variety of shops, banks and restaurants. Access to the M27 motorway is close at hand, which in turn provides access to Bournemouth and the New Forest to the West and Southampton, Eastleigh, Fareham and Portsmouth to the East.

This two-bedroom semi-detached bungalow is in a well-regarded residential area. The accommodation on offer features two bedrooms, a kitchen, sitting room as well as a separate dining room. Both the dining room and sitting room overlook the front elevation. The kitchen is fitted with a wide range of eye and base level units and provides access to the front and rear garden. The bedrooms overlook the rear aspect of the property, both bedrooms benefit from fitted wardrobes. The bathroom to the property is fitted with a walk-in shower.

At the front of the property, there is a well-maintained lawn, alongside a block-paved driveway which leads to the car port. The rear garden is lovely, with the added benefit of backing onto woodland and featuring a gate that offers direct access.

The property is offered with no forward chain.

- Ultrafast Broadband available
- All mains utilities
- Test Valley council tax band 'C' £1,866.49 pa
- No onward chain







# Winkworth

**Address: 114 Ringwood Drive, North Baddesley, Southampton SO52 9GT**

**Council Tax Band: 'C' Test Valley BC  
EPC: 'TBC'  
Tenure: Freehold**



## Ground Floor

Approx. 62.6 sq. metres (673.8 sq. feet)

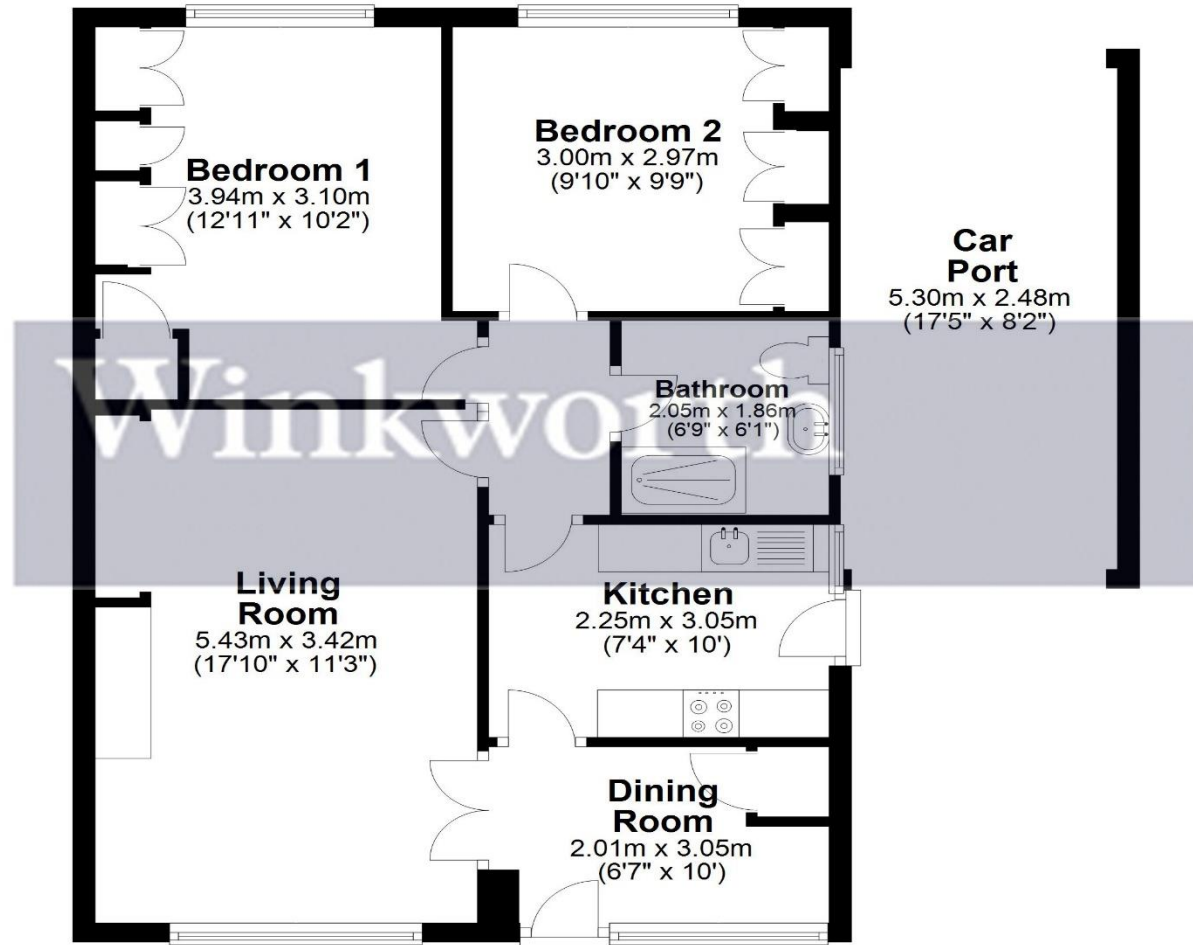

Total area: approx. 62.6 sq. metres (673.8 sq. feet)

[winkworth.co.uk/romsey](http://winkworth.co.uk/romsey)

### Winkworth Romsey

18 Market Place, Romsey, Hampshire, SO51 8NA  
01794 511911 | [romsey@winkworth.co.uk](mailto:romsey@winkworth.co.uk)

[winkworth.co.uk/romsey](http://winkworth.co.uk/romsey)

### Winkworth Winchester

2 Black Swan Buildings, Southgate Street,  
Winchester, Hampshire, SO23 9DT  
01962 866777 | [winchester@winkworth.co.uk](mailto:winchester@winkworth.co.uk)

### Winkworth Mayfair & Country House Department

11 Berkeley Street, Mayfair, London, W1J 8DS  
020 7871 0589 | [countryhouse@winkworth.co.uk](mailto:countryhouse@winkworth.co.uk)

# Winkworth

See things differently