



UNION HOUSE, WOOLWICH, LONDON, SE18
£360,000 LEASEHOLD

A SUPERB AND BRIGHT, TWO BEDROOM, SECOND FLOOR MODERN APARTMENT, THAT MEASURES CIRCA 633 SQ FT, LOCATED JUST MOMENTS FROM THE TOWN CENTRE AND CROSSRAIL! EWS1 COMPLIANT!

Greenwich | 02030533033 | greenwich@winkworth.co.uk

Winkworth

winkworth.co.uk

See things differently



DESCRIPTION:

A superb and bright, two bedroom, second floor modern apartment, that measures circa 633 sq ft, located just moments from the town centre and Crossrail! EWS1 COMPLIANT!

In good condition throughout, the property briefly comprises a large 19ft reception room with open plan kitchen, that has the usual fitted white goods. This room in turn leads onto a small balcony. There are two double bedrooms, both with fitted wardrobes and two well-presented bathrooms. Added features include excellent storage and double glazing.

Union House is part of a wonderful, and newly built, modern development located just next to Woolwich Town Centre, but also sitting just on the cusp of the Royal Arsenal which means it has easy access to the new Crossrail, but also DLR and mainline rail. Your earliest viewing is highly recommended.

AT A GLANCE

- superb apartment
- two double bedrooms
- circa 633 square foot
- second floor
- balcony
- large open plan kitchen/diner
- two bathrooms
- moments from town centre
- very close to Crossrail





Second Floor

Approx. 58.9 sq. metres (633.8 sq. feet)

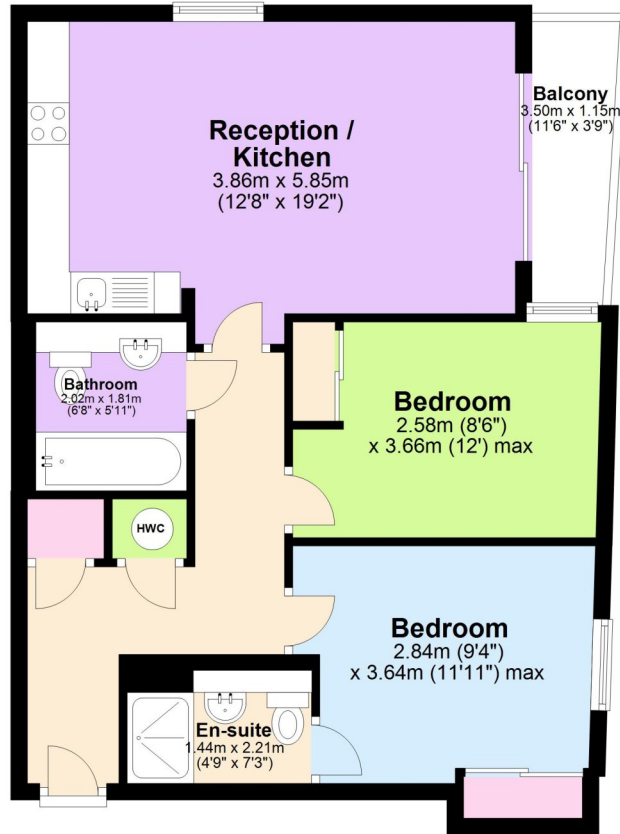

Total area: approx. 58.9 sq. metres (633.8 sq. feet)

This floorplan is for illustration purposes only and is not to scale. The position and size of doors, windows, appliances and other features are approximate.

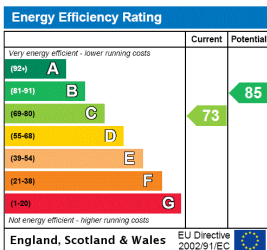

Greenwich | 02030533033 | greenwich@winkworth.co.uk



winkworth.co.uk

See things differently

Winkworth wishes to inform prospective buyers and tenants that these particulars are a guide and act as information only. All our details are given in good faith and believed to be correct at the time of printing but they don't form part of an offer or contract. No Winkworth employee has authority to make or give any representation or warranty in relation to this property. All fixtures and fittings, whether fitted or not are deemed removable by the vendor unless stated otherwise and room sizes are measured between internal wall surfaces, including furnishings.