



TEMPLARS CRESCENT, LONDON, N3  
£1,250,000 FREEHOLD

A WELL PRESENTED, FOUR BEDROOM, SEMI  
DETACHED HOME, SET ON A PRIME  
RESIDENTIAL TURNING.

Finchley | 020 8349 3388 | [finchley@winkworth.co.uk](mailto:finchley@winkworth.co.uk)

**Winkworth**

for every step...

[winkworth.co.uk](http://winkworth.co.uk)





## DESCRIPTION:

Set on a sought-after turning off East End Road, close to local amenities, Finchley Central underground station, good Ofsted rated local schools and recreational parkland, such as Stephens House & Gardens, we are delighted to offer this semi-detached family home. The property comprises of a spacious hallway, two front reception rooms, open plan kitchen / dining area, utility area and downstairs wc to complete the ground floor. To the first floor you have four bedrooms, with access to a balcony from the second bedroom, modern fitted family bathroom and separate wc. Further benefits include off street parking, private rear garden and potential for further expansion STPP.

Offered on a chain free basis, an internal viewing is highly recommended.

## AT A GLANCE

- Set on a prime residential turning
- Semi-detached family home
- Two reception rooms to the front
- Open plan Kitchen / Dining area
- Four bedrooms
- Private rear garden
- Off street parking
- Potential to extend STPP









# Templars Crescent, N3

Approx. Gross Internal Floor Area 1565 sq. ft / 145.38 sq. m

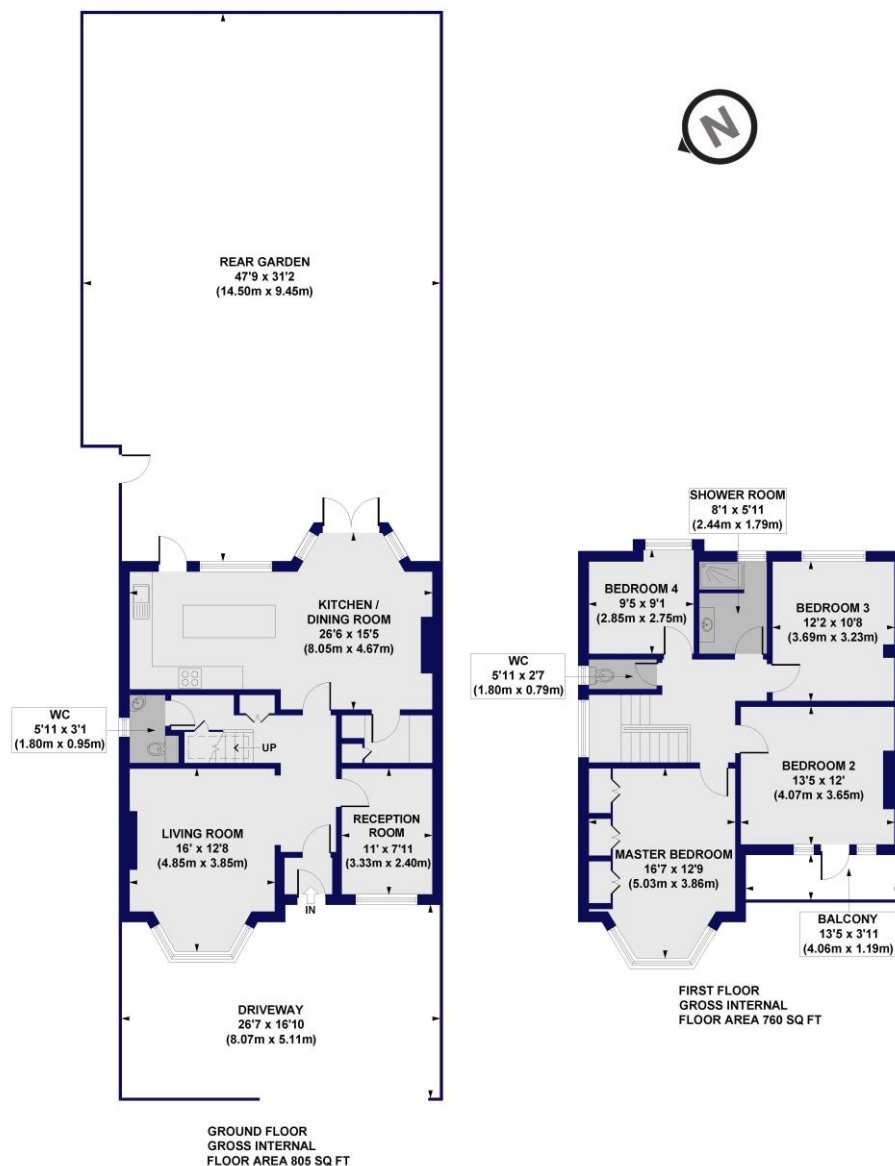

All measurements of walls, doors, windows, fittings and appliances, including their size and location, are shown as standard sizes and do not constitute any warranty or representation by the seller, their agent or CP Creative. Any intending purchaser must satisfy himself by inspection or otherwise as to the correctness of the information contained in these plans. This plan is for illustrative purposes only and should be used as such by any prospective purchasers.

**Winkworth**

This floorplan is for illustration purposes only and is not to scale. The position and size of doors, windows, appliances and other features are approximate.

**Tenure:** Freehold

**Council Tax Band:** G

Where no figures are shown, we have been unable to ascertain the information. All figures that are shown were correct at the time of printing.

Score	Energy rating	Current	Potential
92+	A		
81-91	B		83 B
69-80	C		
55-68	D	62 D	
39-54	E		
21-38	F		
1-20	G		

**Winkworth**

for every step...

Finchley | 020 8349 3388 | finchley@winkworth.co.uk

winkworth.co.uk

Winkworth wishes to inform prospective buyers and tenants that these particulars are a guide and act as information only. All our details are given in good faith and believed to be correct at the time of printing but they don't form part of an offer or contract. No Winkworth employee has authority to make or give any representation or warranty in relation to this property. All fixtures and fittings, whether fitted or not are deemed removable by the vendor unless stated otherwise and room sizes are measured between internal wall surfaces, including furnishings.