

## Willow Vale, Shepherds Bush, W12

£850,000 Freehold

A three bedroom freehold house in this ever popular location in Shepherds Bush.

Double Reception Room | Kitchen | 3 Bedrooms | Bathroom | Garden | 957 Sq Ft / 89 Sq M | Council Tax Band F | EPC Rating Band D

**Winkworth**





### LOCATION

Willow Vale forms part of the ever popular 'Groves' area of Shepherd's Bush. Within easy reach of the area's diverse array of shops and restaurants, there are also several pubs and coffee shops close by. The outside spaces of both Wormholt and Ravenscourt Parks are just a short distance away, whilst superb transport links give easy access both in to and out of Central London. A number of well regarded schools are also close by.

### DESCRIPTION

Well presented throughout, the house offers accommodation which comprises entrance hall, double reception room and kitchen on the ground floor, with the first floor offering three bedrooms and bathroom. The house further benefits from a patio garden and the possibility of extending in to the roof space, subject to the usual necessary consents.







**LOCAL AUTHORITY**  
Hammersmith & Fulham

**TENURE**  
Freehold.

**PRICE:** £850,000 Freehold

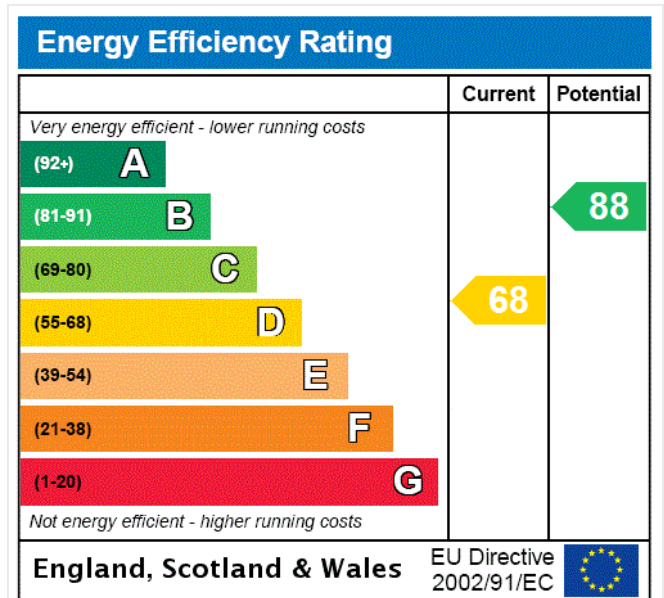

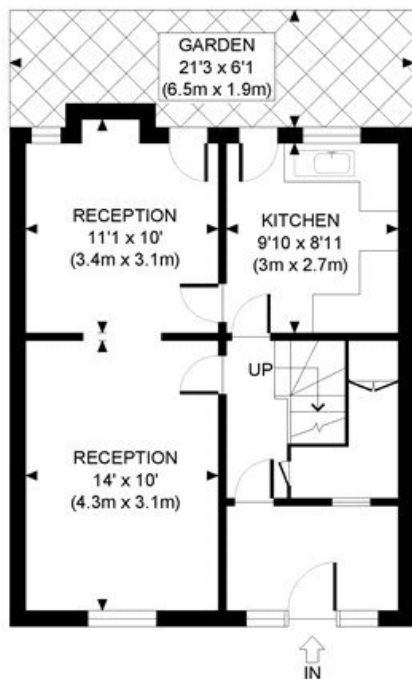

GROUND FLOOR  
GROSS INTERNAL  
FLOOR AREA 473 SQ FT

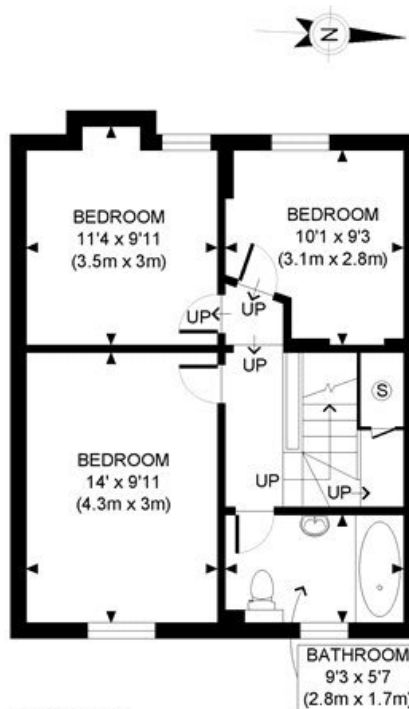

FIRST FLOOR  
GROSS INTERNAL  
FLOOR AREA 484 SQ FT

APPROX. GROSS INTERNAL FLOOR AREA: 957 SQ FT/ 89 SQM

**Winkworth**

This plan is for illustrative purposes only and should be used as such by any prospective client. Whilst every attempt has been made to ensure the accuracy of the Floor Plan contained here, measurements of the doors, windows, rooms and any other items are approximate and no responsibility is taken for any errors, omissions, or misstatement. The services, systems and appliances shown have not been tested and no guarantee as to the operability or efficiency can be given.

**PROPERTY PHOTO PLANS**  
AN ISO 9001:2015 REGISTERED BUSINESS

The displayed square footage is taken from the floor plans with measurements created using the Royal Institute of Chartered Surveyors' Code of Practice for Measuring. These measurements are approximate and included for illustrative purposes only. Winkworth does not make any representation as to the accuracy of these measurements and you should seek to verify them for yourself. Winkworth accept no liability for any loss you may suffer if you rely on these measurements.

Shepherds Bush | 020 8735 3266 | shepherdsbush@winkworth.co.uk

**Winkworth**

for every step...

Under the Property Misdescriptions Act 1991, these Particulars are a guide and act as information only. All details are given in good faith and are believed to be correct at time of printing. Winkworth give no representation as to their accuracy and potential purchasers or tenants must satisfy themselves by inspection or otherwise as to their correctness. No employee of Winkworth has authority to make or give any representation or warranty in relation to this property.