



LORNE COURT, LONDON, SW15
£2,250 PER MONTH FURNISHED

A well-presented, ground floor two double bedroom purpose built property located in a popular residential development in the heart of SW15

Putney | 020 8877 1000 | putney@winkworth.co.uk

Winkworth

for every step...

winkworth.co.uk



DESCRIPTION:

A well-presented, ground floor two double bedroom purpose built property located in a popular residential development within 0.5 miles of Putney Mainline & East Putney Tube stations in the heart of SW15.

This property offers two double bedrooms, two modern bathroom, kitchen and separate living room and additional storage space. Just off the living room there is a private terrace.

Lorne Court benefits from well-maintained communal gardens as well as an onsite caretaker. The building is located on Putney Hill and is within a short walk of Putney Mainline Station and East Putney Underground station. Also close at hand is the green open spaces of Putney Heath.



3 Lorne Court

Approximate Gross Internal Area = 84.2 sq m / 906 sq ft

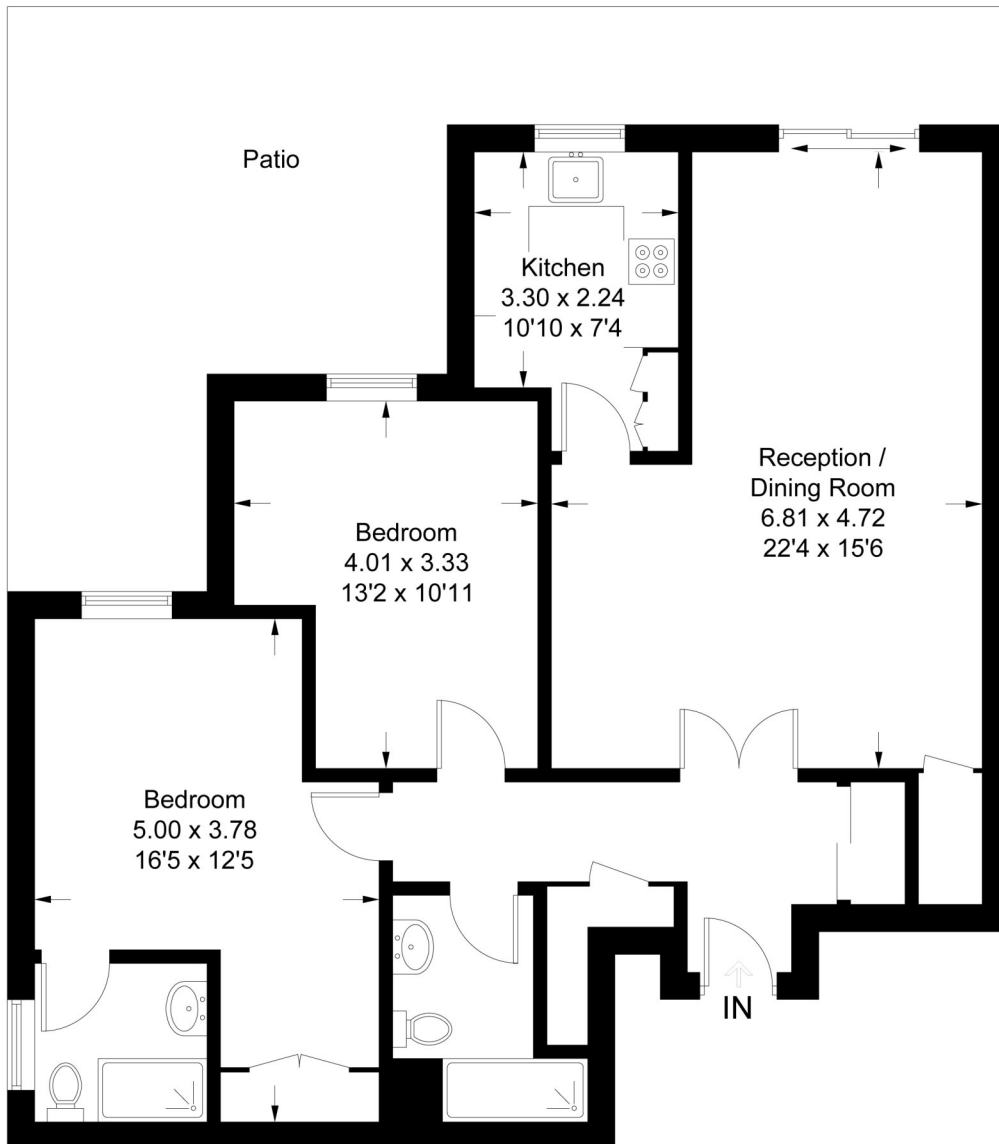

Ground Floor

Illustration for identification purposes only, measurements are approximate, not to scale. FloorplansUsketch.com © 2016 (ID258396)

This floorplan is for illustration purposes only and is not to scale. The position and size of doors, windows, appliances and other features are approximate.

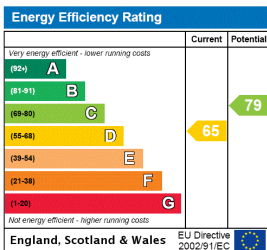

Putney | 020 8877 1000 | putney@winkworth.co.uk



for every step...

winkworth.co.uk

Winkworth wishes to inform prospective buyers and tenants that these particulars are a guide and act as information only. All our details are given in good faith and believed to be correct at the time of printing but they don't form part of an offer or contract. No Winkworth employee has authority to make or give any representation or warranty in relation to this property. All fixtures and fittings, whether fitted or not are deemed removable by the vendor unless stated otherwise and room sizes are measured between internal wall surfaces, including furnishings.