



NORFOLK HOUSE, DEPTFORD, LONDON, SE8
£350,000 LEASEHOLD

AN EXTREMELY WELL PRESENTED ONE BEDROOM FIRST FLOOR MODERN APARTMENT THAT FEATURING A LARGE 19FT BALCONY AND MEASURES CIRCA 484 SQ FT. LOCATED JUST MOMENTS FROM DLR.

Greenwich | 02030533033 | greenwich@winkworth.co.uk

Winkworth

for every step...

winkworth.co.uk



DESCRIPTION:

An extremely well presented one bedroom first floor modern apartment that featuring a large 19ft balcony and measures circa 484 sq ft. Located just moments from DLR.

In excellent condition the property briefly comprises of a bright 15ft reception room that leads onto the balcony. There is a well fitted modern kitchen and a lovely bathroom. The double bedroom is a good size and has fitted wardrobes. benefits include decent storage off the entrance hallway, video entry and a concierge service on site.

The development is located just off Brookmill Road and is literally moments from Deptford Bridge DLR along with Greenwich town centre with all its amenities, including mainline rail, shops, riverboat service and Royal Park.

AT A GLANCE

- One bedroom flat
- excellent condition
- Large Balcony
- first floor
- no chain
- moments from DLR
- well fitted kitchen
- close to town centre





First Floor

Approx. 45.0 sq. metres (484.1 sq. feet)

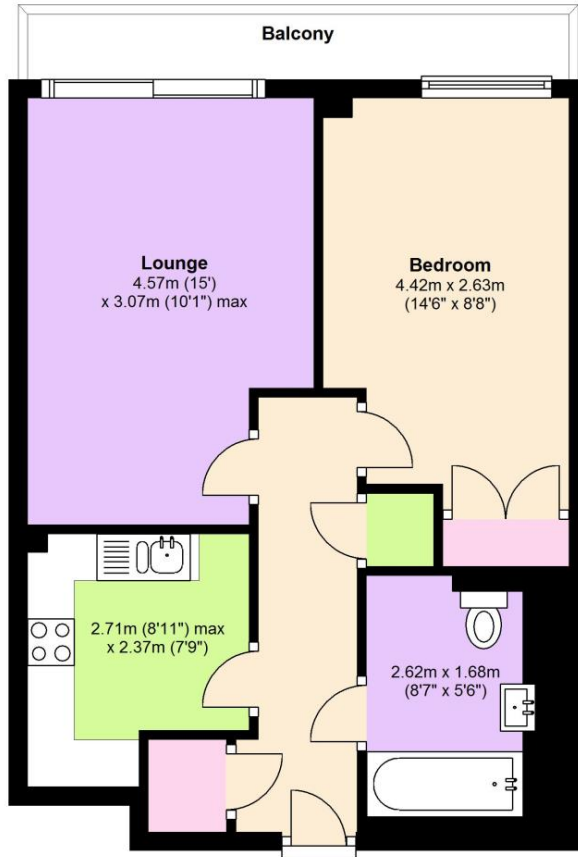

Total area: approx. 45.0 sq. metres (484.1 sq. feet)

This floorplan is for illustration purposes only and is not to scale. The position and size of doors, windows, appliances and other features are approximate.

Energy Efficiency Rating		Current	Potential
Very energy efficient - lower running costs			
(92-100) A			
(81-91) B			
(69-80) C			
(55-68) D			
(39-54) E			
(21-38) F			
(1-20) G			
Not energy efficient - higher running costs			
England, Scotland & Wales		83	83
EU Directive 2002/91/EC			

Environmental Impact (CO ₂) Rating		Current	Potential
Very environmentally friendly - lower CO ₂ emissions			
(92-100) A			
(81-91) B			
(69-80) C			
(55-68) D			
(39-54) E			
(21-38) F			
(1-20) G			
Not environmentally friendly - higher CO ₂ emissions			
England, Scotland & Wales		93	93
EU Directive 2002/91/EC			

Tenure: Leasehold

Term: 113 years

Service Charge: £1968 per annum

Ground Rent: tbc

Council Tax Band: tbc

Where no figures are shown, we have been unable to ascertain the information. All figures that are shown were correct at the time of printing.

Greenwich | 02030533033 | greenwich@winkworth.co.uk

Winkworth

for every step...

winkworth.co.uk

Winkworth wishes to inform prospective buyers and tenants that these particulars are a guide and act as information only. All our details are given in good faith and believed to be correct at the time of printing but they don't form part of an offer or contract. No Winkworth employee has authority to make or give any representation or warranty in relation to this property. All fixtures and fittings, whether fitted or not are deemed removable by the vendor unless stated otherwise and room sizes are measured between internal wall surfaces, including furnishings.