



NELL GWYNN CLOSE, RADLETT, HERTFORDSHIRE, WD7
£260,000 LEASEHOLD

ONE BEDROOM SECOND FLOOR APARTMENT IN SHENLEY

Borehamwood | 020 8953 8899 | borehamwood@winkworth.co.uk



DESCRIPTION:

One bedroom apartment set in a quiet and convenient location in Shenley. This apartment offers over 500 square feet of accommodation as well as additional large boarded loft space. Benefitting from an open-plan reception/diner to fitted kitchen, master bedroom, tiled bathroom and allocated residents parking making it an ideal purchase for both first time buyers and investors alike.

With easy access to local amenities and bus links the property offers both convenience and comfort, contact Winkworth today to arrange a viewing.

AT A GLANCE

- 1 Bedroom
- 529 Square Feet
- Open Plan Kitchen Dining Room
- Allocated Parking Bay
- 165 Year Lease
- Boarded Loft Storage Space



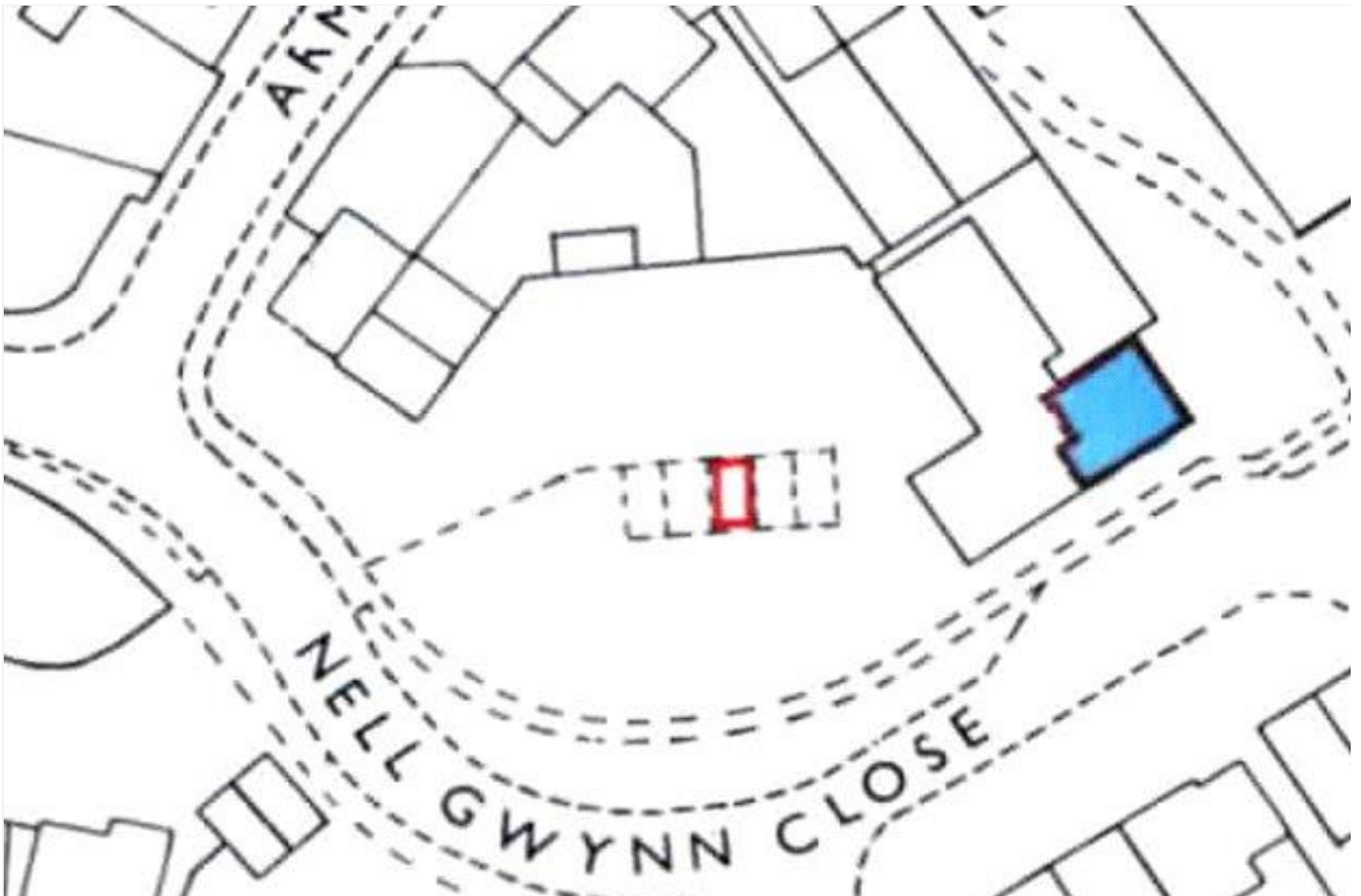

Approximate Gross Internal Area = 49.2 sq m / 529 sq ft
 External Storage = 1.1 sq m / 12 sq ft
 Total = 50.3 sq m / 541 sq ft

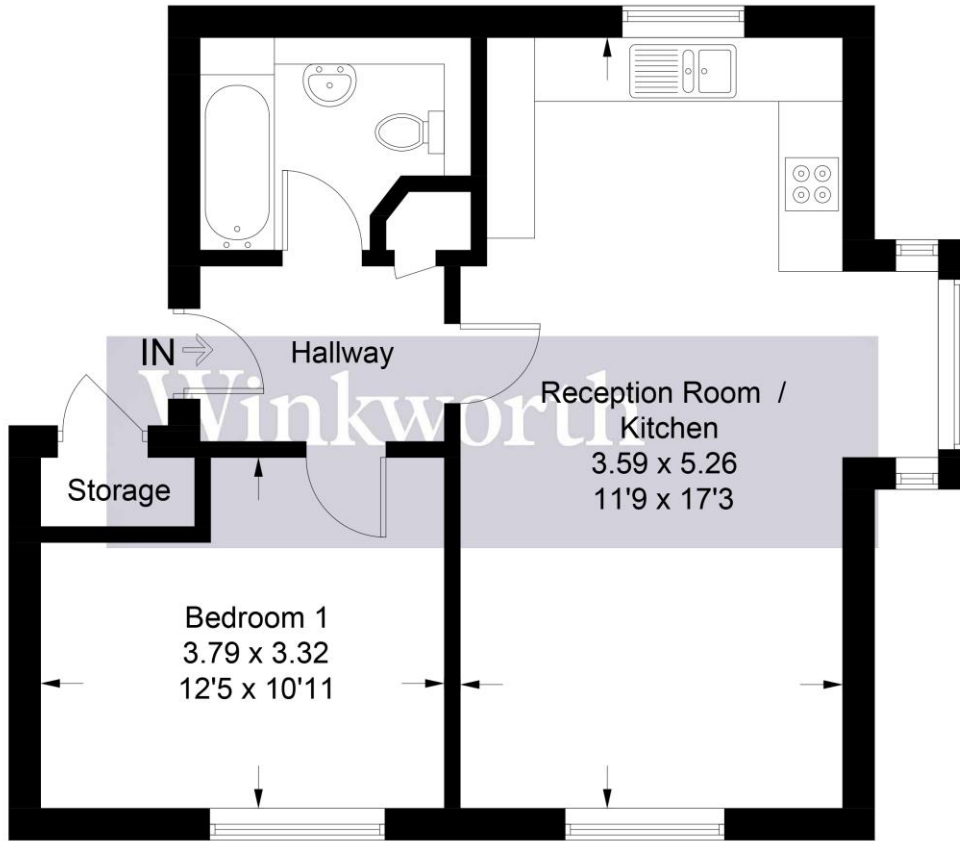

Illustration for identification purposes only, measurements are approximate, not to scale. Winkworth © 2025 (ID1180344)

This floorplan is for illustration purposes only and is not to scale. The position and size of doors, windows, appliances and other features are approximate.

Energy Efficiency Rating		Current	Potential
Very energy efficient - lower running costs			
(92-100)	A		
(81-91)	B		
(69-80)	C	69	69
(55-68)	D		
(39-54)	E		
(21-38)	F		
(1-20)	G		
Not energy efficient - higher running costs			
England, Scotland & Wales		EU Directive 2002/91/EC	

Tenure: Leasehold

Term: 165 year and 0 months

Service Charge: £900 per annum

Ground Rent: £ 50 Annually (subject to increase)

Council Tax Band: C

Where no figures are shown, we have been unable to ascertain the information. All figures that are shown were correct at the time of printing.