



FLAT 4
640 CHRISTCHURCH
ROAD
BOURNEMOUTH
BH1 4BP

LEASEHOLD
ASKING PRICE
£150,000

“A two double
bedroom flat situated
in the heart of
Boscombe, ideal for
a first time
buyer or air b&b
investment”

Winkworth

for every step...

ASKING PRICE £150,000

Two Double Bedrooms
Town Centre Location
Ideal First Time Buyer
Air B&B Permitted
Less Than A Mile To Boscombe Beach

EPC: TBC | COUNCIL TAX: TBC | SHARE OF FREEHOLD
107 YEARS REMAINING | MAINTENANCE £587.50 P/A |
GROUND RENT N/A | HOLIDAY LETS PERMITTED
01202 434365
southbourne@winkworth.co.uk

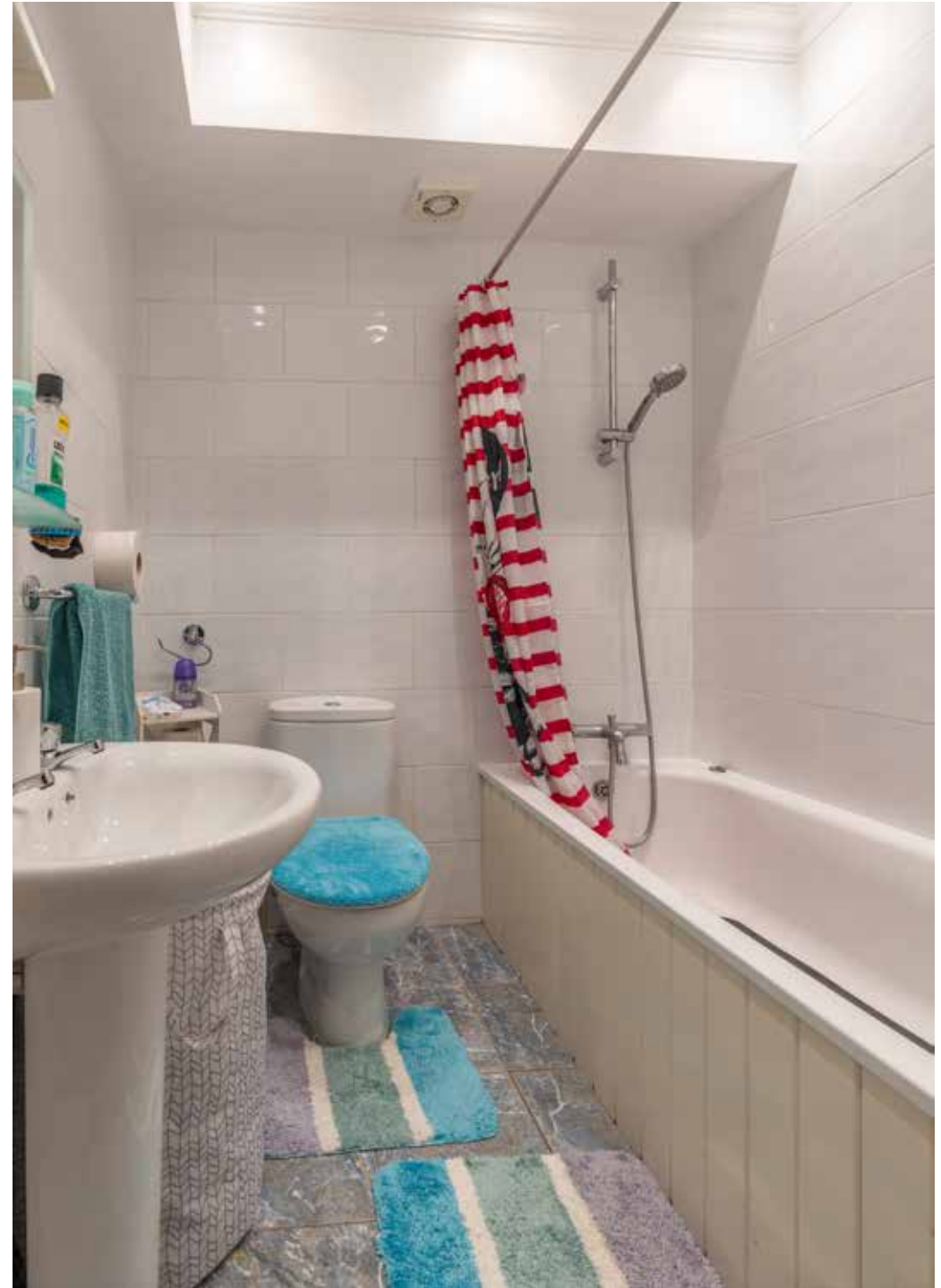

548 sq.ft. (50.9 sq.m.) approx.

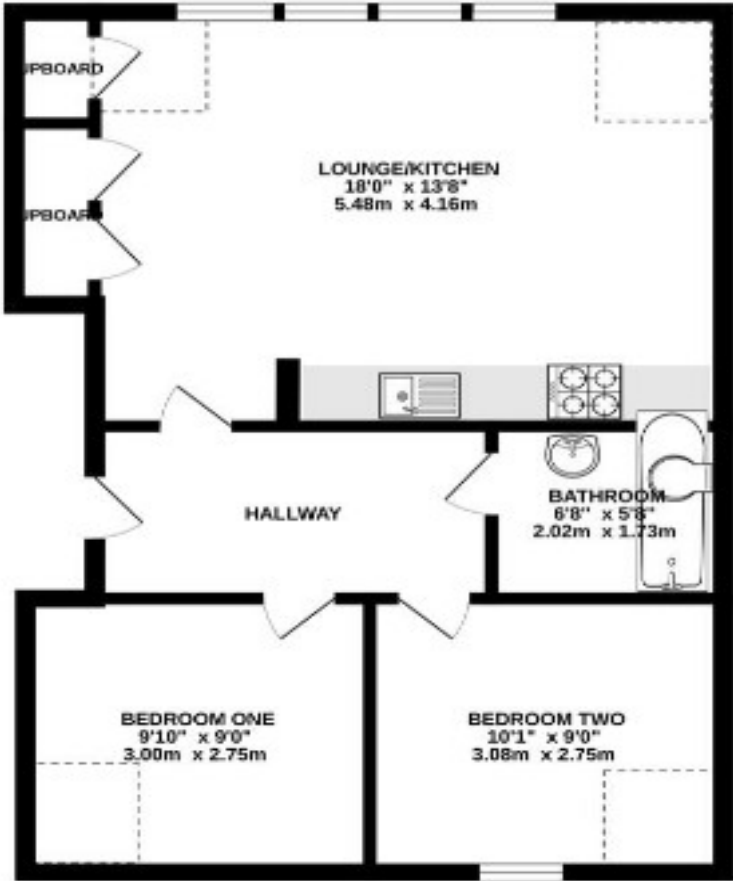

TOTAL FLOOR AREA: 548 sq.ft. (50.9 sq.m.) approx.

While every attempt has been made to ensure the accuracy of the floorplan contained here, measurements of walls, windows, doors and any other items are approximate and it is the responsibility of the buyer for any error, omission or mis-statement. This plan is for illustrative purposes only and should be used as such by any prospective purchaser. The services, systems and appliances shown have not been tested and no guarantee is given as to their operability at the time of issue for given.
Masterplan Services 03/2024

DISCLAIMER:
Winkworth wishes to inform prospective buyers that these particulars are a guide and act as information only. All our details are given in good faith and believed to be correct at the time of issue but they do not form part of an offer or contract. No Winkworth employee has authority to make or give any representation or warranty in relation to this property. All fixtures and fittings, whether fitted or not are deemed removable by the vendor unless stated otherwise and room sizes are measured between internal wall surfaces, including furnishings.



Lori Leon

lleon@winkworth.co.uk
07918 932490
Winkworth Southbourne
29 Southbourne Grove,
Bournemouth, Dorset, BH6
3QT

01202 434365
southbourne@winkworth.co.uk
winkworth.co.uk/southbourne

“Before embarking on her career in agency, Lori was a golf professional for many years following a successful amateur career playing at both county and international level. She started in agency in 2004 and has always worked in Bournemouth and the surrounding areas.

While working at her previous agency, she met James where they forged a firm friendship. Their passion to change the way people perceive estate agents, led them to joining forces and purchasing the Winkworth Southbourne franchise together. Lori has always lived in Southbourne and is very passionate about the area. Her children Zak and Kitty attended the local St James primary school. Both her children are now adults so in her spare time she enjoys travelling and big family get togethers when her youngest is home from university.”

Winkworth

for every step...