



FRIESIAN HOUSE, BUCKHURST STREET, LONDON, E2  
'OFFERS IN EXCESS OF' £425,000 LEASEHOLD

## A STUNNING FIFTH FLOOR ONE BEDROOM APARTMENT WITH PRIVATE BALCONY

Shoreditch | 020 7749 7650 | shoreditch@winkworth.co.uk

**Winkworth**

*winkworth.co.uk*

See things differently



## DESCRIPTION:

**\*EWS1 COMPLIANT\*** A magnificent one bedroom, apartment positioned on the 5th floor of this popular modern block in E2. Standing over 560sqft, the property has been tastefully decorated and features floor to ceiling windows flooding the property with natural light. The well-proportioned living room opens out onto a private west-facing balcony. The master bedroom features west-facing windows and includes built in storage, while the property is completed with a modern Jack and Jill style family bathroom and plenty of storage space. Friesian House is well insulated, and very energy efficient with a B rated EPC. The development also benefits from a communal roof terrace offering amazing panoramic views of the city skyline and Canary Wharf.

The property is in an ideal location with an array of local amenities on Bethnal Green Road as well the boutique shops, cafes, bars and restaurants on Brick Lane, Spitalfields Market, Redchurch Street and Shoreditch High Street. You have fantastic transport links with Bethnal Green and Shoreditch High Street overground stations as well as Bethnal Green, Whitechapel (Crossrail), Liverpool Street, Aldgate and Aldgate East underground stations all close by.

**Winkworth**





**Winkworth**

Friesian House, Buckhurst Street, E2  
 Approx. Gross Internal Floor Area 566 sq. ft / 52.62 sq. m

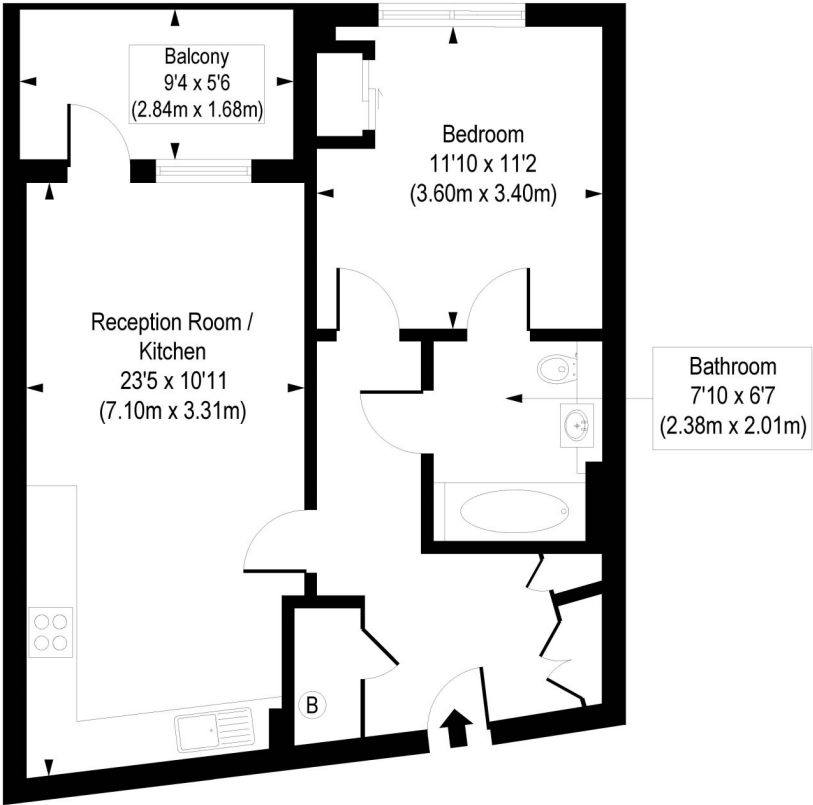

Fifth Floor

COMPLIANT WITH RICS CODE OF MEASURING PRACTICE. Floorplan is for illustrative purposes only and is not to scale. Every attempt has been made to ensure the accuracy of the floorplan shown, however all measurements, fixtures, fittings and data shown are an approximate interpretation for illustrative purposes only. Liability for errors, omissions or mis-statement through negligence or otherwise is hereby excluded.

This floorplan is for illustration purposes only and is not to scale. The position and size of doors, windows, appliances and other features are approximate.

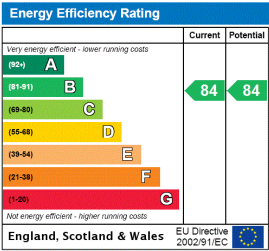

Shoreditch | 020 7749 7650 | shoreditch@winkworth.co.uk



winkworth.co.uk

See things differently

Winkworth wishes to inform prospective buyers and tenants that these particulars are a guide and act as information only. All our details are given in good faith and believed to be correct at the time of printing but they don't form part of an offer or contract. No Winkworth employee has authority to make or give any representation or warranty in relation to this property. All fixtures and fittings, whether fitted or not are deemed removable by the vendor unless stated otherwise and room sizes are measured between internal wall surfaces, including furnishings.