



WOODSIDE COURT, THE COMMON, LONDON, W5 £475,000 SHARE OF FREEHOLD

Share of Freehold: 999 Years from 1959 (Approx. 934 Years Remaining)
Ground rent: £N/A Per Annum
Service Charge: £1628 Per Annum
(Information Supplied by vendor)

EPC: D
Council Tax Band: D

Ealing & Acton | 0208 896 0123 | ealing@winkworth.co.uk

Winkworth

for every step...

winkworth.co.uk



DESCRIPTION:

Presenting a fantastic opportunity to acquire a share of freehold in this well-proportioned two-bedroom ground floor flat, situated in a purpose-built block. The property offers a comfortable living experience with a separate kitchen and a spacious reception room, perfect for both relaxation and entertaining. The flat features two generously sized bedrooms, providing ample space for both comfort and practicality. The bathroom is well-appointed and functional, ensuring convenience for everyday living.

While the flat is presented in moderate condition, it offers a solid foundation for those looking to personalise and modernise to their own taste. An added bonus is the inclusion of a private garage, and an off street parking space. Located in a well-maintained block, this property is an excellent choice for first-time buyers, investors, or those seeking a convenient and accessible home.



Winkworth

for every step...



Winkworth

for every step...

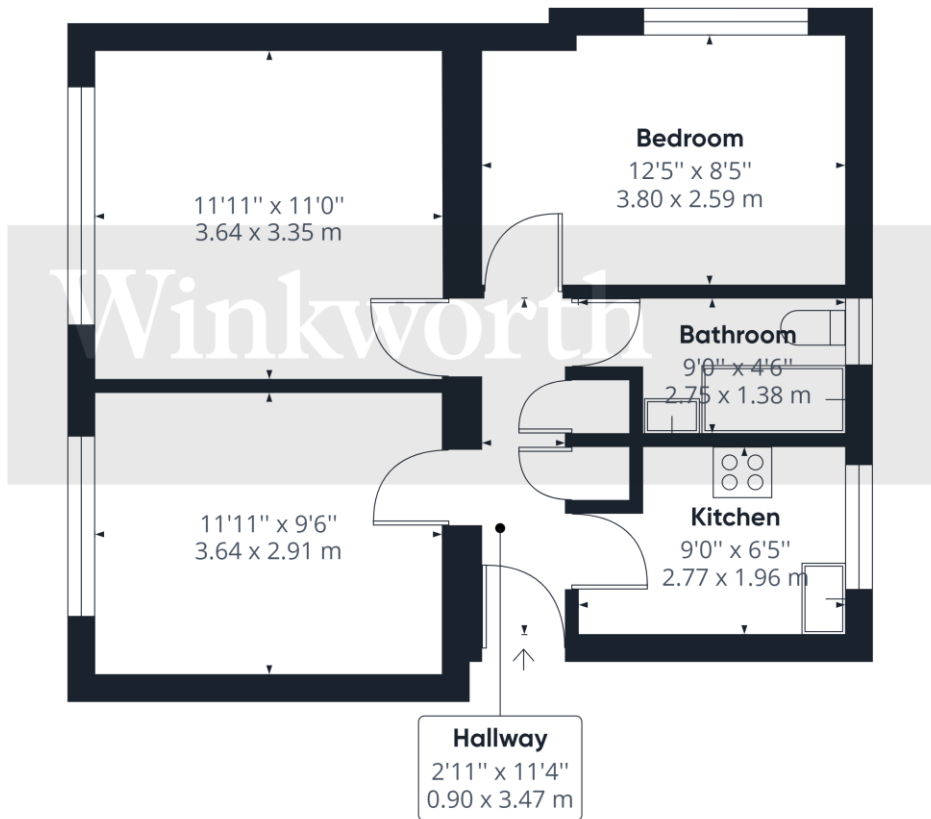

Approximate total area⁽¹⁾
503.29 ft²
46.76 m²

(1) Excluding balconies and terraces

While every attempt has been made to ensure accuracy, all measurements are approximate, not to scale. This floor plan is for illustrative purposes only.
GIRAFFE 360

This floorplan is for illustration purposes only and is not to scale. The position and size of doors, windows, appliances and other features are approximate.

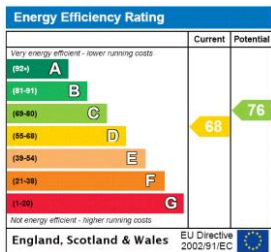

Tenure: Share of Freehold
Term: 934 year and 3 months
Service Charge: £1628 per annum (subject to increase)
Ground Rent: £N/A per annum (subject to increase)
Council Tax Band: D
 Where no figures are shown, we have been unable to ascertain the information. All figures that are shown were correct at the time of printing.

Ealing & Acton | 0208 896 0123 | ealing@winkworth.co.uk



for every step...

winkworth.co.uk

Winkworth wishes to inform prospective buyers and tenants that these particulars are a guide and act as information only. All our details are given in good faith and believed to be correct at the time of printing but they don't form part of an offer or contract. No Winkworth employee has authority to make or give any representation or warranty in relation to this property. All fixtures and fittings, whether fitted or not are deemed removable by the vendor unless stated otherwise and room sizes are measured between internal wall surfaces, including furnishings.